

33-17-A

TOWNSHIP No. 33 NORTH, RANGE No. 17 EAST, WILLAMETTE MERIDIAN, WASHINGTON.

G f F e E d D c C b B a A

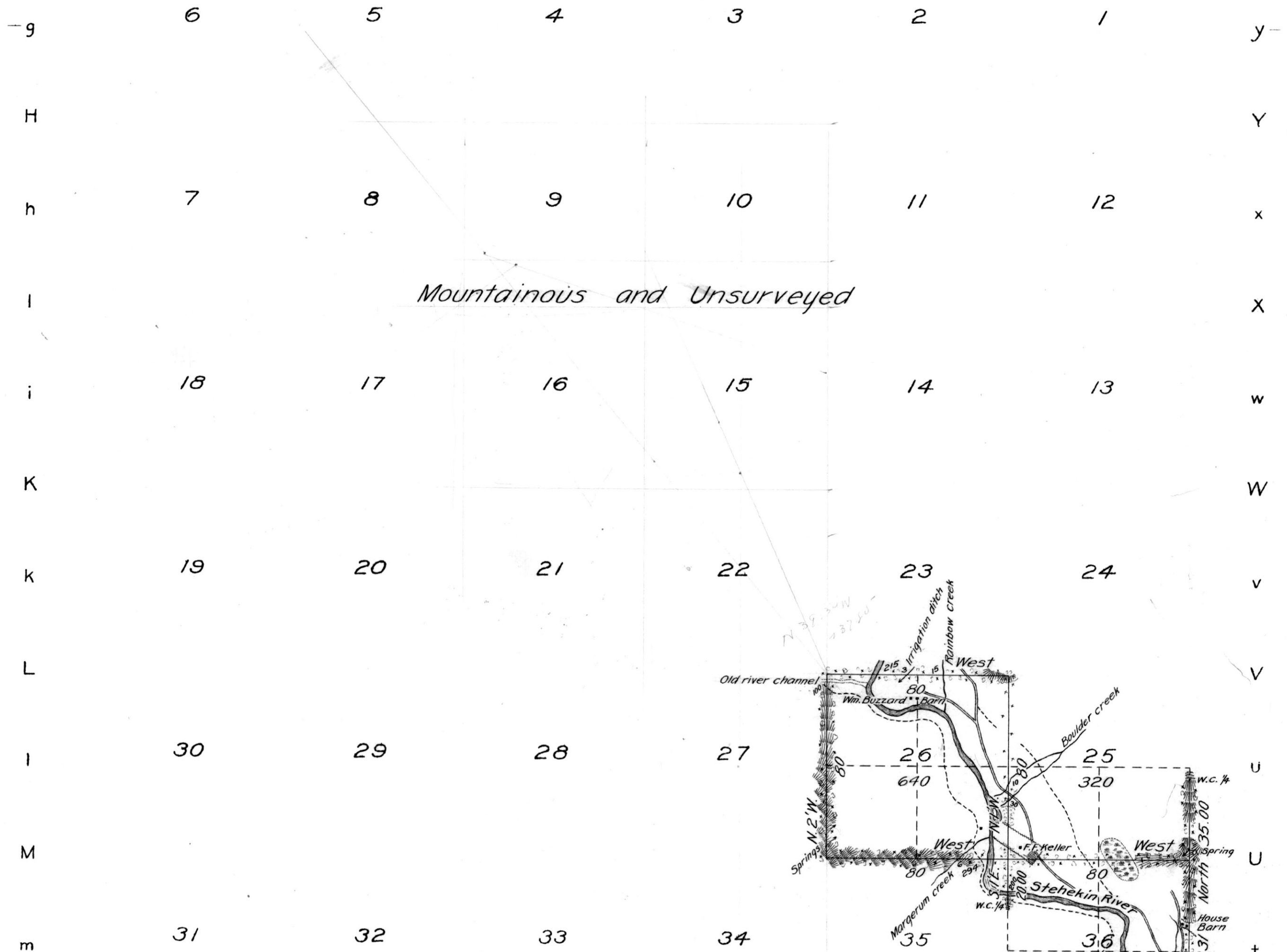

Accepted by Commissioner's Letter "E" dated August 31, 1903

Area in Acres	
Public Land	1420.55
Indian Reservation	
Indian Allotments	
Mineral Claims	
Water Surface	
Total Area	1420.55

Scale: 40 Chains to an inch

Mean Mag. Decl. 23° 35' E.

E.B.G.

Surveys Designated	By Whom Surveyed	Contract		Amount of Surveys			When Surveyed	
		No.	Date	Ms.	Chs.	Lks.	Began	Completed
Subdivisions	Irving Worthington	590	March 25, 1902	5	20	00	Sept. 24, 1902	Sept. 27, 1902
Meanders	"		and Supplemental Sp. Ins. dated Sept. 1, 1902		33	13		
Eighth Std. Par. North	"	590	March 25, 1902				Sept. 25, 1902	Sept. 25, 1902
East Boundary	"						Sept. 8, 1902	Sept. 8, 1902

The above map of Township No. 33 North, of Range No. 17 East of the Willamette Meridian, Washington, is strictly conformable to the field notes of the survey thereof on file in this Office which have been examined and approved.  
Surveyor General's Office  
Olympia, Washington  
May 29, 1903

E. Kingbury  
Surveyor General, Washington

THE SUBMITTER OF THIS MAP IS NOT RESPONSIBLE FOR THE ACCURACY OF THE DATA.