



IN REPLY REFER TO:
L7615(YOSE-PM)

United States Department of the Interior NATIONAL PARK SERVICE

Yosemite National Park
P. O. Box 577
Yosemite, California 95389

Memorandum

To: William Bryan, Project Manager, Yosemite National Park

From: Superintendent, Yosemite National Park

Subject: NEPA and NHPA Clearance: 2011-035 Curry Village Geologic Hazard Canvas Tent Relocation (37796)

The Executive Leadership Team has reviewed the proposed project/action and completed its environmental assessment documentation, and we have determined that there:

- Will not be any effect on threatened, endangered, or rare species and/or their critical habitat.
- Will not be any effect on historical, cultural, or archeological resources.
- Will not be serious or long-term undesirable environmental or visual effects.

The subject proposed project, therefore, is now cleared for all NEPA and NHPA compliance requirements as presented above. Project plans and specifications are approved and construction and/or project implementation can commence.

For the proposed project actions to be within compliance requirements during construction and/or project implementation, the following mitigations must be adhered to:

- No mitigations identified.

For complete compliance information see PEPC Project 37796.

//Don L. Neubacher//
Don L. Neubacher

Enclosure (with attachments)

cc: Statutory Compliance File

*The signed original of this document is on file at the
Environmental Planning and Compliance Office in
Yosemite National Park.*



National Park Service
U.S. Department of the Interior

Yosemite National Park
Date: 07/11/2012

Categorical Exclusion Form

Project: 2011-035 Curry Village Geologic Hazard Canvas Tent Relocation

PEPC Project Number: 37796

Project Description:

This project will relocate or replace thirty-eight visitor accommodations within Curry Village as an interim response to a National Park Service (NPS), Yosemite memorandum dated June 13, 2012 titled "Action Implementation Schedule for Geologic Hazard Assessment in Yosemite" signed by the park Superintendent. This memorandum identified structures within Curry Village whose existing locations exceed acceptable risk levels and therefore must be removed. This project is interim to the finalization of the Merced River Plan Environmental Impact Statement and Record of Decision.

Twenty-seven canvas tents have been identified as exceeding acceptable risk levels and therefore have been scheduled for removal or relocation. These existing units are #10, 11, 12, 13, 14, 15, 16, 17, 19, 20, 21, 22, 23, 24, 25, 26, 27, 28, 29, 32, 33, 472, 473, 474, 475, 476, and 477. The concessioner, DNC Parks and Resorts at Yosemite, Inc. (DNC) has requested that unit #18 be included in the tent relocation to prevent this unit from being isolated. The total number of canvas tents for relocation is twenty-eight.

Ten (10) Cabins with Bath units (5 buildings) have also been identified as exceeding acceptable risk levels and therefore have been scheduled for removal from occupancy. This project does not plan for the removal of the cabin structures. These existing units are #25A, 25B, 26A, 26B, 27A, 27B, 28A, 28B, 29A, and 29B. DNC has requested these units be replaced with ten canvas tent units.

Proposed areas are as follows: Curry Village East - six unheated canvas tents will be relocated to the east end of the Curry Village developed area near the 700 series tents. In order to meet electrical code, these units will require the installation of three new electrical poles. This area is also referred to as the "Blackberry area".

Old Boystown - Nine canvas tents will be relocated to infill positions within existing "Old Boystown". These units will be heated to be consistent with adjacent accommodations. Additional propane and electrical services are not required as this area already has sufficient service.

New Boystown - Twenty-three canvas tents will be relocated or constructed in the "New Boystown" area which was first developed in 2009. These units will be heated to be consistent with adjacent accommodations. Existing propane farm will adequately support these new units therefore no new propane service additions are required. In order to meet electrical code, these units will require the installation of six new electrical poles.

Tent cabins are constructed on post and piers which may require minor surface grading to obtain a level foundation. The installation of up to nine electrical poles will require a four foot hole which will be dug

by a mechanical post-hole digger. Propane will be installed 18 inches below grade per code and will be hand dug by a ditch-witch. All equipment will be washed and inspected by park staff prior to entry to the park. All ground disturbance will occur in developed areas.

Proposed relocation sites will have a minimal effect on vegetation. Some tree limbing and brush clearing will be required. Non-native, invasive blackberry in "Old Boystown" area will be removed by acceptable means. Large trees and oaks will be avoided for clearing or limbing. All limb work will be at the direction of the park forester.

Relocating tents to East Curry Village and Old Boystown will occur first as the construction of tent cabins in New Boystown will take longer. DNC plans to open all 38 units to the public by October 1, 2012. At no point will more than 503 guest unit accommodations in Curry Village be available for sale to the public.

Park GIS layering and 911 Database will be informed to provide up to date information for emergency response. Maps presented to these branches will not be survey quality but will provide best available spatial information for inclusion.

Special Considerations:

Ground Disturbance – Tent cabins are constructed on post and piers which may require minor surface grading to obtain a level foundation. The installation of up to nine (9) electrical poles will require a 4 foot hole which will be dug by a mechanical post holer. Propane will be installed 18 inches below grade per code and will be hand-dug by a ditch-witch. To achieve proper slope for an accessible path-of-travel to seven (7) tents in New Boystown, existing ground will need to be graded up to 12 inches, entirely in fill. All equipment will be washed and inspected by NPS prior to entry to the Park. All ground disturbance and grading will occur in developed areas, most of which were recently disturbed by the construction of the NPS utility corridor through the Boystown area.

Vegetation – Proposed relocation sites will have a minimal affect on vegetation. Some tree limbing and brush clearing will be required. Virginia Creeper and invasive blackberry in eastern Curry Village will be removed by acceptable means. Large trees and Oaks will be avoided for clearing or limbing. All limb work will be at the direction of the NPS forester.

Fencing – To delineate guest areas from employee areas and to reduce visual impacts of this proposal, approximately 325 lineal feet of new privacy fencing is proposed. All new fencing will be 6ft grape-stake fencing which is the standard used throughout Yosemite Valley. An approximate 180 foot stretch of fence will run along the eastern edge of the Curry Village parking area and apple orchard access drive. This run will be broken and staggered half way along the run to allow for wildlife passage and a four inch gap will remain at the bottom of the fence for small animals. This segment of fence is proposed to protect guests staying in the tents along the parking area from headlight glare, Two segments of fence will be constructed at the west end of the employee tents in New Boystown. One segment of fence will be constructed at the east end of Boystown to provide privacy for guests from the campground road and bike paths in this area.

Access – Fire truck access will be maintained at each site. Tents will have a ten foot clearance from each other. Vehicular access to the utility ports in New Boystown will also be maintained.

Accessibility – This project will replace the seven ADA tent units lost in the closure, convert four existing tents in Boystown to be ADA, and add three more ADA tents for a total of fourteen ADA tents

constructed with this project. Six ADA tents remain in Curry Village so at the end of this project, there will be twenty ADA tent cabins at Curry Village which meets the total required.

Schedule – Upon NPS approval, DNC will mobilize and construct tent cabins as soon as possible. Relocating tents to East Curry Village and Old Boystown will occur first as the construction of tent cabins in New Boystown will take longer. DNC plans to open all 38 units to the public by October 1, 2012. Tents in the Rock Fall Hazard Zone will be demoded by October 1, 2012 as well. NPS will address the final disposition of the 5 hard-sided structures that have recently been closed.

Project Locations:

Mariposa County, CA

Mitigations:

- No mitigations identified.

Describe the category used to exclude action from further NEPA analysis and indicate the number of the category (see Section 3-4 of DO-12):

C.19 Construction or rehabilitation in previously disturbed or developed areas, required to meet health or safety regulations, or to meet requirements for making facilities accessible to the handicapped.

On the basis of the environmental impact information in the statutory compliance file, with which I am familiar, I am categorically excluding the described project from further NEPA analysis. No exceptional circumstances (e.g. all boxes in the ESF are marked "no") or conditions in Section 3-6 apply, and the action is fully described in Section 3-4 of DO-12.

Superintendent //Don L. Neubacher//

Date 7/18/12

*The signed original of this document is on file at the
Environmental Planning and Compliance Office in
Yosemite National Park.*



National Park Service
U.S. Department of the Interior

Yosemite National Park
Date: 07/11/2012

ENVIRONMENTAL SCREENING FORM (ESF)

DO-12 APPENDIX 1

Date Form Initiated: 12/13/2011

Updated May 2007 - per 2004 Departmental Manual revisions and proposed Director's Order 12 changes

A. PROJECT INFORMATION

Park Name: Yosemite National Park
Project Title: 2011-035 Curry Village Geologic Hazard Canvas Tent Relocation
PEPC Project Number: 37796
Project Type: Tent Relocation (OTHER)
Project Location:
County, State: Mariposa, California
Project Leader: William Bryan

Is project a hot topic (controversial or sensitive issues that should be brought to attention of Regional Director)? No

B. RESOURCE EFFECTS TO CONSIDER:

Identify potential effects to the following physical, natural, or cultural resources	No Effect	Negligible Effects	Minor Effects	Exceeds Minor Effects	Data Needed to Determine/Notes
1. Geologic resources – soils, bedrock, streambeds, etc.		Negligible			Pier blocks will need to be placed for each tent cabin; up to six inches of soil will be disrupted for leveling purposes.
2. From geohazards	No				
3. Air quality	No				
4. Soundscapes		Negligible			Temporary noises are associated with the tent cabin relocation.

Identify potential effects to the following physical, natural, or cultural resources	No Effect	Negligible Effects	Minor Effects	Exceeds Minor Effects	Data Needed to Determine/Notes
5. Water quality or quantity	No				
6. Streamflow characteristics	No				
7. Marine or estuarine resources	No				
8. Floodplains or wetlands	No				
9. Land use, including occupancy, income, values, ownership, type of use	No				
10. Rare or unusual vegetation – old growth timber, riparian, alpine	No				
11. Species of special concern (plant or animal; state or federal listed or proposed for listing) or their habitat	No				
12. Unique ecosystems, biosphere reserves, World Heritage Sites	No				
13. Unique or important wildlife or wildlife habitat	No				
14. Unique or important fish or fish habitat	No				

Identify potential effects to the following physical, natural, or cultural resources	No Effect	Negligible Effects	Minor Effects	Exceeds Minor Effects	Data Needed to Determine/Notes
15. Introduce or promote non-native species (plant or animal)	No				
16. Recreation resources, including supply, demand, visitation, activities, etc.	No				
17. Visitor experience, aesthetic resources	No				
18. Archeological resources	No				Yosemite Valley Archeological District.
19. Prehistoric/historic structure	No				
20. Cultural landscapes	No				Yosemite Valley Historic District.
21. Ethnographic resources	No				
22. Museum collections (objects, specimens, and archival and manuscript collections)	No				
23. Socioeconomics, including employment, occupation, income changes, tax base, infrastructure	No				
24. Minority and low income	No				

Identify potential effects to the following physical, natural, or cultural resources	No Effect	Negligible Effects	Minor Effects	Exceeds Minor Effects	Data Needed to Determine/Notes
populations, ethnography, size, migration patterns, etc.					
25. Energy resources	No				
26. Other agency or tribal land use plans or policies	No				
27. Resource, including energy, conservation potential, sustainability	No				
28. Urban quality, gateway communities, etc.	No				
29. Long-term management of resources or land/resource productivity	No				
30. Other important environment resources (e.g. geothermal, paleontological resources)?	No				

C. MANDATORY CRITERIA

Mandatory Criteria: If implemented, would the proposal:	Yes	No	N/A	Comment or Data Needed to Determine
A. Have significant impacts on public health or safety?		No		
B. Have significant impacts on such natural resources and unique geographic characteristics as		No		

Mandatory Criteria: If implemented, would the proposal:	Yes	No	N/A	Comment or Data Needed to Determine
historic or cultural resources; park, recreation, or refuge lands; wilderness areas; wild or scenic rivers; national natural landmarks; sole or principal drinking water aquifers; prime farmlands; wetlands (Executive Order 11990); floodplains (Executive Order 11988); national monuments; migratory birds; and other ecologically significant or critical areas?				
C. Have highly controversial environmental effects or involve unresolved conflicts concerning alternative uses of available resources (NEPA section 102(2)(E))?		No		
D. Have highly uncertain and potentially significant environmental effects or involve unique or unknown environmental risks?		No		
E. Establish a precedent for future action or represent a decision in principle about future actions with potentially significant environmental effects?		No		
F. Have a direct relationship to other actions with individually insignificant, but cumulatively significant, environmental effects?		No		
G. Have significant impacts on properties listed or eligible for listing on the National Register of Historic Places, as determined by either the bureau or office?		No		
H. Have significant impacts on species listed or proposed to be listed on the List of Endangered or Threatened Species, or have significant impacts on designated		No		

Mandatory Criteria: If implemented, would the proposal:	Yes	No	N/A	Comment or Data Needed to Determine
Critical Habitat for these species?				
I. Violate a federal law, or a state, local, or tribal law or requirement imposed for the protection of the environment?		No		
J. Have a disproportionately high and adverse effect on low income or minority populations (Executive Order 12898)?		No		
K. Limit access to and ceremonial use of Indian sacred sites on federal lands by Indian religious practitioners or significantly adversely affect the physical integrity of such sacred sites (Executive Order 13007)?		No		
L. Contribute to the introduction, continued existence, or spread of noxious weeds or non-native invasive species known to occur in the area or actions that may promote the introduction, growth, or expansion of the range of such species (Federal Noxious Weed Control Act and Executive Order 13112)?		No		

For the purpose of interpreting these procedures within the NPS, any action that has the potential to violate the NPS Organic Act by impairing park resources or values would constitute an action that triggers the DOI exception for actions that threaten to violate a federal law for protection of the environment.

D. OTHER INFORMATION

1. Are personnel preparing this form familiar with the site? Yes
- 1.A. Did personnel conduct a site visit? No
2. Is the project in an approved plan such as a General Management Plan or an Implementation Plan with an accompanying NEPA document? No
3. Are there any interested or affected agencies or parties? No
4. Has consultation with all affected agencies or tribes been completed? Yes
5. Are there any connected, cumulative, or similar actions as part of the

proposed action? (e.g., other development projects in area or identified in GMP, adequate/available utilities to accomplish project) No

E. SUPERVISORY SIGNATORY

<u>Interdisciplinary Team</u>	<u>Field of Expertise</u>
Don L. Neubacher	Superintendent
Woody Smeck	Deputy Superintendent
Kathleen Morse	Chief of Planning
Randy Fong	Chief of Project Management
Teri Austin	Chief of Administration Management
Ed Walls	Chief of Facilities Management
Linda Mazzu	Chief of Resources Management & Science
Ethan McKinley	Acting Chief of Business and Revenue Management
Tom Medema	Chief of Interpretation and Education
Charles Cuvelier	Chief of Visitor and Resource Protection
William Bryan	Project Leader
Sue Clark	Acting Environmental Planning and Compliance Program Manager
Kimball Koch	Acting Historic Preservation Officer
Renea Kennec	NEPA Specialist

Based on the environmental impact information contained in the statutory compliance file and in this environmental screening form, environmental documentation for this stage of the subject project is complete.

Recommended:

Compliance Specialists	Date
<u>//Renea Kennec//</u> Compliance Specialist – Renea Kennec	<u>7/13/12</u>
<u>//Sue Clark//</u> Acting Compliance Program Manager – Sue Clark	<u>7/13/12</u>
<u>//Randy Fong//</u> Chief, Project Management – Randy Fong	<u>7/17/12</u>

Approved:

Superintendent	Date
<u>//Don L. Neubacher//</u> Don L. Neubacher	<u>7/18/12</u>

*The signed original of this document is on file at the
Environmental Planning and Compliance Office in
Yosemite National Park.*



National Park Service
U.S. Department of the Interior

Yosemite National Park
Date: 07/11/2012

PARK ESF ADDENDUM

Today's Date: July 11, 2012

PROJECT INFORMATION

Park Name: Yosemite National Park
Project Title: 2011-035 Curry Village Geologic Hazard Canvas Tent Relocation
PEPC Project Number:
Project Type: Tent Relocation (OTHER)
Project Location:
County, State: Mariposa, California
Project Leader: William Bryan

PARK ESF ADDENDUM QUESTIONS & ANSWERS

ESF Addendum Questions	Yes	No	N/A	Data Needed to Determine/Notes
SPECIAL STATUS SPECIES CHECKLIST				
Listed or proposed threatened or endangered species (Federal or State)?		No		
Species of special concern (Federal or State)?		No		
Park rare plants or vegetation?		No		
Potential habitat for any special-status species listed above?		No		
NATIONAL HISTORIC PRESERVATION ACT CHECKLIST				
Entail ground disturbance?	Yes			Pier blocks will need to be placed for each tent cabin; up to six inches of soil will be disrupted for leveling purposes.
Are any archeological or ethnographic sites located within the area of potential effect?	Yes			
Entail alteration of a historic structure or cultural		No		

ESF Addendum Questions	Yes	No	N/A	Data Needed to Determine/Notes
landscape?				
Has a National Register form been completed?	Yes			
Are there any structures on the park's List of Classified Structures in the area of potential effect?		No		
WILD AND SCENIC RIVERS ACT CHECKLIST				
Fall within a wild and scenic river corridor?	Yes			Merced River
Fall within the bed and banks AND will affect the free-flow of the river?		No		
Have the possibility of affecting water quality of the area?		No		
Remain consistent with its river segment classification?	Yes			
Fall on a tributary of a Wild and Scenic River?		No		
Will the project encroach or intrude upon the Wild and Scenic River corridor?		No		
Will the project unreasonably diminish scenic, recreational, or fish and wildlife values?		No		
Consistent with the provisions in the Merced River Plan Settlement Agreement?	Yes			
WILDERNESS ACT CHECKLIST				
Within designated Wilderness?		No		
Within a Potential Wilderness Addition?		No		



National Park Service
U.S. Department of the Interior

Yosemite National Park
Date: 07/11/2012

ASSESSMENT OF ACTIONS HAVING AN EFFECT ON CULTURAL RESOURCES

A. DESCRIPTION OF UNDERTAKING

1. **Park:** Yosemite National Park

2. **Project Description:**

Project Name: 2011-035 Curry Village Geologic Hazard Canvas Tent Relocation

Prepared by: Renea Kennec

Date Prepared: 12/13/2011

Telephone: 209-379-1038

PEPC Project Number: 37796

Area of potential effects (as defined in 36 CFR 800.16[d])

3. **Has the area of potential effects been surveyed to identify cultural resources?**

 No

 X Yes

Source or reference: Yosemite Valley Historic District; Yosemite Valley Archeological District.

Check here if no known cultural resources will be affected. (If this is because area has been disturbed, please explain or attach additional information to show the disturbance was so extensive as to preclude intact

 X cultural deposits.)

4. **Potentially Affected Resource(s):**

5. **The proposed action will: (check as many as apply)**

 No Destroy, remove, or alter features/elements from a historic structure

 No Replace historic features/elements in kind

 No Add non-historic features/elements to a historic structure

 No Alter or remove features/elements of a historic setting or environment
(inc. terrain)

 No Add non-historic features/elements (inc. visual, audible, or atmospheric)
to a historic setting or cultural landscape

No Disturb, destroy, or make archeological resources inaccessible
No Disturb, destroy, or make ethnographic resources inaccessible
Yes Potentially affect presently unidentified cultural resources
Begin or contribute to deterioration of historic features, terrain, setting,
No landscape elements, or archeological or ethnographic resources
Involve a real property transaction (exchange, sale, or lease of land or
No structures)
Other (please
specify): _____

6. Supporting Study Data:

(Attach if feasible; if action is in a plan, EA or EIS, give name and project or page number.)

B. REVIEWS BY CULTURAL RESOURCE SPECIALISTS

The park 106 coordinator requested review by the park's cultural resource specialist/advisors as indicated by check-off boxes or as follows:

[X] Archeologist
Name: Laura Kirn
Date: 07/05/2012

Check if project does not involve ground disturbance []
Assessment of Effect: X No Historic Properties Affected ___ No Adverse Effect ___ Adverse
Effect ___ Streamlined Review
Recommendations for conditions or stipulations:
Doc Method: Park Specific Programmatic Agreement

[X] Historical Architect
Name: Shawn Lingo
Date: 07/16/2012

Check if project does not involve ground disturbance []
Assessment of Effect: ___ No Historic Properties Affected X No Adverse Effect ___ Adverse
Effect ___ Streamlined Review
Recommendations for conditions or stipulations:
Doc Method: Park Specific Programmatic Agreement

[X] Anthropologist
Name: Jennifer Hardin
Date: 07/12/2012

Check if project does not involve ground disturbance []
Assessment of Effect: X No Historic Properties Affected ___ No Adverse Effect ___ Adverse

Effect ☐ Streamlined Review

Recommendations for conditions or stipulations:

Doc Method: Park Specific Programmatic Agreement

☒ Historical Landscape Architect

Name: David Humphrey

Date: 09/09/2011

Check if project does not involve ground disturbance ☐

Assessment of Effect: ☐ No Historic Properties Affected ☒ No Adverse Effect ☐ Adverse Effect ☐ Streamlined Review

Recommendations for conditions or stipulations: Project will comply with YOSE 1999 PA, Stipulation VII.C.2.c).

Doc Method: Park Specific Programmatic Agreement

No Reviews From: Curator, Historical Architect, Historian, 106 Advisor, Other Advisor, Anthropologist

C. PARK SECTION 106 COORDINATOR'S REVIEW AND RECOMMENDATIONS

1. Assessment of Effect:

<input type="checkbox"/> No Historic Properties	<input checked="" type="checkbox"/> No Adverse	<input type="checkbox"/> Adverse Effect
<input type="checkbox"/> Affected	<input checked="" type="checkbox"/> Effect	

2. Documentation Method:

☐ A. STANDARD 36 CFR PART 800 CONSULTATION

Further consultation under 36 CFR Part 800 is needed.

☐ B. STREAMLINED REVIEW UNDER THE 2008 SERVICEWIDE PROGRAMMATIC AGREEMENT (PA)

The above action meets all conditions for a streamlined review under section III of the 2008 Servicewide PA for Section 106 compliance.

APPLICABLE STREAMLINED REVIEW Criteria
(Specify 1-16 of the list of streamlined review criteria.)

☐ C. PLAN-RELATED UNDERTAKING

Consultation and review of the proposed undertaking were completed in the context of a plan review process, in accordance with the 2008 Servicewide PA and 36 CFR Part 800.

Specify plan/EA/EIS:

☒ D. UNDERTAKING RELATED TO ANOTHER AGREEMENT

The proposed undertaking is covered for Section 106 purposes under another document such as a statewide agreement established in accord with 36 CFR 800.7 or counterpart regulations.
Specify: 1999 Programmatic Agreement

☐ E. COMBINED NEPA/NHPA Document

Documentation is required for the preparation of an EA/FONSI or an EIS/ROD has been developed and used so as also to meet the requirements of 36 CFR 800.3 through 800.6

☐ F. No Potential to Cause Effects [800.3(a)(1)]

☐ G. Memo to SHPO/THPO

☐ H. Memo to ACHP

3. Additional Consulting Parties Information:

Additional Consulting Parties: No

4. Stipulations and Conditions:

Following are listed any stipulations or conditions necessary to ensure that the assessment of effect above is consistent with 36 CFR Part 800 criteria of effect or to avoid or reduce potential adverse effects.

5. Mitigations/Treatment Measures:

**Measures to prevent or minimize loss or impairment of historic/prehistoric properties:
(Remember that setting, location, and use may be relevant.)**

No Assessment of Effect mitigations identified.

D. RECOMMENDED BY PARK SECTION 106 COORDINATOR:

Acting Historic Preservation Officer:

Kimball Koch //Kimball Koch// **Date:** 7/16/12

E. SUPERINTENDENT'S APPROVAL

The proposed work conforms to the NPS *Management Policies* and *Cultural Resource Management Guideline*, and I have reviewed and approve the recommendations, stipulations, or conditions noted in Section C of this form.

Superintendent: //Don L. Neubacher// **Date:** 7/18/12

Don L. Neubacher

*The signed original of this document is on file at
Environmental Planning and Compliance Office
Yosemite National Park.*

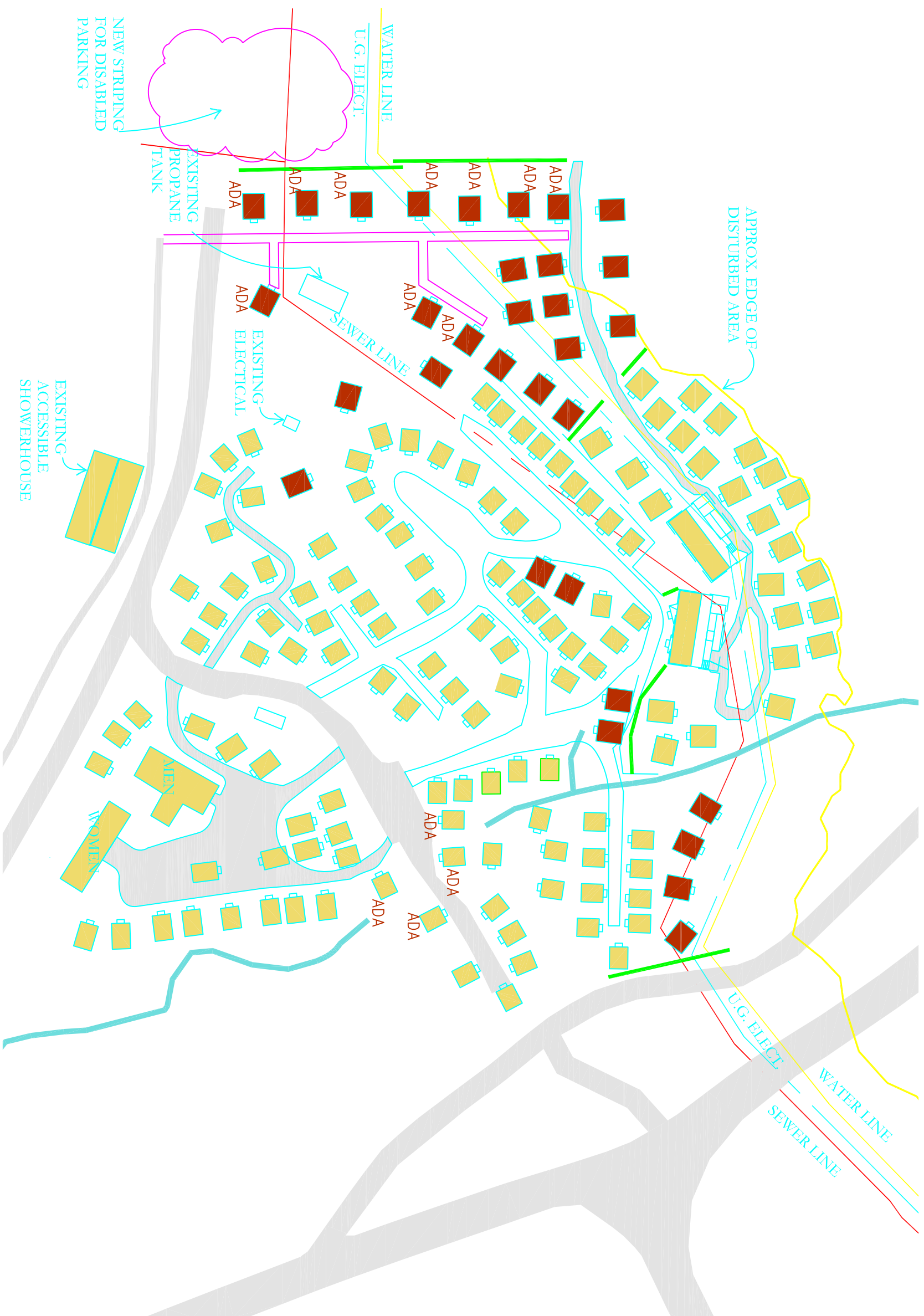

- EXISTING TRAIL/ROAD
- EXISTING STRUCTURES
- NEW STRUCTURES
- NEW ADA PATH OF TRAVEL
- NEW FENCE

BOYS TOWN SITE PLAN - JUNE 25, 2012

FINAL - FOR CONSTRUCTION

THIS DRAWING IS BASED ON DNC FIELD NOTES. ALL LOCATIONS OF TENTS, UTILITIES, ETC. ARE APPROXIMATE.



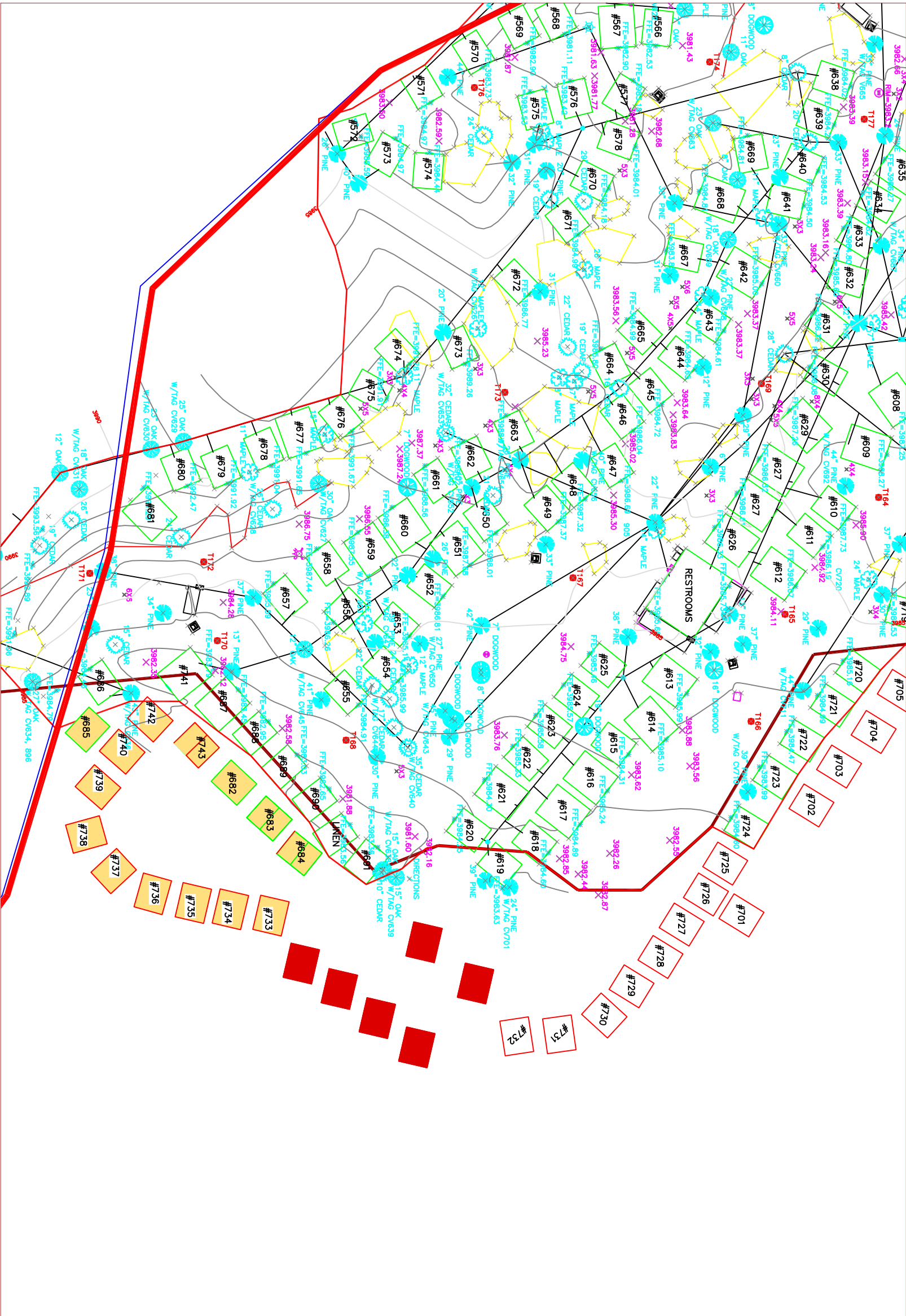

CURRY VILLAGE EAST SITE PLAN - JUNE 25, 2012

THIS DRAWING IS BASED ON DNC FIELD NOTES. ALL LOCATIONS OF TENTS, UTILITIES, ETC. ARE APPROXIMATE.

FINAL - FOR CONSTRUCTION

- EXISTING TRAIL/ROAD
- EXISTING STRUCTURES
- NEW STRUCTURES

