



IN REPLY REFER TO:
L7615(YOSE-PM)

United States Department of the Interior NATIONAL PARK SERVICE

Yosemite National Park
P. O. Box 577
Yosemite, California 95389

Memorandum

To: Garrett Chun, Project Manager, Yosemite National Park

From: Superintendent, Yosemite National Park

Subject: NEPA and NHPA Clearance: 2013-004 El Portal Well System Rehabilitation (45867)

The Executive Leadership Team has reviewed the proposed project/action and completed its environmental assessment documentation, and we have determined the following:

- There will not be any effect on threatened, endangered, or rare species and/or their critical habitat.
- There will be no historical properties affected.
- There will not be serious or long-term undesirable environmental or visual effects.

The subject proposed project, therefore, is now cleared for all NEPA and NHPA compliance requirements as presented above. Project plans and specifications are approved and construction and/or project implementation can commence.

For the proposed project actions to be within compliance requirements during construction and/or project implementation, the following mitigations must be adhered to:

- Project managers must find an alternative location for test wells that avoid ground disturbance in the area adjacent to or across the street from the old EP wastewater treatment plant. Please work with park archeology to avoid damage to culturally sensitive archeological resources that could be caused by heavy equipment accessing work areas.
- Roofing shingle material should be replacement-in-kind, but other materials are acceptable. All other materials will be replacement-in-kind. New structures are to be placed in as inconspicuous location as practicable. New colors of materials should blend into the surrounding areas to the extent possible. Park design guidelines will be followed.
- Ensure protection measures will be developed and implemented for access to well locations near and on archeological site; contact park Archeologist, Jun Kinoshita three weeks in advance of construction.

For complete compliance information see PEPC Project 45867.

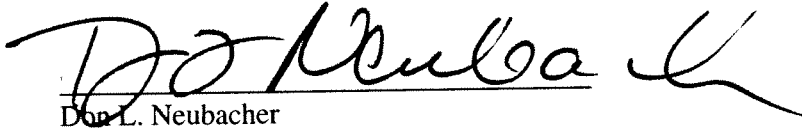

Don L. Neubacher

Enclosure (with attachments)

cc: Statutory Compliance File



Categorical Exclusion Form

Project: 2013-004 El Portal Well System Rehabilitation

PEPC Project Number: 45867

Project Description:

The El Portal water distribution network obtains water through a system of wells that serve Rancheria Flat, Old El Portal, the Trailer Court, and the El Portal Maintenance Complex. The existing water systems including the associated buildings, and mechanical and electrical systems are worn and obsolete and require a high amount of maintenance consisting of both preventative and reactive measures. The wells range in age from 25 to 40 years old. All well systems are considered at or beyond their service life.

There is a high risk of failure at any of these well system components. A single well failure will place excessive strain on the remaining wells to maintain system demand. Simultaneous well failure of multiple well systems will render the system unable to meet community water demands for domestic consumption and fire flow.

The purpose of this project is to provide the following corrective measures to the existing well system (wells 2, 3, 4, 5, 6, 7):

- Construction of 6' x 6' well pad and security enclosure for Wells #2, 3, 4, 5, 6, and 7. There will be 6" maximum of soil disturbance for subgrade compaction.
- Rehabilitation of Well House 4 and 5 (reroofing, interior renovation, exterior painting).
- Demolition of existing Tank #3 control building and installation of a new control building. New control building will be a 10.5' x 12' precast concrete unit and painted Wosky Brown. This work includes 6" of soil disturbance for subgrade compaction.
- Improve well system equipment including radio survey, SCADA, transmitter, RTU, and Tank 3 level sensor.
- Drill three test wells, in two locations in the El Portal Rancheria area to gauge availability of groundwater to supply an additional well (preliminary fact gathering for a potential future project). A 6' x 6' concrete well pad will be installed for each test well. Soil disturbance will be kept at a maximum depth of 6" for soil compaction.

Project Locations:

Mariposa County, CA

Mitigations:

- Project managers must find an alternative location for test wells that avoid ground disturbance in the area adjacent to or across the street from the old EP wastewater treatment plant. Please work

with park archeology to avoid damage to culturally sensitive archeological resources that could be caused by heavy equipment accessing work areas.

- Roofing shingle material should be replacement-in-kind, but other materials are acceptable. All other materials will be replacement-in-kind. New structures are to be placed in as inconspicuous location as practicable. New colors of materials should blend into the surrounding areas to the extent possible. Park design guidelines will be followed.
- Ensure protection measures can be developed and implemented for access to well locations near and on archeological site; contact park Archeologist, Jun Kinoshita three weeks in advance of construction.

Describe the category used to exclude action from further NEPA analysis and indicate the number of the category (see Section 3-4 of DO-12):

C.3 Routine maintenance and repairs to non-historic structures, facilities, utilities, grounds and trails.

On the basis of the environmental impact information in the statutory compliance file, with which I am familiar, I am categorically excluding the described project from further NEPA analysis. No exceptional circumstances (e.g. all boxes in the ESF are marked "no") or conditions in Section 3-6 apply, and the action is fully described in Section 3-4 of DO-12.

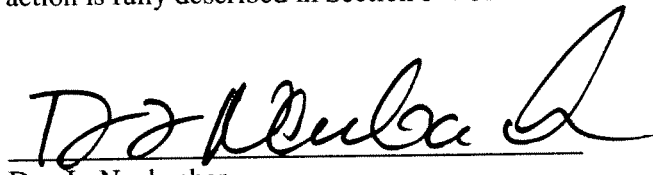
Don L. Neubacher

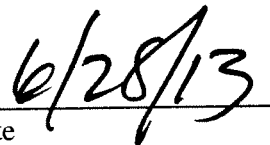
Date



National Park Service
U.S. Department of the Interior

Yosemite National Park
Date: 06/11/2013

ENVIRONMENTAL SCREENING FORM (ESF)

DO-12 APPENDIX 1

Date Form Initiated: 06/11/2013

Updated May 2007 - per 2004 Departmental Manual revisions and proposed Director's Order 12 changes

A. PROJECT INFORMATION

Park Name: Yosemite National Park
Project Title: 2013-004 El Portal Well System Rehabilitation
PEPC Project Number: 45867
Project Type: Facility Rehabilitation (FR)
Project Location:
County, State: Mariposa, California
Project Leader: Garrett Chun

Is project a hot topic (controversial or sensitive issues that should be brought to attention of Regional Director)? No

B. RESOURCE EFFECTS TO CONSIDER:

Identify potential effects to the following physical, natural, or cultural resources	No Effect	Negligible Effects	Minor Effects	Exceeds Minor Effects	Data Needed to Determine/Notes
1. Geologic resources – soils, bedrock, streambeds, etc.		Negligible			<u>Demo tank</u> 3 control building - 90 square feet, 1 foot deep <u>New tank</u> 3 control building - 126 square feet, 1.5 feet deep <u>New piping</u> for new tank 3 control building - 75 feet long by 3 feet wide = total 225 square feet <u>Concrete pad</u> for wells 3,4,6,7 - 6 feet by 6 feet by 6 inch deep <u>Concrete pad</u> for 3 Rancheria test wells - 6 feet by 6 feet by 6 inch deep <u>Test wells</u> - 200 feet deep by 6 inch in diameter

Identify potential effects to the following physical, natural, or cultural resources	No Effect	Negligible Effects	Minor Effects	Exceeds Minor Effects	Data Needed to Determine/Notes
2. From geohazards	No				
3. Air quality		Negligible			Temporary dust associated with construction equipment.
4. Soundscapes		Negligible			Temporary construction equipment noises during the project work.
5. Water quality or quantity	No				
6. Streamflow characteristics	No				
7. Marine or estuarine resources	No				
8. Floodplains or wetlands	No				
9. Land use, including occupancy, income, values, ownership, type of use	No				
10. Rare or unusual vegetation – old growth timber, riparian, alpine	No				
11. Species of special concern (plant or animal; state or federal listed or proposed for listing) or their habitat	No				
12. Unique ecosystems, biosphere reserves, World Heritage Sites	No				
13. Unique or important wildlife or wildlife habitat	No				
14. Unique or important fish or	No				

Identify potential effects to the following physical, natural, or cultural resources	No Effect	Negligible Effects	Minor Effects	Exceeds Minor Effects	Data Needed to Determine/Notes
15. Introduce or promote non-native species (plant or animal)	No				
16. Recreation resources, including supply, demand, visitation, activities, etc.	No				
17. Visitor experience, aesthetic resources	No				
18. Archeological resources		Negligible			Protection measures will be developed and implemented for access to well locations near and on archeological sites.
19. Prehistoric/historic structure	No				
20. Cultural landscapes	No				
21. Ethnographic resources		Negligible			There will be alternative test well locations that avoid ground disturbance in the area adjacent to or across the street from the old El Portal wastewater treatment plant. Please work with park archeology to avoid damage to culturally sensitive archeological resources that could be caused by heavy equipment accessing work areas.
22. Museum collections (objects, specimens, and archival and manuscript collections)	No				
23. Socioeconomics, including employment, occupation, income	No				

Identify potential effects to the following physical, natural, or cultural resources	No Effect	Negligible Effects	Minor Effects	Exceeds Minor Effects	Data Needed to Determine/Notes
changes, tax base, infrastructure					
24. Minority and low income populations, ethnography, size, migration patterns, etc.	No				
25. Energy resources	No				
26. Other agency or tribal land use plans or policies	No				
27. Resource, including energy, conservation potential, sustainability	No				
28. Urban quality, gateway communities, etc.	No				
29. Long-term management of resources or land/resource productivity	No				
30. Other important environment resources (e.g. geothermal, paleontological resources)?	No				

C. MANDATORY CRITERIA

Mandatory Criteria: If implemented, would the proposal:	Yes	No	N/A	Comment or Data Needed to Determine
A. Have significant impacts on public health or safety?		No		

Mandatory Criteria: If implemented, would the proposal:	Yes	No	N/A	Comment or Data Needed to Determine
B. Have significant impacts on such natural resources and unique geographic characteristics as historic or cultural resources; park, recreation, or refuge lands; wilderness areas; wild or scenic rivers; national natural landmarks; sole or principal drinking water aquifers; prime farmlands; wetlands (Executive Order 11990); floodplains (Executive Order 11988); national monuments; migratory birds; and other ecologically significant or critical areas?		No		
C. Have highly controversial environmental effects or involve unresolved conflicts concerning alternative uses of available resources (NEPA section 102(2)(E))?		No		
D. Have highly uncertain and potentially significant environmental effects or involve unique or unknown environmental risks?		No		
E. Establish a precedent for future action or represent a decision in principle about future actions with potentially significant environmental effects?		No		
F. Have a direct relationship to other actions with individually insignificant, but cumulatively significant, environmental effects?		No		
G. Have significant impacts on properties listed or eligible for listing on the National Register of Historic Places, as determined by either the bureau or office?		No		
H. Have significant impacts on species listed or proposed to be listed on the List of Endangered or Threatened Species, or have		No		

Mandatory Criteria: If implemented, would the proposal:	Yes	No	N/A	Comment or Data Needed to Determine
significant impacts on designated Critical Habitat for these species?				
I. Violate a federal law, or a state, local, or tribal law or requirement imposed for the protection of the environment?		No		
J. Have a disproportionately high and adverse effect on low income or minority populations (Executive Order 12898)?		No		
K. Limit access to and ceremonial use of Indian sacred sites on federal lands by Indian religious practitioners or significantly adversely affect the physical integrity of such sacred sites (Executive Order 13007)?		No		
L. Contribute to the introduction, continued existence, or spread of noxious weeds or non-native invasive species known to occur in the area or actions that may promote the introduction, growth, or expansion of the range of such species (Federal Noxious Weed Control Act and Executive Order 13112)?		No		

D. OTHER INFORMATION

1. Are personnel preparing this form familiar with the site? Yes
- 1.A. Did personnel conduct a site visit? No
2. Is the project in an approved plan such as a General Management Plan or an Implementation Plan with an accompanying NEPA document? No
3. Are there any interested or affected agencies or parties? No
4. Has consultation with all affected agencies or tribes been completed? No
5. Are there any connected, cumulative, or similar actions as part of the proposed action? (e.g., other development projects in area or identified in GMP, adequate/available utilities to accomplish project) No



E. INTERDISCIPLINARY TEAM SIGNATORIES

<u>Interdisciplinary Team</u>	<u>Field of Expertise</u>
Don L. Neubacher	Superintendent
Michael Gauthier	Chief of Staff
Kathleen Morse	Chief of Planning
Randy Fong	Chief of Project Management
Teri Austin	Chief of Administration Management
Ed Walls	Chief of Facilities Management
Linda C. Mazzu	Chief of Resources Management & Science
Kris Kirby	Chief of Business and Revenue Management
Tom Medema	Chief of Interpretation and Education
Kevin Killian	Acting Chief of Visitor and Resource Protection
Garrett Chun	Project Leader
Madelyn Ruffner	Acting Environmental Planning and Compliance Program Manager
Renea Kennec	NEPA Specialist

F. SUPERVISORY SIGNATORY

Based on the environmental impact information contained in the statutory compliance file and in this environmental screening form, environmental documentation for this stage of the subject project is complete.

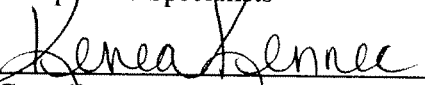
Recommended:

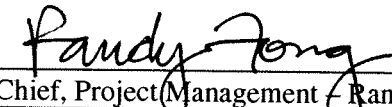
Compliance Specialists	Date
 Compliance Specialist – Renea Kennec	<u>6/24/13</u>
 Acting Compliance Program Manager – Madelyn Ruffner	<u>6/24/13</u>
 Chief, Project Management – Randy Fong	<u>6/26/13</u>

Approved:

Superintendent	Date
 Don L. Neubacher	<u>6/28/13</u>



PARK ESF ADDENDUM

Today's Date: June 11, 2013

PROJECT INFORMATION

Park Name: Yosemite National Park
Project Title: 2013-004 El Portal Well System Rehabilitation
PEPC Project Number: 45867
Project Type: Facility Rehabilitation (FR)
Project Location:
County, State: Mariposa, California
Project Leader: Garrett Chun

PARK ESF ADDENDUM QUESTIONS & ANSWERS

ESF Addendum Questions	Yes	No	N/A	Data Needed to Determine/Notes
SPECIAL STATUS SPECIES CHECKLIST				
Listed or proposed threatened or endangered species (Federal or State)?		No		
Species of special concern (Federal or State)?		No		
Park rare plants or vegetation?		No		
Potential habitat for any special-status species listed above?		No		
NATIONAL HISTORIC PRESERVATION ACT CHECKLIST				
Entail ground disturbance?	Yes			<u>Demo tank</u> 3 control building - 90 square feet, 1 foot deep <u>New tank #3</u> control building - 126 square feet, 1.5 feet deep <u>New piping</u> for new tank 3 control building - 75 feet long by 3 feet wide = total 225 square feet <u>Concrete pad</u> for wells 3,4,6,7 - 6 feet by 6 feet by 6 inch deep <u>Concrete pad</u> for 3 Rancheria test wells - 6 feet by 6 feet by 6 inch deep <u>Test wells</u> - 200 feet deep by 6 inch in diameter
Are any archeological or ethnographic sites located	Yes			Archeological and ethnographic

ESF Addendum Questions	Yes	No	N/A	Data Needed to Determine/Notes
within the area of potential effect?				sites will be avoided throughout project.
Entail alteration of a historic structure or cultural landscape?		No		
Has a National Register form been completed?		No		
Are there any structures on the park's List of Classified Structures in the area of potential effect?		No		
WILD AND SCENIC RIVERS ACT CHECKLIST				
Fall within a wild and scenic river corridor?	Yes			Merced River
Fall within the bed and banks AND will affect the free-flow of the river?		No		
Have the possibility of affecting water quality of the area?		No		
Remain consistent with its river segment classification?	Yes			
Fall on a tributary of a Wild and Scenic River?		No		
Will the project encroach or intrude upon the Wild and Scenic River corridor?		No		
Will the project unreasonably diminish scenic, recreational, or fish and wildlife values?		No		
Consistent with the provisions in the Merced River Plan Settlement Agreement?	Yes			
WILDERNESS ACT CHECKLIST				
Within designated Wilderness?		No		
Within a Potential Wilderness Addition?		No		

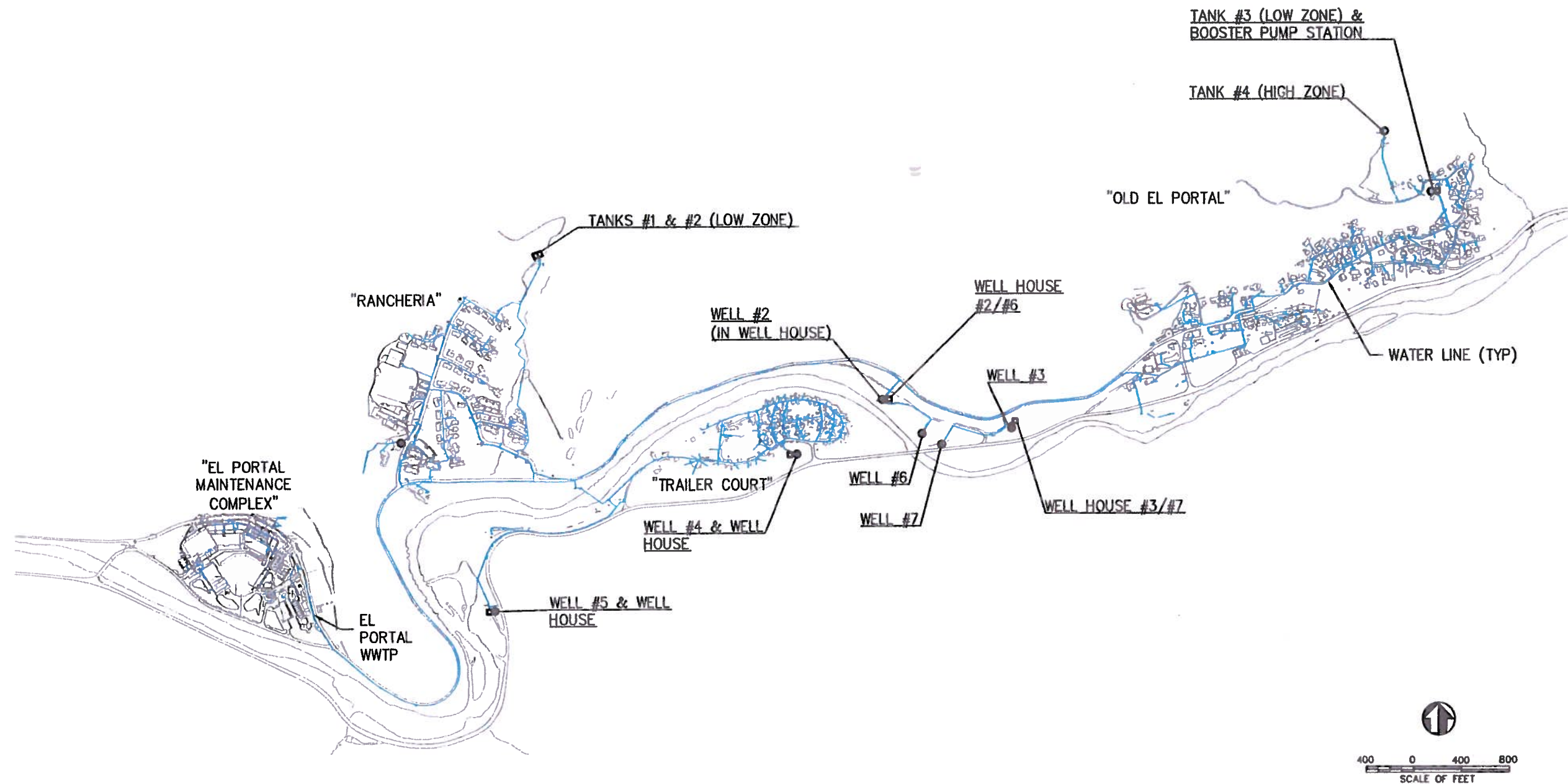
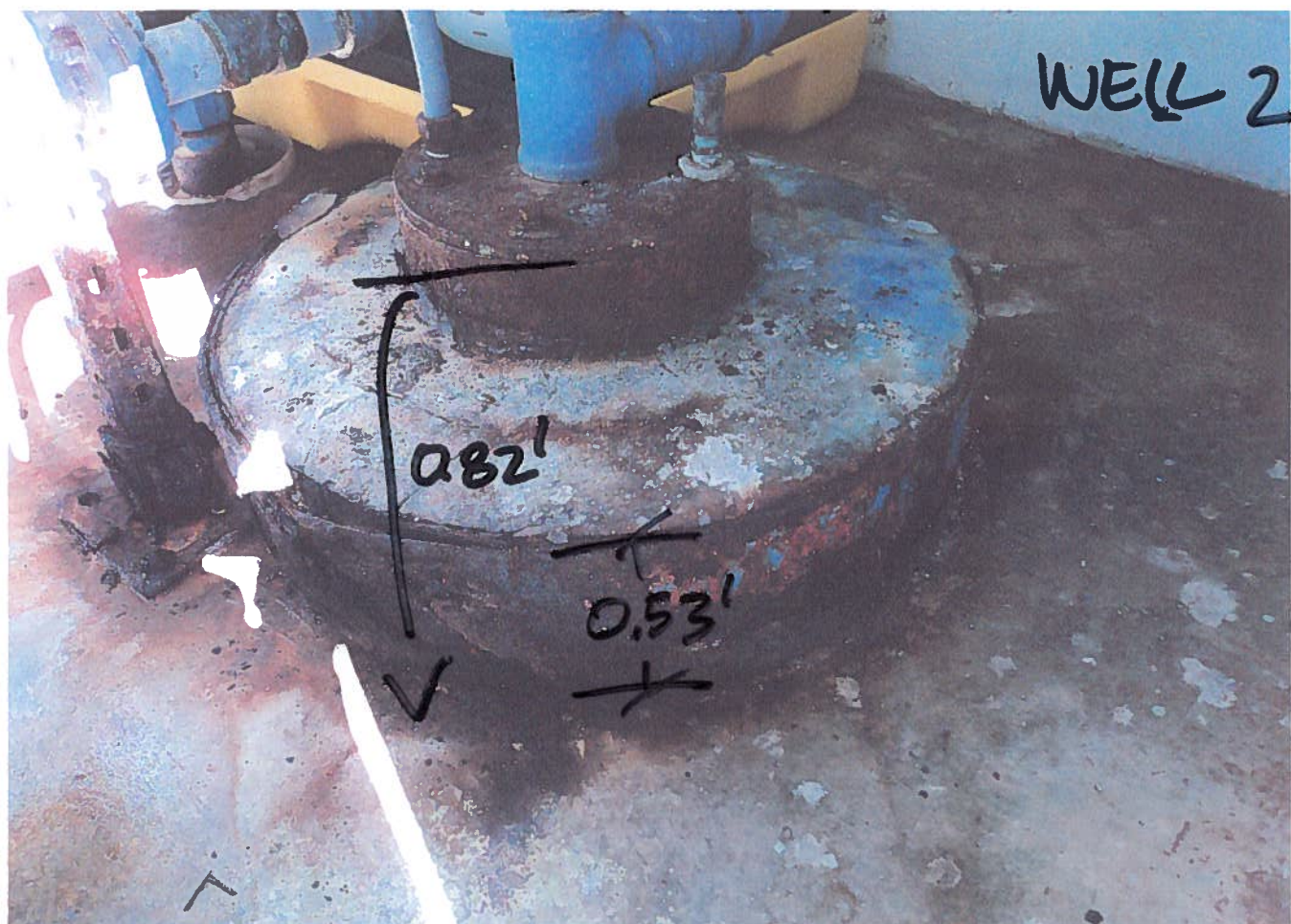

FIGURE 2
YOSEMITE NATIONAL PARK - EL PORTAL WELL REHABILITATION PROJECT
EXISTING WATER SUPPLY SYSTEM OVERVIEW





Well 4 and Well House 4 (EPB 825)



Well House 4 in El Portal Trailer Park



Well 4 in vicinity of Trailer Park playground

Well 5 and Well House 5 (EPB 824)



Well House 5 with Well 5 on the left (located in Sand Pit next to Merced River)



Well 5 in foreground, Well House 5 in background (located in Sand Pit next to Merced River)

Tank 3 Control Building



Tank 3 Control Building located in Old El Portal (Tank 3 located on left of picture)



National Park Service
U.S. Department of the Interior

Yosemite National Park
Date: 06/11/2013

ASSESSMENT OF ACTIONS HAVING AN EFFECT ON CULTURAL RESOURCES

A. DESCRIPTION OF UNDERTAKING

1. **Park:** Yosemite National Park

2. **Project Description:**

Project Name: 2013-004 El Portal Well System Rehabilitation

Prepared by: Renea Kennec

Date Prepared: 06/11/2013

Telephone: 209-379-1038

PEPC Project Number: 45867

Area of potential effects (as defined in 36 CFR 800.16[d])

El Portal Archeological District; El Portal Resources of Cultural Significance (un-evaluated)

3. **Has the area of potential effects been surveyed to identify historic properties?**

 No

 X Yes

Source or reference: El Portal Archeological District

4. **Potentially Affected Resource(s):**

Archeological resources affected:

Name and number: El Portal Archeological District

NR status: 1 - Listed in Register and documented

Ethnographic Resources Affected:

Name and number: El Portal Resources of Cultural Significance (un-evaluated)

5. **The proposed action will: (check as many as apply)**

 No Destroy, remove, or alter features/elements from a historic structure

 No Replace historic features/elements in kind

 No Add non-historic features/elements to a historic structure

 Alter or remove features/elements of a historic setting or environment

 No (inc. terrain)

☐ Add non-historic features/elements (inc. visual, audible, or atmospheric)
☐ No to a historic setting or cultural landscape
☐ No Disturb, destroy, or make archeological resources inaccessible
☐ No Disturb, destroy, or make ethnographic resources inaccessible
☐ Yes Potentially affect presently unidentified cultural resources
☐ No Begin or contribute to deterioration of historic features, terrain, setting, landscape elements, or archeological or ethnographic resources
☐ No Involve a real property transaction (exchange, sale, or lease of land or structures)
☐ Other (please specify): _____

6. Supporting Study Data:

(Attach if feasible; if action is in a plan, EA or EIS, give name and project or page number.)

B. REVIEWS BY CULTURAL RESOURCE SPECIALISTS

The park 106 coordinator requested review by the park's cultural resource specialist/advisors as indicated by check-off boxes or as follows:

☒ Archeologist
 Name: Sonny Montague
 Date: 05/01/2013

Check if project does not involve ground disturbance ☐
 Assessment of Effect: ☐ No Potential to Cause Effect ☐ No Historic Properties
 Affected ☒ No Adverse Effect ☐ Adverse Effect ☐ Streamlined Review
 Recommendations for conditions or stipulations: Contact archeologist Jun Kinoshita three weeks in advance of construction so that protection measures can be developed and implemented for access to well locations near and on archeological sites.
 Doc Method: Park Specific Programmatic Agreement

☒ Anthropologist
 Name: Jennifer Hardin
 Date: 06/11/2013

Check if project does not involve ground disturbance ☐
 Assessment of Effect: ☐ No Potential to Cause Effect ☐ No Historic Properties
 Affected ☒ No Adverse Effect ☐ Adverse Effect ☐ Streamlined Review
 Recommendations for conditions or stipulations: Project managers must find an alternative location for test wells that avoid ground disturbance in the area adjacent to or across the street from the old EP wastewater treatment plant. Please work with YOSE archeology to avoid damage to culturally sensitive archeological resources that could be caused by heavy equipment accessing work areas.
 Doc Method: Standard 4-Step Process

[X] Historical Landscape Architect
Name: Kevin McCardle
Date: 05/14/2013

Check if project does not involve ground disturbance []

Assessment of Effect: ☐ No Potential to Cause Effect ☐ No Historic Properties
Affected ☒ No Adverse Effect ☐ Adverse Effect ☐ Streamlined Review

Recommendations for conditions or stipulations: Roofing shingle material should be replacement-in-kind, but other materials are acceptable. All other materials will be replacement-in-kind. New structures are to be placed in as inconspicuous location as practicable. New colors of materials should blend into the surrounding areas to the extent possible. Park design guidelines will be followed.

Doc Method: Park Specific Programmatic Agreement

No Reviews From: Curator, Historical Architect, Historian, 106 Advisor, Other Advisor

C. PARK SECTION 106 COORDINATOR'S REVIEW AND RECOMMENDATIONS

1. Assessment of Effect:

☐ **No Potential to Cause Effects**
☐ **No Historic Properties Affected**
☒ **No Adverse Effect**
☐ **Adverse Effect**

2. Documentation Method:

[] **A. STANDARD 36 CFR PART 800 CONSULTATION**
Further consultation under 36 CFR Part 800 is needed.

[] **B. STREAMLINED REVIEW UNDER THE 2008 SERVICEWIDE PROGRAMMATIC AGREEMENT (PA)**

The above action meets all conditions for a streamlined review under section III of the 2008 Servicewide PA for Section 106 compliance.

APPLICABLE STREAMLINED REVIEW Criteria
(Specify 1-16 of the list of streamlined review criteria.)

[] **C. PLAN-RELATED UNDERTAKING**

Consultation and review of the proposed undertaking were completed in the context of a plan review process, in accordance with the 2008 Servicewide PA and 36 CFR Part 800.
Specify plan/EA/EIS:

[X] **D. UNDERTAKING RELATED TO ANOTHER AGREEMENT**

The proposed undertaking is covered for Section 106 purposes under another document such as a statewide agreement established in accord with 36 CFR 800.7 or counterpart regulations.
Specify: **1999 Programmatic Agreement**

☐ E. COMBINED NEPA/NHPA Document

Documentation is required for the preparation of an EA/FONSI or an EIS/ROD has been developed and used so as also to meet the requirements of 36 CFR 800.3 through 800.6

☐ G. Memo to SHPO/THPO

☐ H. Memo to ACHP

3. Additional Consulting Parties Information:

Additional Consulting Parties: No

4. Stipulations and Conditions:

Following are listed any stipulations or conditions necessary to ensure that the assessment of effect above is consistent with 36 CFR Part 800 criteria of effect or to avoid or reduce potential adverse effects.

5. Mitigations/Treatment Measures:

Measures to prevent or minimize loss or impairment of historic/prehistoric properties:

- Project managers must find an alternative location for test wells that avoid ground disturbance in the area adjacent to or across the street from the old EP wastewater treatment plant. Please work with park archeology to avoid damage to culturally sensitive archeological resources that could be caused by heavy equipment accessing work areas.
- New structures are to be placed in as inconspicuous location as practicable. New colors of materials should blend into the surrounding areas to the extent possible. Park design guidelines will be followed.
- Ensure protection measures can be developed and implemented for access to well locations near and on archeological site; contact park Archeologist, Jun Kinoshita three weeks in advance of construction.

D. RECOMMENDED BY PARK SECTION 106 COORDINATOR:

Acting Historic Preservation Officer:

Kimball Koch  Date: 6/12/13

E. SUPERINTENDENT'S APPROVAL

The proposed work conforms to the NPS *Management Policies* and *Cultural Resource Management Guideline*, and I have reviewed and approve the recommendations, stipulations, or conditions noted in Section C of this form.

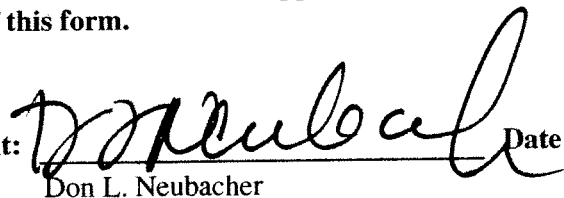
Superintendent:  Date: 6/28/13
Don L. Neubacher