

Visitor Access Planning at Muir Woods

Public Scoping Meeting
September 18, 2013

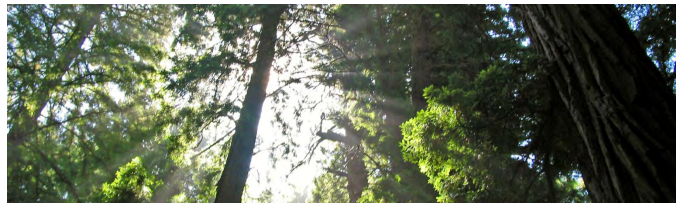

Today's Presentation

- i. The Need
- ii. Finding Solutions
- iii. The Way Forward
- iv. Questions



A lush green forest scene with tall, slender trees and dense foliage. Sunlight filters through the canopy, creating dappled light on the forest floor. A wooden bridge or walkway is visible in the foreground, crossing a small stream or path. The overall atmosphere is serene and natural.

PART 1

The Need

Visitation Trends

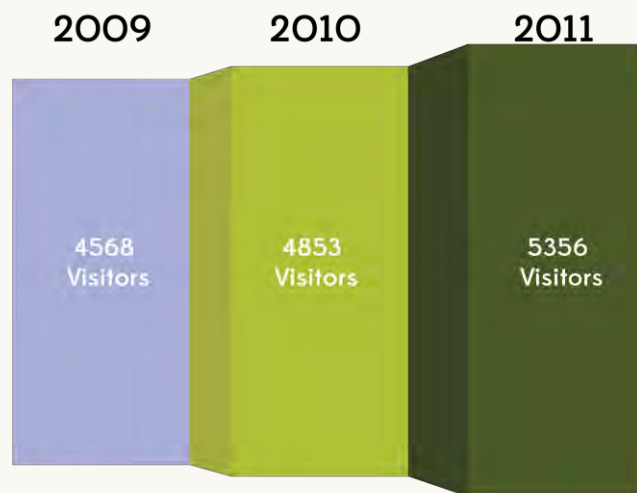

40% Increase over past 10 years

**July 5, 2013 — 6,000+
Busiest Day on Record**

INDICATOR	STANDARD	USER CAPACITY
Pinchot Tree	30	4,310
Redwood Crosscut	30	4,780
Valley Floor Trail "Thru"	18	3,750
Valley Floor Trail Interpretive	18	3,200
Hillside Trail Encounters	40	3,620

**Recommended range
for daily visitation:
3,500 to 4,000**

Important Resource Values



Congestion and Safety



Adjacent Rds.



Muir Woods Rd.

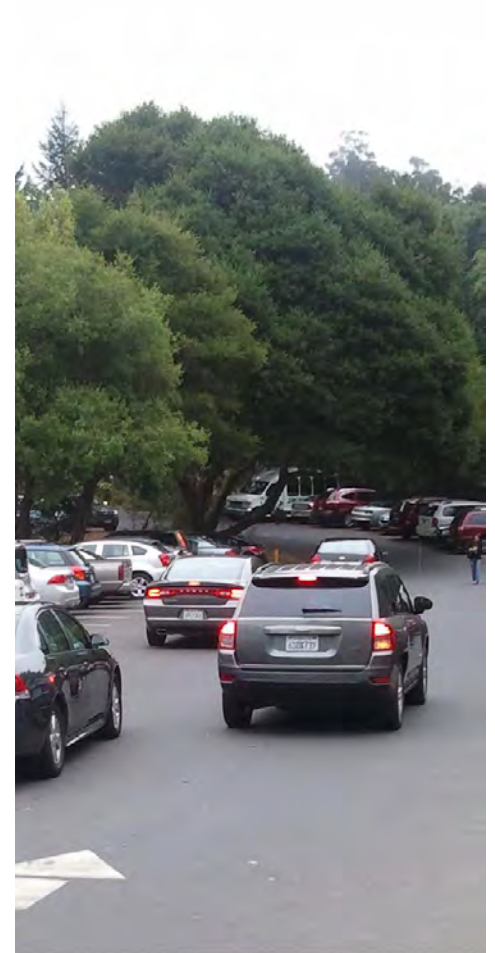

Parking Lots

Inspiration?



A lush green forest scene with tall, slender trees and a dense canopy. Sunlight filters through the leaves, creating a dappled light effect on the forest floor. In the foreground, a small stream flows over rocks, with a simple wooden bridge crossing it. The overall atmosphere is serene and natural.

PART 2

Finding Solutions

Some Perspective

- 1896 Gravity Car
- 1908 Muir Woods NM
- 1924 No Vehicles in the Groves
- 1937 Golden Gate Bridge
- 1955 Existing Parking Lots
- 1989 Coho salmon listed
- 2003 Redwood Creek Vision
- 2004 Transportation Studies
- 2005 Muir Woods Shuttle
- 2011 General Management Plan

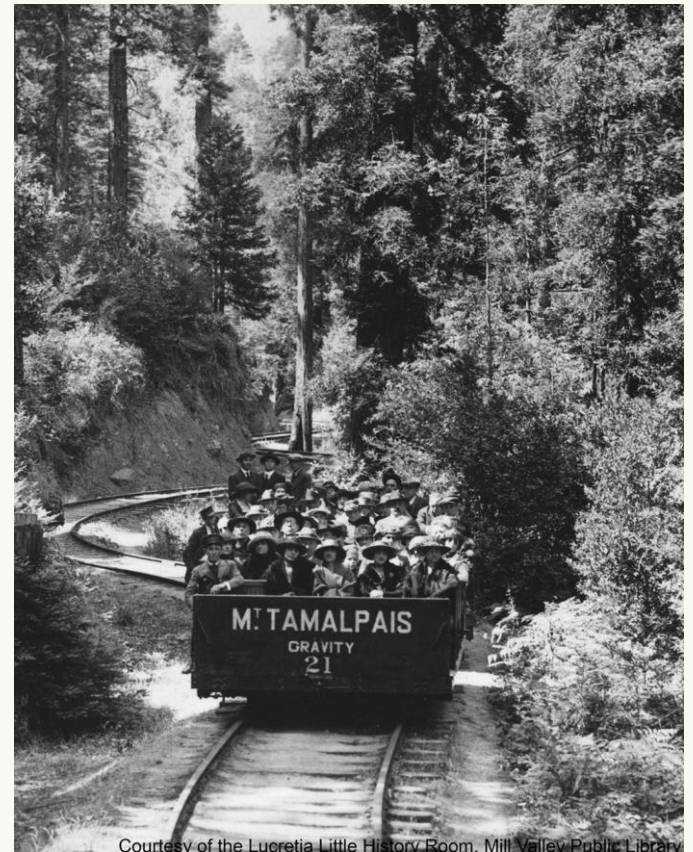

Courtesy of the Lucretia Little History Room, Mill Valley Public Library



Important Realities

- Existing conditions are not sustainable
- Visitation must be managed, especially at peak times
- Ability to add parking near Muir Woods is limited
- A watershed-focused solution is needed near term
- This can only be solved in close partnership

Our Purpose

To better manage Muir Woods visitor demand and transportation services to improve visitor experience and reduce resource impacts.



Two Projects

A green circle with a black outline, containing text.

Reservation and Shuttle System

2014-15 Implementation

A yellow circle with a black outline, containing text.

Transportation and Access Site Improvements

2016+ Implementation

System Overview

Reservation System

- Website and call center options
- Reserve parking and/or shuttle time slot
- Reservations offered at rate that matches available capacity

Parking Management

- Muir Woods Lots
- Lower Muir Woods Road Shoulder
- Panoramic Highway Shoulder

Shuttle Systems

- Sausalito Ferry Connection
- Highway 101/1 Shuttle
- Panoramic Highway Loop

Concession Contract for Transportation Services

Enhanced Partnership Agreements

Reservation System

Advanced ticketing and arrival mode selection for >80% visitors

We will contract with a private company to distribute reservations through a call center, website, local outlets and “on site” at various lots and intercepts.

Managing all motorized transportation within availability of infrastructure capacity – enabling everyone to have a successful visit.

Spreads and reduces intra-week & intra-day peak hour visitation for target desired experience and to avoid failures

No reduction in overall visitation — accommodates some growth during off-peak days & months

Enables visitors to be informed, engaged and prepared for a trip to Muir Woods – and enables us to be ready with what they need (parking spots, shuttle seats, and room on the trails!)

Reservation System



Muir Woods

Tickets & Tours

Search by Date:

09/03/2013



Ticket Quantity

Search

Muir Woods tickets can sell out several weeks in advance.

Save Time! Avoid the lines!
Buy "Print At Home eTickets" Now!



Helpful Tips: Getting the most from your Muir Woods Visit

Exclusive
Carrier to
Alcatraz

**GUARANTEED
LOWEST PRICE**

Adult Admission
with Audio Tour

Tickets now available for
the next 90 days.

Alcatraz Tickets Facts:

- We are the official website for Alcatraz Tours to Alcatraz Island
- We guarantee the lowest prices for Alcatraz tickets



Visitor Video Series

How to get the most out of your trip to Alcatraz Island.



Alcatraz and history go hand in hand. Once home to some of America's most notorious criminals, the federal penitentiary that operated here from 1934 to 1963 brought a dark mystique to the Rock. The presence of infamous inmates like Al "Scarface" Capone, and the "Birdman" Robert Stroud helped to establish the island's notoriety. To this day, Alcatraz is best known as one of the world's most legendary prisons.

Many people, though, are unaware of the wealth of other stories to be

Reservation System



Muir Woods

Ticket Information

Adult 18–61 (years of age)
 Junior 12–17
 Child 5–11
 Senior 62 (and over)

Toddlers 0–4 (are free!)

WT: Web Ticket

Muir Woods tickets can sell out several weeks in advance.

Save Time! Avoid the lines!

Buy "Print At Home eTickets" Now!



Helpful Tips: Getting the most from your Muir Woods Visit

Exclusive
 Cartier to
 Muir Woods

**GUARANTEED
 LOWEST PRICE**

Adult Admission
 with Audio Tour

Tickets now available for the next 90 days.

[Cart](#)

[Keep Shopping](#)

	Sun Sep 8 2013	Mon Sep 9 2013	Tue Sep 10 2013	Wed Sep 11 2013	Thu Sep 12 2013
	—	—	—	—	—
Drive	—	—	—	—	—
Drive & Shuttle	—	—	12:00 pm 12:30 pm 1:00 pm 1:30 pm	9:30 am 12:00 pm 12:30 pm 1:00 pm 1:30 pm	9:30 am 12:00 pm 12:30 pm 1:30 pm
Ferry & Shuttle	—	2:40 pm	2:10 pm 2:40 pm	2:10 pm 2:40 pm	2:10 pm 2:40 pm
Commercial Tours	—	—	3:20 pm 3:50 pm	3:20 pm	—

[<< Previous 5 days](#) [Next 5 days >>](#)

Shuttle System

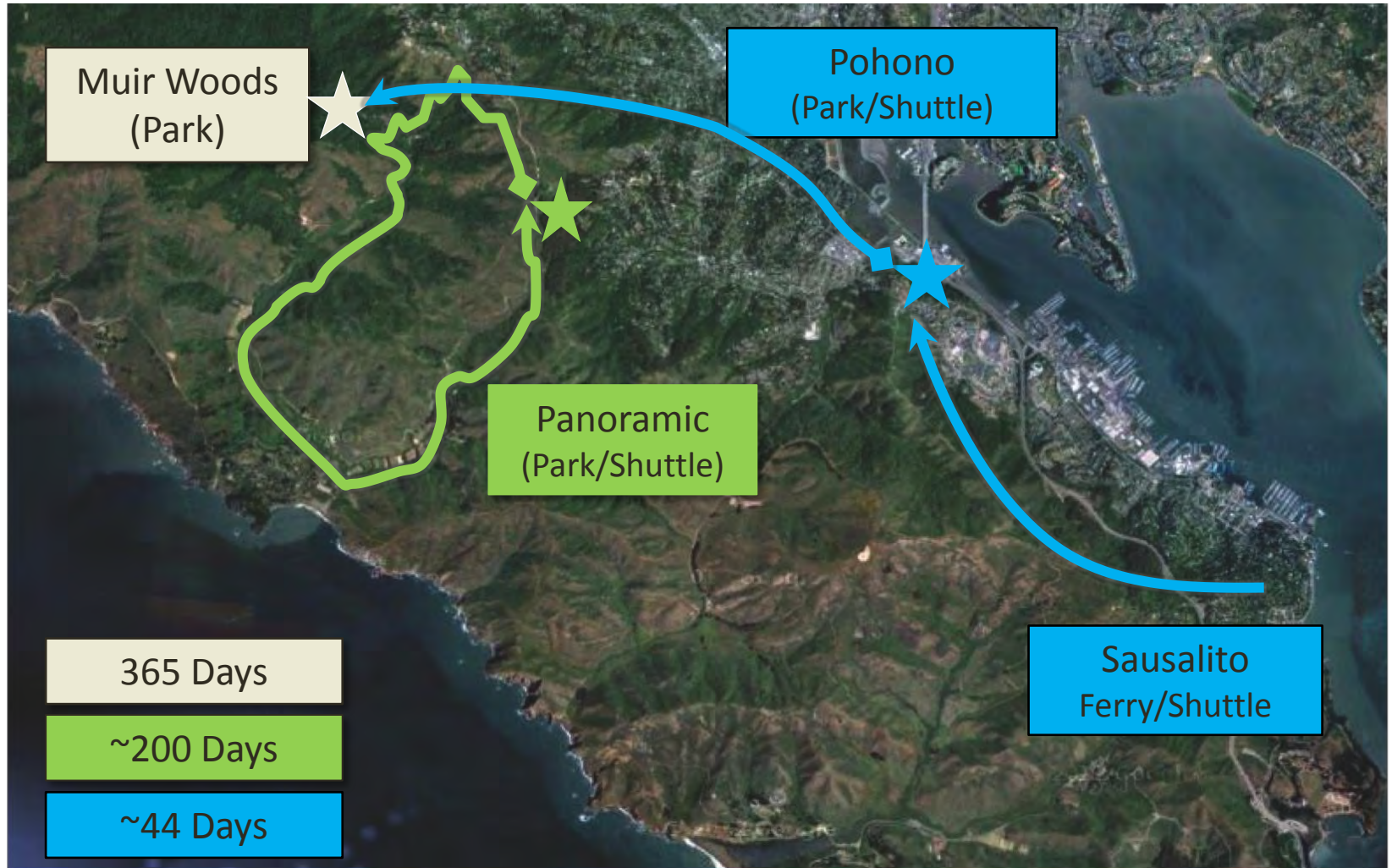

Parking Management



Shoulder Parking on Panoramic
with flagged shuttle pick-up

Parking Management

- Reservations will provide visitors with arrival time, but no end time...visitors can enjoy the park at their pace.
- Series of signs on US 101 and Highway 1 will alert visitors to the need for reservations and where to go based on availability.
- Attendants will manage parking on-site and issue on-site permits when available
- Access to State Park trailheads will be maintained



Parking Management

- A further economic study will determine the pricing schedule considering these important factors:
 - Financial sustainability of the additional services
 - Rewards for shuttle ridership
 - Overall affordability
 - Access for youth and other underrepresented groups

Initial Feasibility Study Estimate Ranges

(Actual Pricing TBD)

Mode of Arrival	Transportation or Parking Services	Total Cost w/Entrance Fee (Family of 4)
Drive to Muir Woods	\$7-15 per car	\$20-30
Park and Ride Shuttle	\$5-10 per person	\$10-20

Smoother Visitation

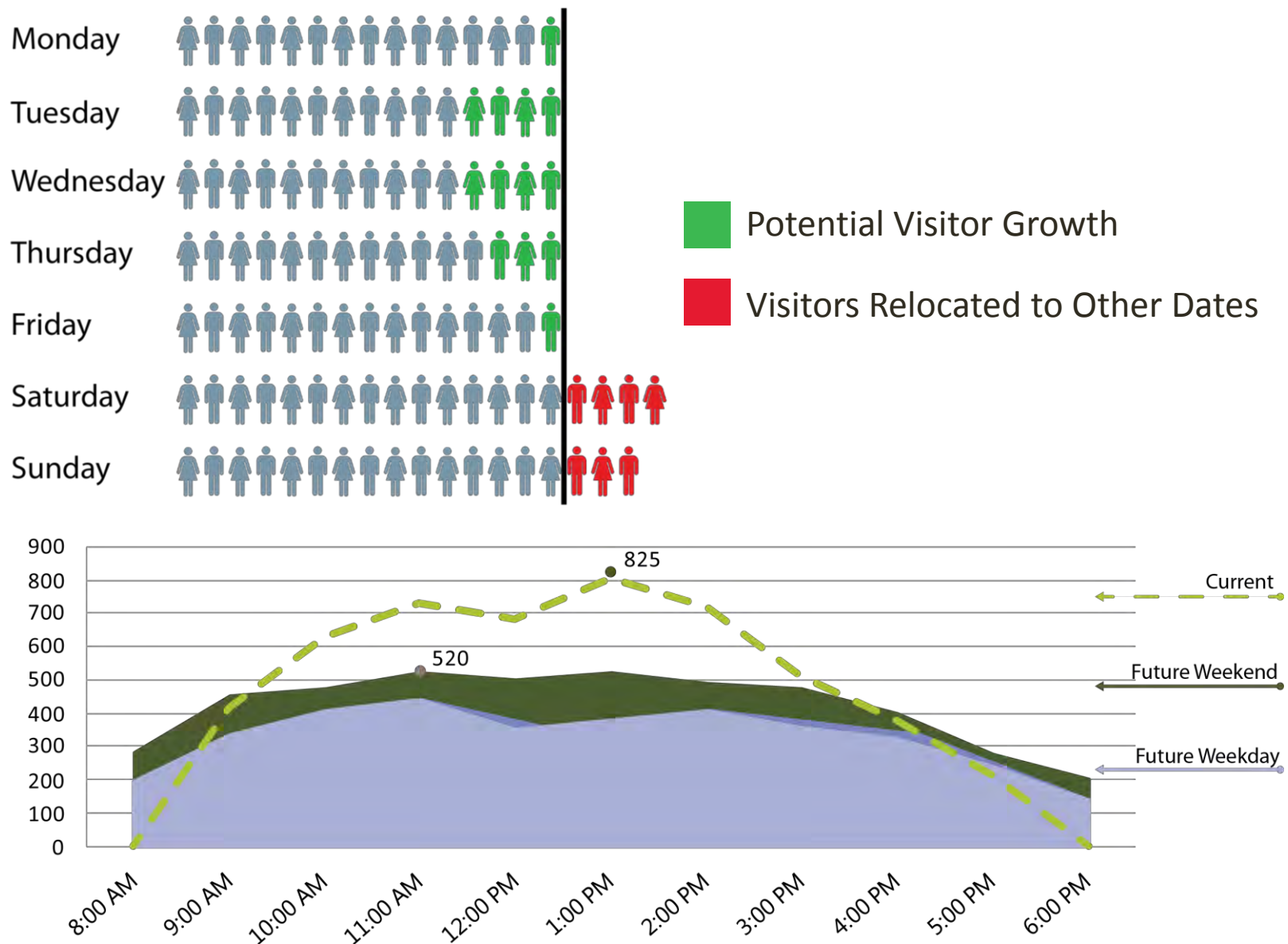

Peak Congestion Relief

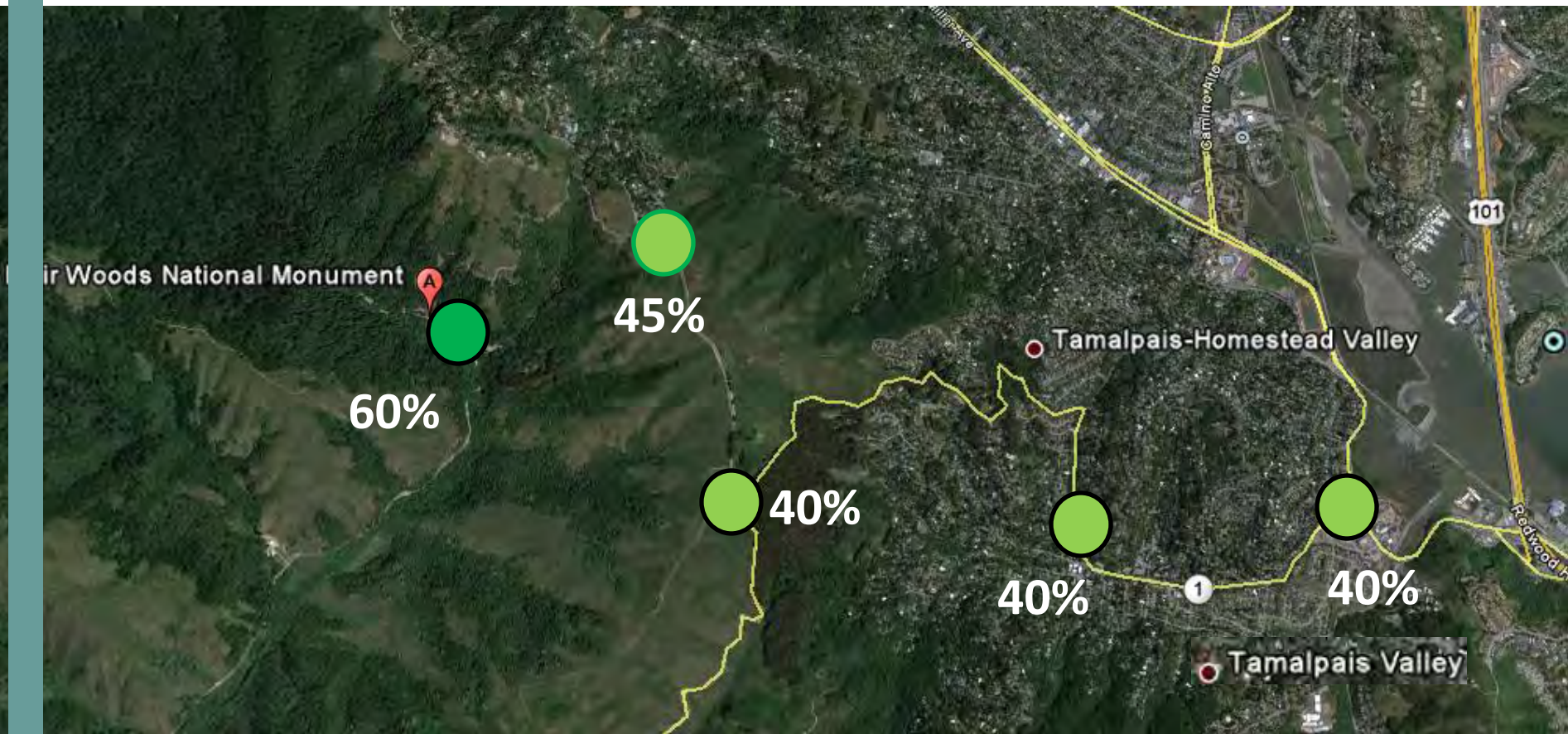

**% Estimated reduced Muir Woods
vehicle trips during peak hours**

Two Projects



Reservation and Shuttle System

2014-15 Implementation



Transportation and Access Site Improvements

2016+ Implementation

Site Improvements

Separate project

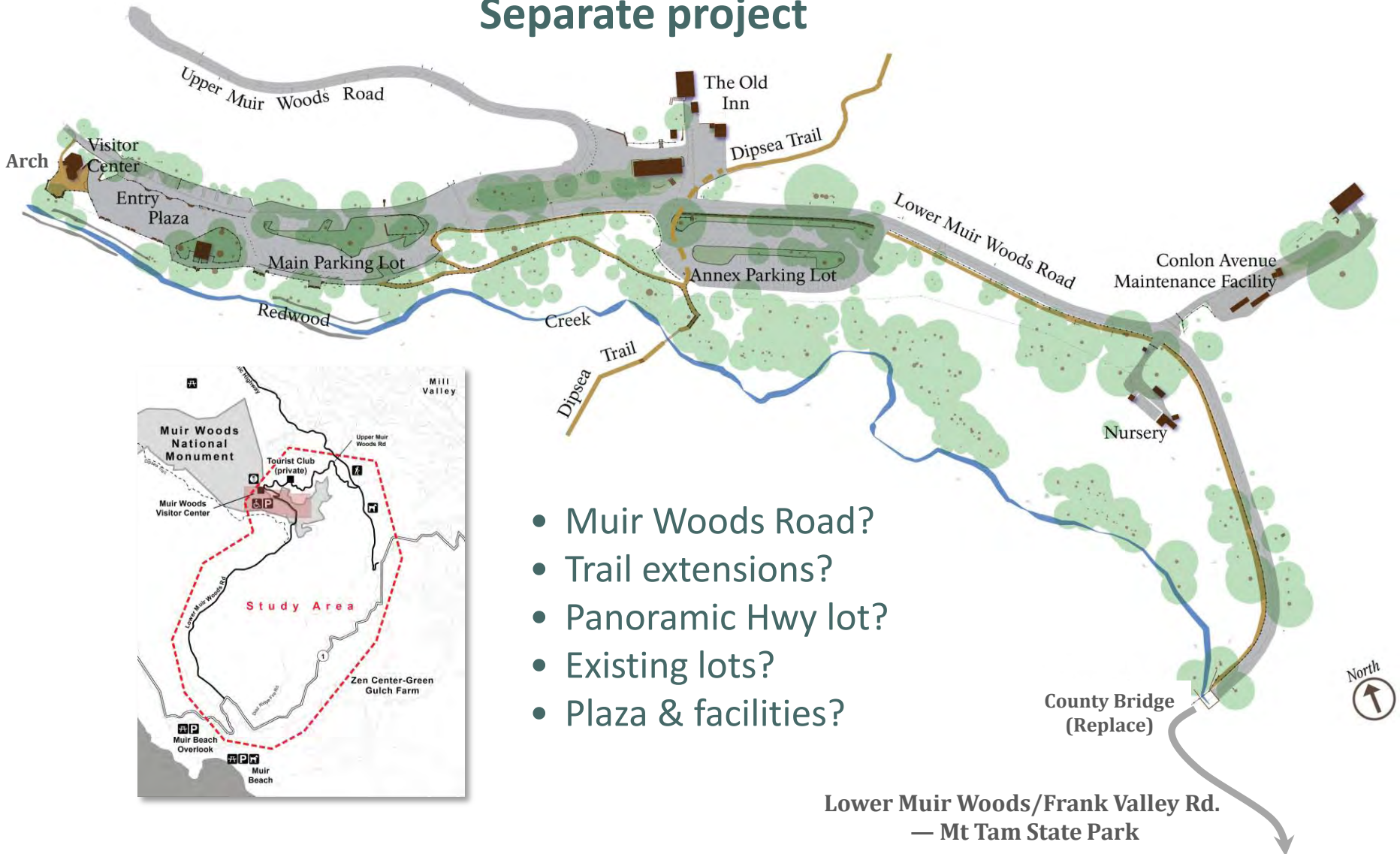

- Muir Woods Road?
- Trail extensions?
- Panoramic Hwy lot?
- Existing lots?
- Plaza & facilities?

Range of Alternatives

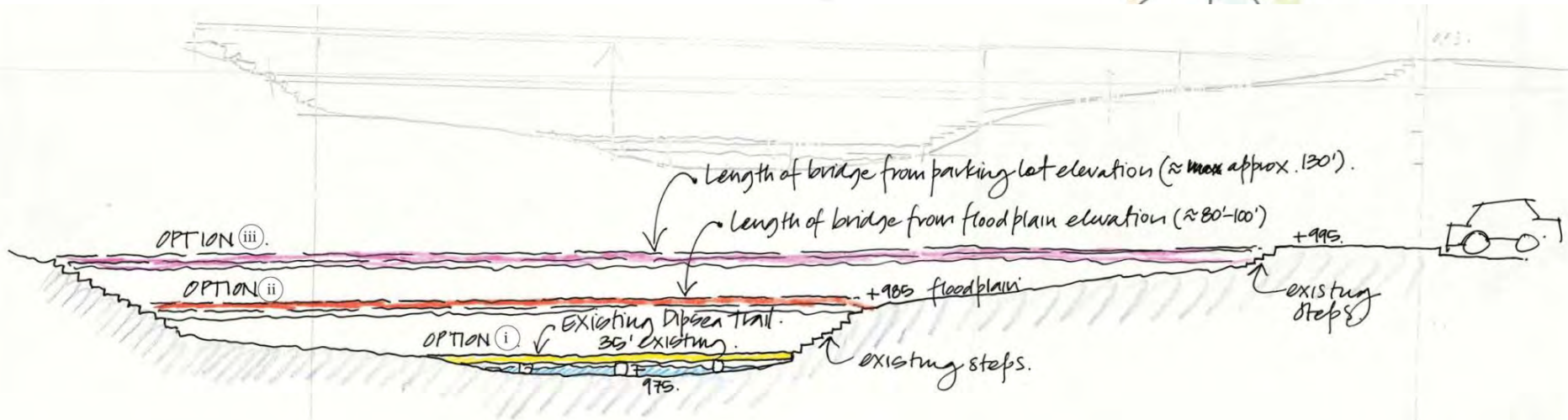
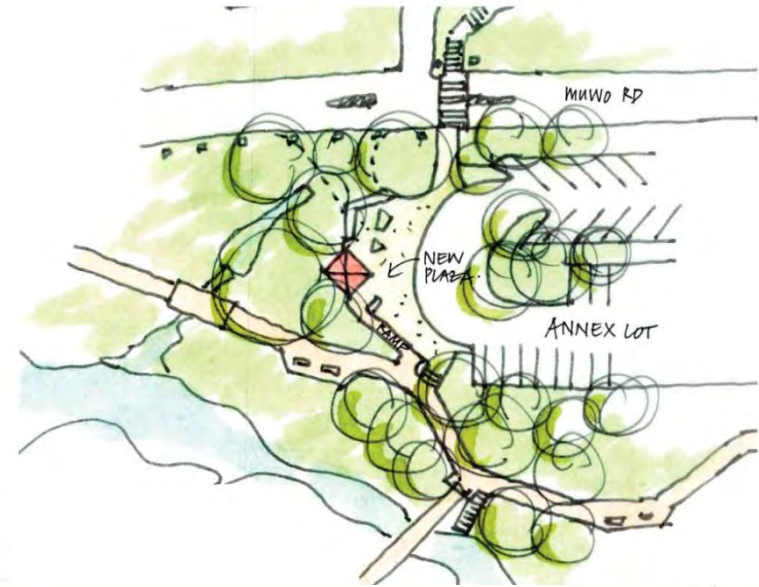
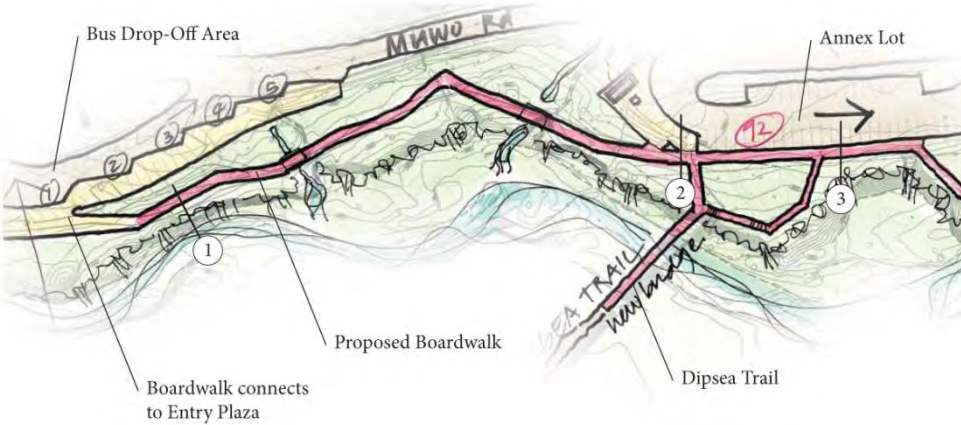

Crossing Redwood Creek

New Lot on Panoramic Highway?

- Replace some parking removed from lower Muir Woods Rd
- Supports shuttle
- Spaces reserved
- Lot managed and gated
- Specific location under study



A lush green forest with tall trees and a wooden bridge. The scene is filled with vibrant green foliage, including ferns and moss-covered ground. Sunlight filters through the dense canopy, creating a dappled light effect. A wooden bridge with railings spans a small stream or path in the foreground. The overall atmosphere is serene and natural.

PART 3

Forward From Here

Please Comment

Flipcharts, cards, online by October 4

(Internal work sessions: October-November)

November 20 Workshop

Summary of comments

Update on parking reservation & shuttle system

Range of alternatives for site improvements

Environmental Documents

Winter-Spring 2014



Clarifying Questions & Answers

Parking Reservation and Shuttle System