

Categorical Exclusion

(Version: FEB06)

Compliance Tracking Number: 2006-033

PEPC Project Number: 14636

A. PROJECT INFORMATION

Title: Arch Rock Well House and Equipment Replacement

Location: El Portal, Mariposa County, California

Project Manager: John Chisum, Facilities Management, Yosemite National Park

B. COMPLIANCE DETERMINATION

This project is an action that has been determined to result in no measurable environmental effects. It is therefore categorically excluded from further National Environmental Policy Act analysis under Categorical Exclusion: DO12 3.4 C (11) - *Installation of wells, comfort stations, and pit or vault toilets in areas of existing use and in developed areas.*

Necessary compliance coordination has been completed regarding the National Historic Preservation Act, the Wilderness Act, the Wild and Scenic Rivers Act, and the Endangered Species Act, as applicable. Environmental impacts will be minor or less when the project is implemented with the conditions stipulated under **Project Mitigations and Conditions** in **Section I** at the end of the attached *Environmental Screening Form*.

Additional supporting information for this determination and the stipulated conditions can be found in the following attachments (when checked):

- ☒ *Cultural Resource Effects Assessment Form (XXX)*
- ☐ *Wilderness Minimum Requirement Analysis*
- ☐ *Wild and Scenic River Section 7 Determination*
- ☐ *Park Management Terms and Conditions*
- ☐ Other:

C. DECISION

On the basis of the environmental impact information in the statutory compliance file, with which I am familiar, I am categorically excluding the described project from further NEPA analysis. No exceptional circumstances or conditions in DO12 3.5 or 3.6 apply and the action is fully described in DO12, Section 3.4.

//Signed Original on File//
Michael J. Tollefson

4/12/06
Date

Original: Statutory Compliance File
cc: Project Proponent

Attachments (2)

The signed original of this document is on file at the Environmental Planning and Compliance Office in Yosemite National Park.



United States Department of the Interior

NATIONAL PARK SERVICE

Yosemite National Park
P.O. Box 577
Yosemite, California 95389

IN REPLY REFER TO:
L7617 (YOSE-PM)

Memorandum

To: John Chisum, Project Manager, Facilities Management, Yosemite National Park

From: Superintendent, Yosemite National Park

Subject: Notice to Proceed, 2006-033 Arch Rock Well House and Equipment Replacement

Your proposed project is an action that has been determined to result in no measurable environmental effects. It is therefore categorically excluded from further National Environmental Policy Act analysis under Categorical Exclusion: DO12 3.4 C (11) - *Installation of wells, comfort stations, and pit or vault toilets in areas of existing use and in developed areas.*

Necessary compliance coordination has been completed regarding the National Historic Preservation Act, the Wilderness Act, the Wild and Scenic Rivers Act, and the Endangered Species Act, as applicable. This project clearance is valid providing that you adhere to the conditions stipulated in the enclosed *Categorical Exclusion Form* and associated documents when implementing this project.

//Signed Original on File//
Michael J. Tollefson

4/12/06
Date

Enclosure (with attachments)

cc: Statutory Compliance File

*The signed original of this document is on file at
the Environmental Planning and Compliance
Office in Yosemite National Park.*

Environmental Screening Form

(Version: FEB06)

Compliance Tracking Number: 2006-033

PEPC Project Number: 14636

A. PROJECT INFORMATION

Title: Arch Rock Well House and Equipment Replacement

Location: El Portal, Mariposa County, California

Project Manager: John Chisum, Facilities Management, Yosemite National Park

B. PROJECT DESCRIPTION AND BACKGROUND

This project will replace the Arch Rock well, well house and well equipment. The existing system was installed in 1981 and is allowing coliform contamination into the system. The system has been shut down because it cannot produce water in conformance with the California Department of Health Services Standards. The new system will include a new 8' by 12' well house and a new well with a 25 gpm pump. Other items include a gravel pack screen, a pitless adaptor, a chlorine pump, a 35 gallon chlorine tank, a flow meter, a hydropneumatic tank and miscellaneous piping. The new well will be located no less than 50 feet from the Merced River.

The new well house footprint will be approximately 46 sq. ft. larger to accommodate the additional filtering systems required by new California Department of Health Services standards. The new footprint will be placed 5' offset from the top-back-of-curb and will be within 30 feet of the existing footprint. The new location will reduce impact of an existing oak tree, avoid interference with the existing well infrastructure and increase the distance from the Merced River from 27 feet to more than 50 feet. The new structure will be approximately the same height as the existing structure and will not exceed 10 feet in height. Furthermore, the final design of the structure will be developed in consultation with the History, Architecture, & Landscapes Branch and accepted by the Division Chief, Resources Management and Science and the Historic Preservation Officer. A re-vegetation plan will be developed in consultation with the Resources Management & Science Division staff and accepted by the Division Chief. The plan will detail all existing plant removals and all new plant types and locations. The new plants will provide screening to reduce the visual impact of the structure.

Table B1 – Background Information

	Yes	No	N/A	Explanation/Notes
1. Did NPS staff conduct a site visit? If yes, list attendees. If no, explain.	<input checked="" type="checkbox"/>	<input type="checkbox"/>	<input type="checkbox"/>	Resources Management and Sciences and Facilities staff.
2a. Is the project providing compliance for an action associated with but not covered by an approved plan? (Identify the plan and provide a section or page citation.); OR	<input type="checkbox"/>	<input checked="" type="checkbox"/>	<input type="checkbox"/>	
2b. Is the project in an approved plan? (Identify the plan and provide a section or page citation.	<input type="checkbox"/>	<input checked="" type="checkbox"/>	<input type="checkbox"/>	
2c. Is the project consistent with that plan?	<input type="checkbox"/>	<input type="checkbox"/>	<input checked="" type="checkbox"/>	
2d. Is the Plan's CE, FONSI, or ROD current?	<input type="checkbox"/>	<input type="checkbox"/>	<input checked="" type="checkbox"/>	
3a. Are there any interested or affected parties?	<input type="checkbox"/>	<input checked="" type="checkbox"/>	<input type="checkbox"/>	
3b. Has a diligent effort been made to communicate with them?	<input type="checkbox"/>			
4a. Are there any affected agencies or tribes?	<input type="checkbox"/>	<input checked="" type="checkbox"/>	<input type="checkbox"/>	
4b. Has consultation been completed?	<input type="checkbox"/>			

Table B2 – Environmental Screening Form Attachments (provide Attachment letter—A, B, etc.)

	Yes	No	N/A	Explanation/Notes
1. Maps: 2 required (vicinity map & site map)	<input checked="" type="checkbox"/>			Vicinity and site map; see Attachment A.
2. Drawings (e.g., design, construction)	<input checked="" type="checkbox"/>	<input type="checkbox"/>	<input type="checkbox"/>	Specifications; see Attachment B.
3. Site Plans	<input type="checkbox"/>	<input checked="" type="checkbox"/>	<input type="checkbox"/>	
4. Photographs	<input checked="" type="checkbox"/>	<input type="checkbox"/>	<input type="checkbox"/>	Existing and proposed site; see Attachment C.
5. Non-NEPA/NHPA Approvals (Explain)	<input type="checkbox"/>	<input type="checkbox"/>	<input checked="" type="checkbox"/>	
6. Other (Explain)	<input type="checkbox"/>	<input type="checkbox"/>	<input checked="" type="checkbox"/>	

C. ASSESSMENT OF POTENTIAL RESOURCE EFFECTS

Are any impacts possible on the following resources?	Yes	No	N/A	Data Needed to Determine/Notes
1. Geologic resources: soils, bedrock, streambeds, etc	<input checked="" type="checkbox"/>	<input type="checkbox"/>	<input type="checkbox"/>	Negligible; the assessment of effect is “No Adverse Effect;” see the attached XXX.
2. From geohazards	<input type="checkbox"/>	<input checked="" type="checkbox"/>	<input type="checkbox"/>	
3. Air quality	<input checked="" type="checkbox"/>	<input type="checkbox"/>	<input type="checkbox"/>	Negligible; temporary exhaust from drilling well.
4. Soundscapes	<input checked="" type="checkbox"/>	<input type="checkbox"/>	<input type="checkbox"/>	Negligible; temporary during construction.
5. Water quality or quantity	<input checked="" type="checkbox"/>	<input type="checkbox"/>	<input type="checkbox"/>	
6. Stream flow characteristics	<input type="checkbox"/>	<input checked="" type="checkbox"/>	<input type="checkbox"/>	
7. Marine or estuarine resources	<input type="checkbox"/>	<input type="checkbox"/>	<input type="checkbox"/>	
8. Floodplains or wetlands	<input type="checkbox"/>	<input type="checkbox"/>	<input checked="" type="checkbox"/>	
9. Land use, including occupancy, income, values, ownership, type of use	<input type="checkbox"/>	<input checked="" type="checkbox"/>	<input type="checkbox"/>	
10. Rare or unusual vegetation – old growth timber, riparian, alpine	<input type="checkbox"/>	<input checked="" type="checkbox"/>	<input type="checkbox"/>	
11. Species of special concern (plant or animal; state or federal listed or proposed for listing) or their habitat	<input type="checkbox"/>	<input checked="" type="checkbox"/>	<input type="checkbox"/>	
12. Unique ecosystems, biosphere reserves, World Heritage Sites	<input type="checkbox"/>	<input checked="" type="checkbox"/>	<input type="checkbox"/>	
13. Unique or important wildlife or wildlife habitat	<input type="checkbox"/>	<input checked="" type="checkbox"/>	<input type="checkbox"/>	
14. Unique or important fish or fish habitat	<input type="checkbox"/>	<input checked="" type="checkbox"/>	<input type="checkbox"/>	
15. Introduce or promote non-native species (plant or animal)	<input type="checkbox"/>	<input checked="" type="checkbox"/>	<input type="checkbox"/>	
16. Recreation resources, including supply, demand, visitation, activities, etc.	<input type="checkbox"/>	<input checked="" type="checkbox"/>	<input type="checkbox"/>	
17. Visitor experience, aesthetic resources	<input type="checkbox"/>	<input checked="" type="checkbox"/>	<input type="checkbox"/>	
18. Cultural resources including cultural landscapes, ethnographic resources	<input type="checkbox"/>	<input checked="" type="checkbox"/>	<input type="checkbox"/>	
19. Socioeconomics, including employment, occupation, income changes, tax base, infrastructure	<input type="checkbox"/>	<input checked="" type="checkbox"/>	<input type="checkbox"/>	
20. Minority and low income populations, ethnography, size, migration patterns, etc.	<input type="checkbox"/>	<input checked="" type="checkbox"/>	<input type="checkbox"/>	
21. Energy resources	<input type="checkbox"/>	<input checked="" type="checkbox"/>	<input type="checkbox"/>	
22. Other agency or tribal land use plans or policies	<input type="checkbox"/>	<input checked="" type="checkbox"/>	<input type="checkbox"/>	
23. Resource, including energy, conservation potential	<input type="checkbox"/>	<input checked="" type="checkbox"/>	<input type="checkbox"/>	
24. Urban quality, gateway communities, etc.	<input type="checkbox"/>	<input checked="" type="checkbox"/>	<input type="checkbox"/>	
25. Long-term management of resources or land/resource productivity	<input type="checkbox"/>	<input checked="" type="checkbox"/>	<input type="checkbox"/>	
26. Other important environment resources (e.g. geothermal, paleontological resources)?	<input type="checkbox"/>	<input checked="" type="checkbox"/>	<input type="checkbox"/>	

Comments, Mitigations and Conditions:

1. None

D. MANDATORY CRITERIA

If implemented, would the proposed action:	Yes	No	N/A	Data Needed to Determine/Notes
1. Have material adverse effects on public health or safety?	<input type="checkbox"/>	<input checked="" type="checkbox"/>	<input type="checkbox"/>	Mitigated; see condition 1.
2. Have adverse effects on such unique characteristics as historic or cultural resources; park, recreation, or refuge lands; wilderness areas; wild or scenic rivers; national natural landmarks; sole or principal drinking water aquifers; prime farmlands; wetlands; floodplains; or ecologically significant or critical areas, including those listed on the National Register of Natural Landmarks?	<input type="checkbox"/>	<input checked="" type="checkbox"/>	<input type="checkbox"/>	Mitigated; the assessment of effect is "No Adverse Effect;" see the attached XXX.
3. Have highly controversial environmental effects?	<input type="checkbox"/>	<input checked="" type="checkbox"/>	<input type="checkbox"/>	
4. Have highly uncertain and potentially significant environmental effects or involve unique or unknown environmental risks?	<input type="checkbox"/>	<input checked="" type="checkbox"/>	<input type="checkbox"/>	
5. Establish a precedent for future action or represent a decision in principle about future actions with potentially significant environmental effects?	<input type="checkbox"/>	<input checked="" type="checkbox"/>	<input type="checkbox"/>	
6. Be directly related to other actions with individually insignificant, but cumulatively significant, environmental effects?	<input type="checkbox"/>	<input checked="" type="checkbox"/>	<input type="checkbox"/>	
7. Have adverse effects on properties listed or eligible for listing on the National Register of Historic Places?	<input type="checkbox"/>	<input checked="" type="checkbox"/>	<input type="checkbox"/>	Mitigated; the assessment of effect is "No Adverse Effect;" see the attached XXX.
8. Have adverse effects on species listed or proposed to be listed on the List of Endangered or Threatened Species or have adverse effects on designated Critical Habitat for these species?	<input type="checkbox"/>	<input checked="" type="checkbox"/>	<input type="checkbox"/>	
9. Require compliance with Executive Order 11988 (Floodplain Management), Executive Order 11990 (Protection of Wetlands), or the Fish and Wildlife Coordination Act?	<input type="checkbox"/>	<input checked="" type="checkbox"/>	<input type="checkbox"/>	
10. Threaten to violate a federal, state, local, or tribal law or requirement imposed for the protection of the environment?	<input type="checkbox"/>	<input checked="" type="checkbox"/>	<input type="checkbox"/>	
11. Involve unresolved conflicts concerning alternative uses of available resources (NEPA sec. 102(2)(E))?	<input type="checkbox"/>	<input checked="" type="checkbox"/>	<input type="checkbox"/>	
12. Have a disproportionate, significant adverse effect on low-income or minority populations (EO 12898)?	<input type="checkbox"/>	<input checked="" type="checkbox"/>	<input type="checkbox"/>	
13. Restrict access to and ceremonial use of Indian sacred sites by Indian religious practitioners or adversely affect the physical integrity of such sacred sites (EO 130007)?	<input type="checkbox"/>	<input checked="" type="checkbox"/>	<input type="checkbox"/>	
14. Contribute to the introduction, continued existence, or spread of federally listed noxious weeds (Federal Noxious Weed Control Act)?	<input type="checkbox"/>	<input checked="" type="checkbox"/>	<input type="checkbox"/>	Mitigated; see condition 2 below.
15. Contribute to the introduction, continued existence, or spread of non-native invasive species or actions that may promote the introduction, growth or expansion of the range of non-native invasive species (EO 13112)?	<input type="checkbox"/>	<input checked="" type="checkbox"/>	<input type="checkbox"/>	Mitigated; see condition 2 below.
16. Require a permit from a federal, state, or local agency to proceed, unless the agency from which the permit is required agrees that a CE is appropriate?	<input type="checkbox"/>	<input checked="" type="checkbox"/>	<input type="checkbox"/>	
17. Have the potential for significant impact as indicated by a federal, state, or local agency or Indian tribe?	<input type="checkbox"/>	<input checked="" type="checkbox"/>	<input type="checkbox"/>	
18. Have the potential to be controversial because of disagreement over possible environmental effects?	<input type="checkbox"/>	<input checked="" type="checkbox"/>	<input type="checkbox"/>	
19. Have the potential to violate the NPS Organic Act by impairing park resources or values?	<input type="checkbox"/>	<input checked="" type="checkbox"/>	<input type="checkbox"/>	

Comments, Mitigations and Conditions:

1. Submit an Accident Prevention Plan to the park Safety Office (379-1079) for review and approval before proceeding with this work. (Safety Office)
2. Ensure that all equipment and materials brought into the park are free of non-native, invasive plants and animals, and noxious weeds. All staff working on site shall be informed of and follow best management practices for preventing the introduction and spread of non-native, invasive species as described in Division 1 specifications, Section 1355. (Environmental Planning & Compliance Office)

E. SPECIAL STATUS SPECIES CHECKLIST

Within the area of potential effect, are there:	Yes	No	N/A	Data Needed to Determine/Notes
1. Listed or proposed threatened or endangered species (Federal or State)?	<input type="checkbox"/>	<input checked="" type="checkbox"/>	<input type="checkbox"/>	
2. Species of special concern (Federal or State)?	<input type="checkbox"/>	<input checked="" type="checkbox"/>	<input type="checkbox"/>	
3. Park rare plants or vegetation?	<input type="checkbox"/>	<input checked="" type="checkbox"/>	<input type="checkbox"/>	
4. Potential habitat for any special-status species listed above?	<input type="checkbox"/>	<input checked="" type="checkbox"/>	<input type="checkbox"/>	
If "yes" to any of the above questions, a Special-Status Species Checklist must be completed and attached.				
Comments, Mitigations and Conditions:				
1. None				

F. NATIONAL HISTORIC PRESERVATION ACT CHECKLIST

Within the area of potential effect:	Yes	No	N/A	Data Needed to Determine/Notes
1. Will there be ground disturbance?	<input checked="" type="checkbox"/>	<input type="checkbox"/>	<input type="checkbox"/>	The assessment of effect is "No Adverse Effect;" see the attached XXX.
2. Are there any archeological sites?	<input type="checkbox"/>	<input checked="" type="checkbox"/>	<input type="checkbox"/>	
3. Are there any Native American Indian traditional cultural resources?	<input type="checkbox"/>	<input checked="" type="checkbox"/>	<input type="checkbox"/>	
4. Is the project within the boundary of an archeological or historic landscape or district?	<input checked="" type="checkbox"/>	<input type="checkbox"/>	<input type="checkbox"/>	Arch Rock Entrance Station Historic Cultural Landscape; the assessment of effect is "No Adverse Effect;" see the attached XXX.
5a. Is there a National Historic Landmark?	<input type="checkbox"/>	<input checked="" type="checkbox"/>	<input type="checkbox"/>	
5b. Is there a structure(s) on the park's <i>List of Classified Structures</i> ?	<input type="checkbox"/>	<input checked="" type="checkbox"/>	<input type="checkbox"/>	
5c. Is there a historic property with a DOE and concurrence by the SHPO or a completed National Register form?	<input type="checkbox"/>	<input checked="" type="checkbox"/>	<input type="checkbox"/>	
5d. Is there a cultural property requiring review under NHPA, Section 106?	<input type="checkbox"/>	<input checked="" type="checkbox"/>	<input type="checkbox"/>	
6. Would there be alteration of a structure or cultural landscape covered by 5a-d, above?	<input checked="" type="checkbox"/>	<input type="checkbox"/>	<input type="checkbox"/>	Arch Rock Entrance Station Historic Cultural Landscape; the assessment of effect is "No Adverse Effect;" see the attached XXX.
If "yes" to any of the above, then an Assessment of Effects form (YOSE-XXX) must be completed and attached.				
Mitigations and Conditions:				
1. None				

G. WILDERNESS ACT CHECKLIST

Is the proposed project:	Yes	No	N/A	Data Needed to Determine/Notes
1. Within designated Wilderness?	<input type="checkbox"/>	<input checked="" type="checkbox"/>	<input type="checkbox"/>	
2. Within a Potential Wilderness Addition?	<input type="checkbox"/>	<input checked="" type="checkbox"/>	<input type="checkbox"/>	
If "yes" to either of the above, then a Wilderness Minimum Requirements Analysis must be completed and attached.				
Mitigations and Conditions:				
1. None				

H. WILD AND SCENIC RIVERS ACT CHECKLIST

Does the proposed project:	Yes	No	N/A	Data Needed to Determine/Notes
1. Fall within a wild and scenic river corridor? If "yes", name the river(s)	<input checked="" type="checkbox"/>	<input type="checkbox"/>	<input type="checkbox"/>	Merced River
2. Fall within the bed and banks AND affect the free-flow of the river?	<input type="checkbox"/>	<input checked="" type="checkbox"/>	<input type="checkbox"/>	
3. Potentially affect water quality of the area?	<input type="checkbox"/>	<input checked="" type="checkbox"/>	<input type="checkbox"/>	
4. Remain consistent with its river segment classification?	<input checked="" type="checkbox"/>	<input type="checkbox"/>	<input type="checkbox"/>	Arch Rock Well House and Equipment Replacement is consistent with its river segment classification of "Scenic."
5. Protect and enhance river ORVs?	<input checked="" type="checkbox"/>	<input type="checkbox"/>	<input type="checkbox"/>	Arch Rock Well House and Equipment Replacement protects and enhances river ORVs.
6a. Fall within the River Protection Overlay?	<input type="checkbox"/>	<input checked="" type="checkbox"/>	<input type="checkbox"/>	
6b. If "yes", is it consistent with conditions of the River Protection Overlay?	<input type="checkbox"/>	<input type="checkbox"/>	<input type="checkbox"/>	
7. Remain consistent with the area's Management Zoning?	<input checked="" type="checkbox"/>	<input type="checkbox"/>	<input type="checkbox"/>	Arch Rock Well House and Equipment Replacement is consistent with the area's management zoning of "3C - Park Operations and Administration."
8a. Fall on a tributary of a Wild and Scenic River?	<input type="checkbox"/>	<input checked="" type="checkbox"/>	<input type="checkbox"/>	
8b. If 9a is "yes", will the project affect the Wild and Scenic River corridor?	<input type="checkbox"/>	<input type="checkbox"/>	<input checked="" type="checkbox"/>	
8c. If 9a is "yes", will the project unreasonably diminish scenic, recreational, or fish and wildlife values?	<input type="checkbox"/>	<input type="checkbox"/>	<input checked="" type="checkbox"/>	
If "yes" to questions 2, 9b, or 9c, then a WSRA Section 7 determination must be completed and attached.				

Mitigations and Conditions:

1. None

I. NEPA Analysis and Approval Conditions

When implemented as detailed in the project description and following all Project Mitigations and Conditions listed below, this project meets the terms and conditions of a categorical exclusion to NEPA.

Applicable Categorical Exclusion:

DO12 C (11) - Installation of wells, comfort stations, and pit or vault toilets in areas of existing use and in developed areas.

Project Mitigations and Conditions:

1. Submit an Accident Prevention Plan to the park Safety Office (379-1079) for review and approval before proceeding with this work. (Safety Office)
2. Ensure that all equipment and materials brought into the park are free of non-native, invasive plants and animals, and noxious weeds. All staff working on site shall be informed of and follow best management practices for preventing the introduction and spread of non-native, invasive species as described in Division 1 specifications, Section 1355. (Environmental Planning & Compliance Office)

This project has been reviewed in accordance with the above criteria and it has been determined that the project will result in no or minimal environmental effects. Therefore, it is categorically excluded from further environmental review required under the National Environmental Policy Act. Additionally, the necessary compliance coordination has been completed with regard to the National Historic Preservation Act, the Wilderness Act, the Wild and Scenic Rivers Act, and the Endangered Species Act.

Renea Kennec //Signed Original on File// **4/10/06**
Compliance Specialist **Date**

GWColliver //Signed Original on File// **4/10/06**
Compliance Program Manager **Date**

Bill Delaney //Signed Original on File// **4/10/06**
Chief, Project Management **Date**

The signed original of this document is on file at the Environmental Planning and Compliance Office in Yosemite National Park.

Attachment A

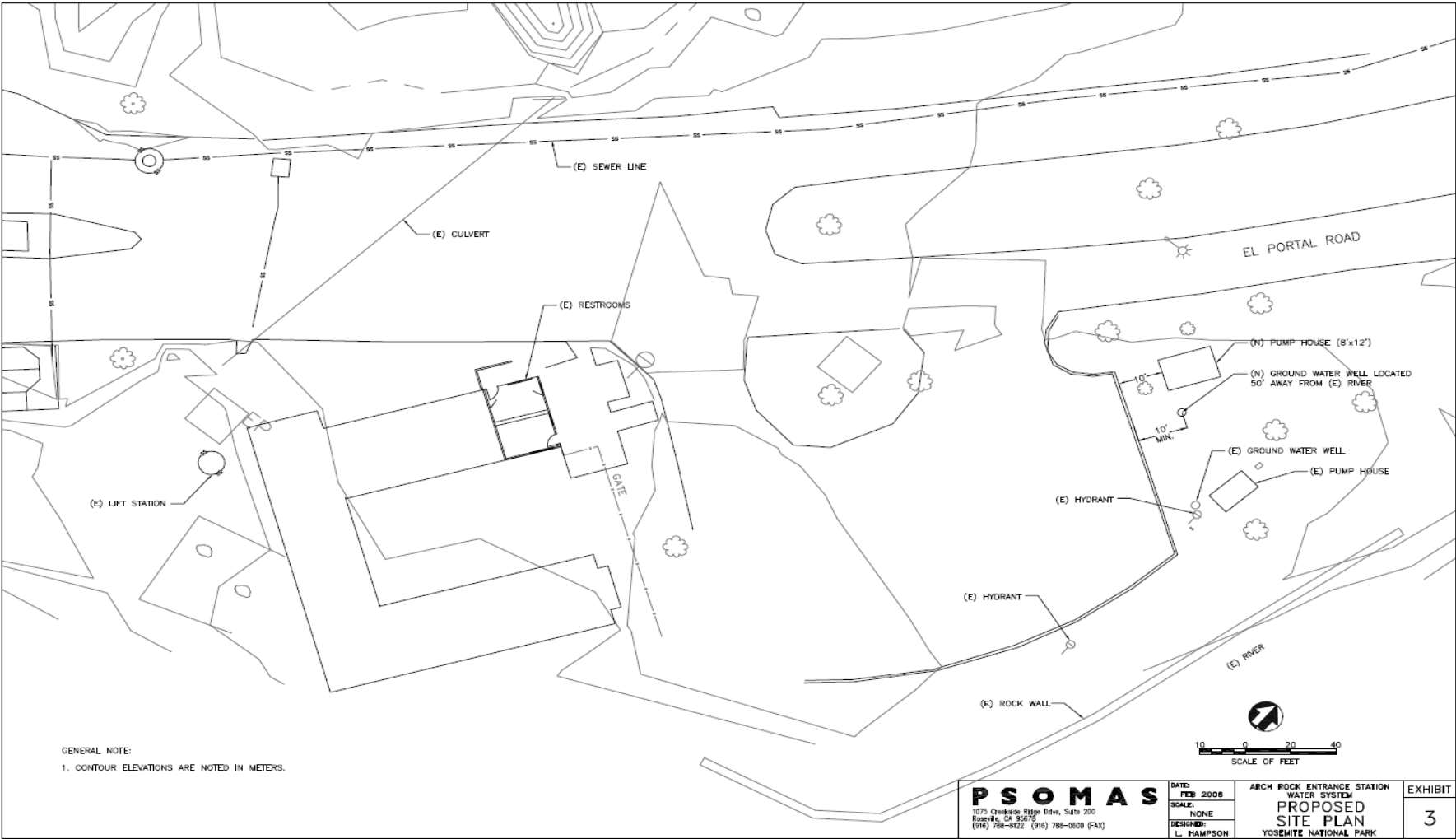

Attachment B

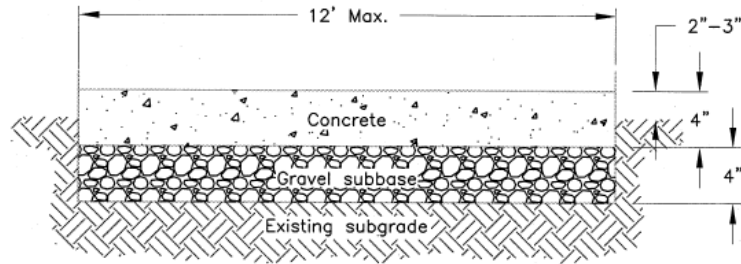

4" CONCRETE PAD DETAIL
TYPICAL SECTION
(N.T.S.)

CONSTRUCTION SPECIFICATIONS AND NOTES

- Concrete shall meet the provisions of ASTM C-94, Ready Mix Concrete. Portland cement conforming to ASTM C-150, Type I, IA or II, IIA shall be used. If Type I or II is used an added air entrainment agent, conforming to ASTM C-260 shall be used. Concrete shall have a minimum 28-day compressive strength of 4000 psi (Class 4000). The slump shall be (4) inches \pm (1) inch. The air entrainment shall be 4%-6%.
- Subbase material shall consist of a well-graded gravel material with 100% passing a (3) inch sieve and less than 8% passing a No. 200 sieve. Compaction of each layer of subbase course shall be by (2) passes over the entire surface layer with a hand directed mechanically powered vibrating plate compactor or vibratory roller or by an approved equivalent method.
- The subgrade shall be well drained and provide a firm uniform support for the subbase material. All sod and other organic matter shall be stripped from the subgrade.
- Expansion joints filled with (1/2) inch asphalt treated fiber board shall be placed along existing structures such as buildings, concrete tanks or concrete slabs unless otherwise indicated.
- In areas not subject to cattle or vehicular traffic, the concrete surface shall be provided with a broom finish. In areas subject to cattle or vehicular traffic, concrete shall be provided with a grooved finish. Grooving shall consist of (3-5) inches center-to-center (c-c) spacing of (1/2) inch - (3/4) inch wide by (1/4) inch to (3/8) inch deep grooves.
- In all cases concrete shall be cured by keeping the surface cool and moist for (7) days after placement. In lieu of application of moisture, concrete, except at construction joints, shall be coated with a curing compound. The compound shall be sprayed on moist concrete surfaces as soon as free water has disappeared. The curing compound shall conform to ASTM C-309 and shall be Type 2, white pigmented. Curing compound shall be applied in a uniform layer over all surfaces at a rate of not less than (1) gallon per (150) square feet.
- In hot weather, the concrete temperature shall be maintained below 85°F during mixing, conveying and placement. Concrete must then be kept moist at all times for at least (7) days or until curing compound is applied as in previous paragraph.
- In cold weather concrete shall not be mixed or placed when daily atmospheric temperature is less than 40°F unless facilities are provided to prevent concrete from freezing. The use of accelerators or antifreeze compounds will not be permitted. The temperature of the concrete at the time of placing shall not be less than 50°F and shall be maintained at temperatures not less than 40°F for a period of (3) days. Thermal blankets if used shall have sufficient R-value to protect concrete for the expected temperatures.

TITLE OF SHEET		DRAWING NO.	
WELL PAD DETAIL		_____	
ARCH ROCK ENTRANCE STATION YOSEMITE NATIONAL PARK		PKG. NO.	SHEET
		_____	<input type="checkbox"/>
		_____	OF _____

Attachment C



Preservation Assessment Form (YOSE XXX)

(Version: FEB06)

Compliance Tracking Number: 2006-033

PEPC Project Number: 14636

A. DESCRIPTION OF UNDERTAKING

Title: Arch Rock Well House and Equipment Replacement

NPS Project Manager: Facilities Management, John Chisum

Project Location and Area of Potential Effect:

Mariposa County, California.

Arch Rock Entrance , Yosemite National Park

Project Description:

This project will replace the Arch Rock well, well house and well equipment. The existing system was installed in 1981 and is allowing coliform contamination into the system. The system has been shut down because it cannot produce water in conformance with the California Department of Health Services Standards. The new system will include a new 8' by 12' well house and a new well with a 25 gpm pump. Other items include a gravel pack screen, a pitless adaptor, a chlorine pump, a 35 gallon chlorine tank, a flow meter, a hydropneumatic tank and miscellaneous piping. The new well will be located no less than 50 feet from the Merced River.

The new well house footprint will be approximately 46 sq. ft. larger to accommodate the additional filtering systems required by new California Department of Health Services standards. The new footprint will be placed 5' offset from the top-back-of-curb and will be within 30 feet of the existing footprint. The new location will reduce impact of an existing oak tree, avoid interference with the existing well infrastructure and increase the distance from the Merced River from 27 feet to more than 50 feet. The new structure will be approximately the same height as the existing structure and will not exceed 10 feet in height. Furthermore, the final design of the structure will be developed in consultation with the History, Architecture, & Landscapes Branch and accepted by the Division Chief, Resources Management and Science and the Historic Preservation Officer. A re-vegetation plan will be developed in consultation with the Resources Management & Science Division staff and accepted by the Division Chief. The plan will detail all existing plant removals and all new plant types and locations. The new plants will provide screening to reduce the visual impact of the structure.

1. Attached Sensitive Information**	Yes	No	Explanation/Source/Notes
a. Maps	<input checked="" type="checkbox"/>	<input type="checkbox"/>	CR GIS
b. Drawings	<input type="checkbox"/>	<input type="checkbox"/>	
c. Site Plans	<input type="checkbox"/>	<input type="checkbox"/>	
d. Photographs	<input type="checkbox"/>	<input type="checkbox"/>	
e. Sample	<input type="checkbox"/>	<input type="checkbox"/>	
f. List of Materials	<input type="checkbox"/>	<input type="checkbox"/>	
g. Other (Explain)	<input type="checkbox"/>	<input type="checkbox"/>	

** Sensitive documents not for duplication or distribution beyond park management, subject matter experts, and the project statutory compliance file.

B. DESCRIPTION OF EFFECTS

	Yes	No	N/A	Explanation/Notes
1. Has the Area of Potential Effect been surveyed to identify historic properties? If Yes, provide reference for the Survey (s).	<input checked="" type="checkbox"/>	<input type="checkbox"/>	<input type="checkbox"/>	YOSE1997B Arch Rock Retaining Walls and Entrance Sign nomination form
a. Would the proposed action affect a known historic property?	<input type="checkbox"/>	<input type="checkbox"/>	<input type="checkbox"/>	Arch Rock Entrance Station Historic Cultural Landscape (725330)
2. List all Historic Properties in the Area of Potential Effect:	Affected? Yes	No		Explanation/Notes
a. CA-MRP-1704H	<input type="checkbox"/>	<input checked="" type="checkbox"/>		Outside project area
b. CA-MRP-1705H	<input checked="" type="checkbox"/>	<input type="checkbox"/>		
c.	<input type="checkbox"/>	<input type="checkbox"/>		
3. List resources in the Area of Potential Effect to which American Indians attach cultural and religious significance:	Affected? Yes	No		Explanation/Notes
a. Traditional resource area	<input type="checkbox"/>	<input type="checkbox"/>		unknown resources
b.	<input type="checkbox"/>	<input type="checkbox"/>		
c.	<input type="checkbox"/>	<input type="checkbox"/>		
4. The proposed action will:	Yes	No	N/A	Explanation/Note
• Destroy, remove, or alter features or elements from a historic structure	<input type="checkbox"/>	<input checked="" type="checkbox"/>	<input type="checkbox"/>	
• Replace historic features/elements in kind	<input type="checkbox"/>	<input checked="" type="checkbox"/>	<input type="checkbox"/>	
• Add nonhistoric features/elements to a historic structure	<input type="checkbox"/>	<input checked="" type="checkbox"/>	<input type="checkbox"/>	
• Alter or remove features/elements of a historic setting or environment (including terrain)	<input checked="" type="checkbox"/>	<input type="checkbox"/>	<input type="checkbox"/>	
• Add nonhistoric features/elements (including visual, audible, or atmospheric) to a historic setting or cultural landscape	<input checked="" type="checkbox"/>	<input type="checkbox"/>	<input type="checkbox"/>	
• Disturb, destroy, or make archeological resources inaccessible, or alter associated terrain	<input checked="" type="checkbox"/>	<input type="checkbox"/>	<input type="checkbox"/>	
• Disturb, destroy, or make ethnographic resources inaccessible, or alter associated terrain	<input checked="" type="checkbox"/>	<input type="checkbox"/>	<input type="checkbox"/>	resources unknown
• Begin or contribute to the deterioration of historic fabric, terrain, setting, landscape elements, or archeological or ethnographic resources	<input type="checkbox"/>	<input checked="" type="checkbox"/>	<input type="checkbox"/>	
• Involve a real property transaction affecting historic cultural properties (i.e., the exchange, sale, or lease of land or structures)	<input checked="" type="checkbox"/>	<input type="checkbox"/>	<input type="checkbox"/>	
• Potentially affect presently unidentified historic resources	<input checked="" type="checkbox"/>	<input type="checkbox"/>	<input type="checkbox"/>	
• Other	<input checked="" type="checkbox"/>	<input type="checkbox"/>	<input type="checkbox"/>	

5. Describe any measures that are incorporated as part of this project that will be taken to prevent or minimize loss or impairment of prehistoric or historic fabric, setting, integrity, or data:

- a. The final design of the structure will be developed in consultation with the History, Architecture, & Landscapes Branch and accepted by the Division Chief, Resources Management and Science and accepted by the Historic Preservation Officer.
- b. A re-vegetation plan will be developed in consultation with the Resources Management & Science Division staff and accepted by the Division Chief. The plan will detail all existing plant removals and all new plant types and locations. The new plants will provide screening to reduce the visual of the structure.

Checklist prepared by: Jeannette Simons

Date: 4/17/06

Title: Historic Preservation Officer

C. SPECIALIST SECTION

Specialists: Your comments here (or attached) show that you have reviewed this proposal for conformity with requirements of *National Historic Preservation Act, Section 106*; with the 1995 *Service-wide Programmatic Agreement* (if applicable); with applicable parts of the *Secretary of the Interior's Standards and Guidelines for Archeology and Historic Preservation*; with the *NPS Management Policies* and *Cultural Resource Management Guideline*; and have given your best professional advice about this project and the issues relevant to the Section 106 process, including identification and evaluation of historic properties and further consultation needs.

Archeologist

Name: **Laura Kirn**

Date: 3/29/06

Comments:

Ground Disturbance Involved Yes: ☒ No: ☐

Assessment of Effect: **"No Effect"**

Recommended Conditions:

Signature of Archeologist: //Signed Original on File//

Cultural Anthropologist

Name: **Sonny Montague**

Date: 3/30/06

Comments:

Assessment of Effect:

Recommended Conditions:

Signature of Cultural Anthropologist: _____

Curator

Name: **Jonathan Bayless**

Date:

Comments:

Assessment of Effect:

Recommended Conditions:

Signature of Curator: _____

Historian

Name: **Charles Palmer**

Date: 3/29/06

Comments:

Assessment of Effect: **"No Adverse Effect"**

Recommended Conditions:

Signature of Historian: //Signed Original on File//

Historic Architect

Name: **Sueanne Brown**

Date: 3/29/06

Comments: The design of the structure is critical in minimizing the effect. As long as HAL staff reviews design as stated in the revised PEPC, there should be no adverse effect.

Assessment of Effect: **"No Adverse Effect"**

Recommended Conditions:

Signature of Historic Architect: //Signed Original on File//

Historic Landscape Architect

Name: **Steven Torgerson**

Date: 3/29/06

Comments:

Assessment of Effect: **"No Adverse Effect"**

Recommended Conditions:

Signature of Historic Landscape Architect: //Signed Original on File//

Preservation Specialist

Name: **Doug Martin**

Date:

Comments:

Assessment of Effect:

Recommended Conditions: Recommended Conditions

Signature of Preservation Specialist: _____

Native American Liaison

Name: **Jeannette Simons**

Date: 4/5/06

Comments:

Assessment of Effect: "**No Effect**"

Recommended Conditions:

Signature of Native American Liaison: *//Signed Original on File//*

<Enter Specialist Title>

Name:

Date:

Comments:

Assessment of Effect:

Recommended Conditions:

Signature of <Enter Specialist Title>: _____

**D. RESOURCES MANAGEMENT AND SCIENCE DIVISION AND PARK 106
COORDINATOR REVIEWS AND RECOMMENDATIONS**

- 1. Review by specialists:** The appropriate subject-matter experts have reviewed the project and entered their comments and recommendations in Section C, above.

The foregoing assessment is adequate: the proposed action is consistent with all applicable NPS management policies, standards, guidelines, or US DOI standards and guidelines, Rehabilitation of Historic Buildings, or others, and incorporates measures to avoid Adverse Effects.

Reviewed and Accepted by:

Signature: Niki Stephanie Nicholas //Signed Original on File// **Date:** 4/4/06
Chief of Resources Management & Science Division

2. Assessment of Effects: No Adverse Effect

- 3. Compliance Requirements:** The following is the park's assessment of Section 106 process needs and requirements for this undertaking.

☐ **Standard 36 CFR Part 800 Consultation**

Consultation under 36 CFR is needed subsequent to the preparation of this form and its review by appropriate historic resource management advisors.

☒ **Undertaking related to the 1995 NPS Programmatic Agreement**

The above action meets all conditions for a programmatic exclusion under Stipulation IV. A of the 1995 NPS programmatic agreement, and is listed in Stipulation IV. B, as:

10. Health and Safety Activities (such as radon mitigation, and removal of asbestos, lead paint, and buried oil tanks).

☐ **Plan-Related Undertaking**

Consultation and review of the proposed undertaking were completed in the context of a plan review process, in accordance with the 1995 NPS programmatic agreement and 36 CFR Part 800.

☐ **Undertaking Related to Another Agreement**

The proposed undertaking is covered for Section 106 purposes under a document such as a statewide agreement written in accordance with 37 CFR Part 800.7 or counterpart regulations.

Agreement: <Enter Agreement Information>

☐ **Flood-Recovery Related Undertaking**

The proposed undertaking is covered for Section 106 purposes under the letter-based agreement between the NPS, the State Historic Preservation Office, and the Council for Historic Preservation for "Highwater 97" flood repair and recovery

☒ **Undertaking Related to the 1999 Yosemite Programmatic Agreement**

The proposed undertaking is covered for Section 106 purposes under the park's 1999 programmatic agreement for planning, design, construction, operations and maintenance; the undertaking meets the stipulations identified in Article VII.C.2.

4. Project Stipulations and Conditions

Following are listed any stipulations or conditions necessary to ensure that the assessment of effects above is consistent with 36 CFR 800 criteria of effect or to mitigate potential adverse effects:

- a. NONE

Recommended by Park Section 106 Coordinator:

Name: **Jeannette Simons**

Title: **Historic Preservation Officer**

Signature: //Signed Original on File// Date: 3/5/06

E. SUPERINTENDENT'S APPROVAL

The proposed work conforms to NPS Management Policies and NPS-28 and I approve the recommendations, stipulations, and conditions noted in Section B of this form.

Signature of Superintendent: **MJ Tollefson** //Signed Original on File//

Date: 4/12/06

*The signed original of this document is on file at
the Environmental Planning and Compliance
Office in Yosemite National Park.*