



National World War I Memorial

U.S. World War I Centennial Commission
UU+ Studio | Forge Landscape Architecture
GWWO Architects

U.S. Commission of Fine Arts
Presentation October 20, 2016

Site Context

- symbolic and physical connection between White House and Capitol
- junction between monumental core to the south and west and the residential/commercial life to the north and east
- serves both commemorative and urban park functions
- role in revitalizing the public realm, supporting continuity and maintaining vistas along the Avenue

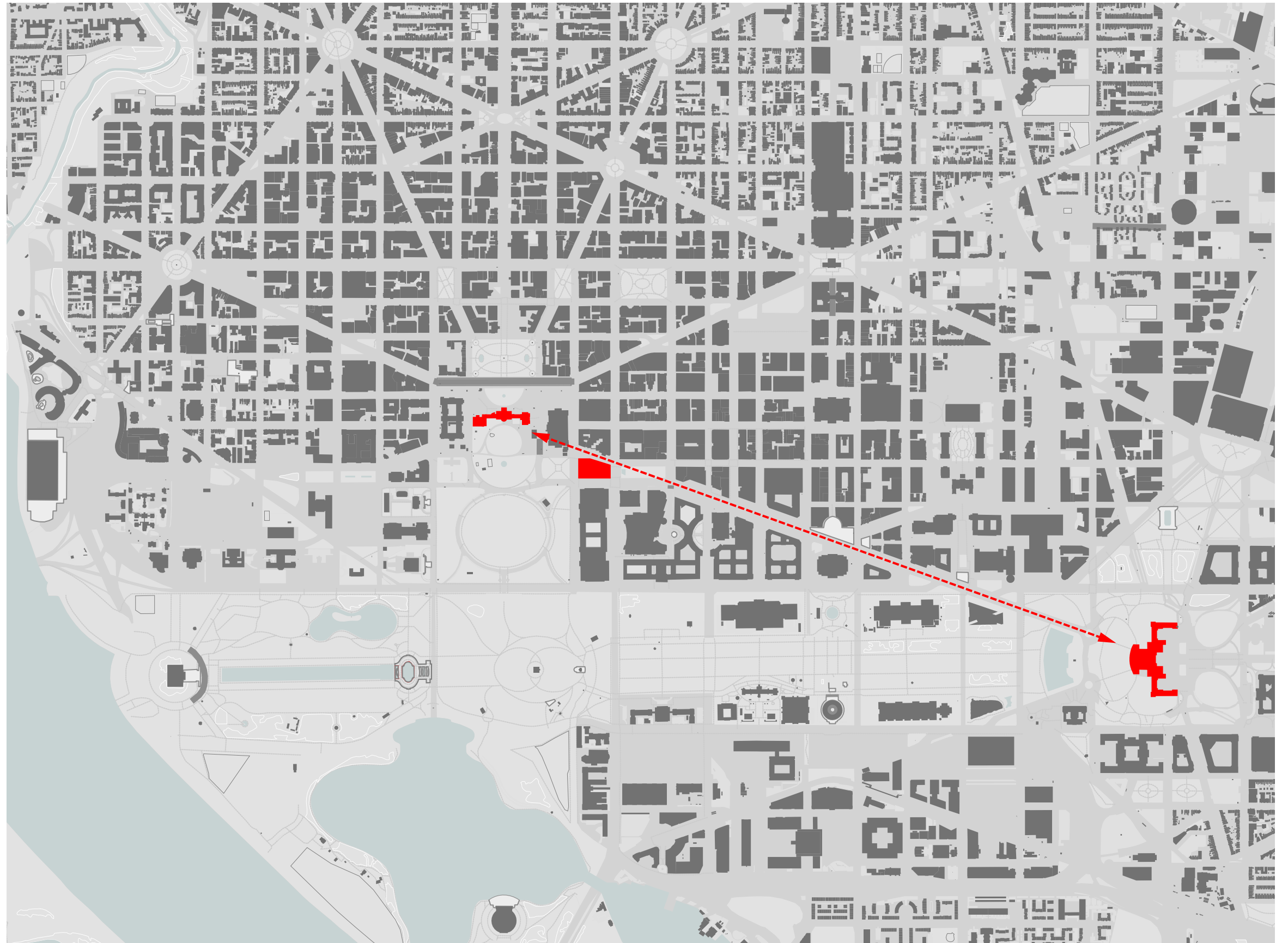

Pennsylvania Avenue National Historic Site

- Pershing Memorial is a contributing element to PANHS
- Pershing Park (non-contributing) situated at western end of PANHS

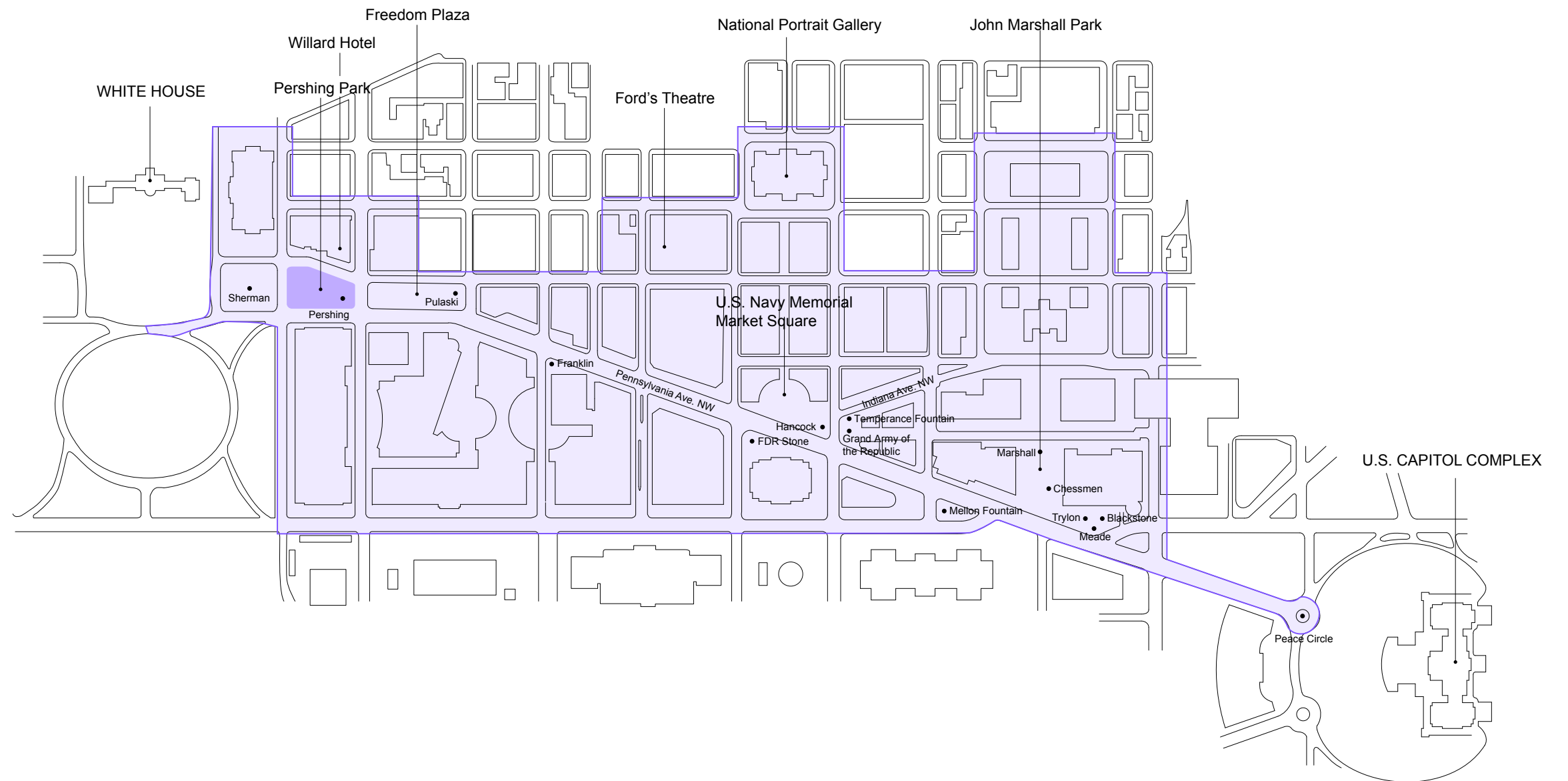

Pennsylvania Avenue Viewshed

- Existing streetscape design maintains Pennsylvania Avenue viewshed



Pershing Park Through Time

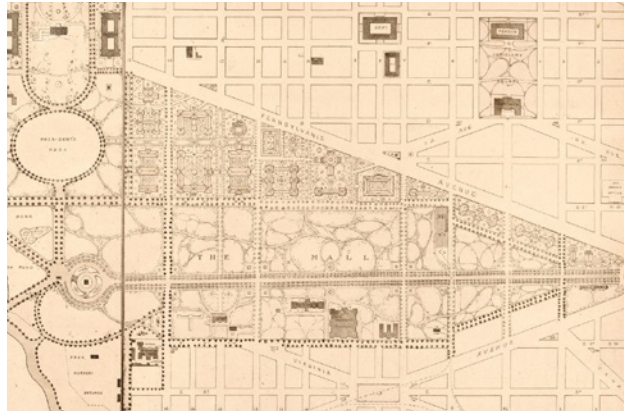

- radical change from the 1791 L'Enfant plan to today
- fully built out site per Hopkins Plan of 1887
- witness to Pennsylvania Avenue parades and ceremonies on the north
- open green space in 1939; temporary building 1942-55
- approved by NCPC as site for General Pershing Memorial in 1957
- Beautification Task Force plantings 1966-68
- proposed redesign by PADC in 1974; generous ceremonial streetscape proposed along Pennsylvania Ave. North



1865 Lincoln Funeral



1902



1910



1913



1917 Wilson Inauguration



1920



1925



1953 Eisenhower Inauguration



1958



1963 Kennedy Funeral



1966

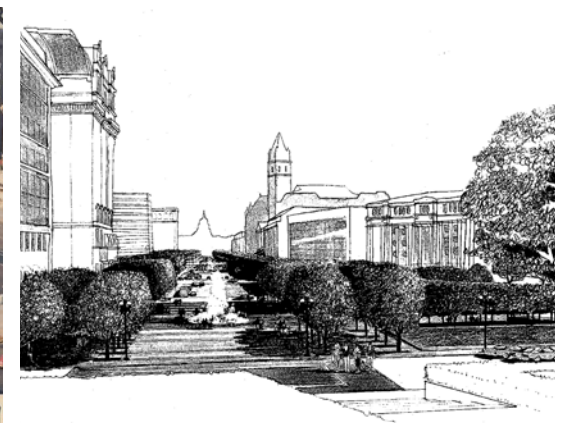

1974 PADC Rendering

Streets and Sidewalks

- sidewalk areas play critical role in activating urban life
- sidewalks are significantly narrower than adjacent parcels
- reduced traffic on Pennsylvania Ave. N/S
- opportunity to enhance N/S sidewalks

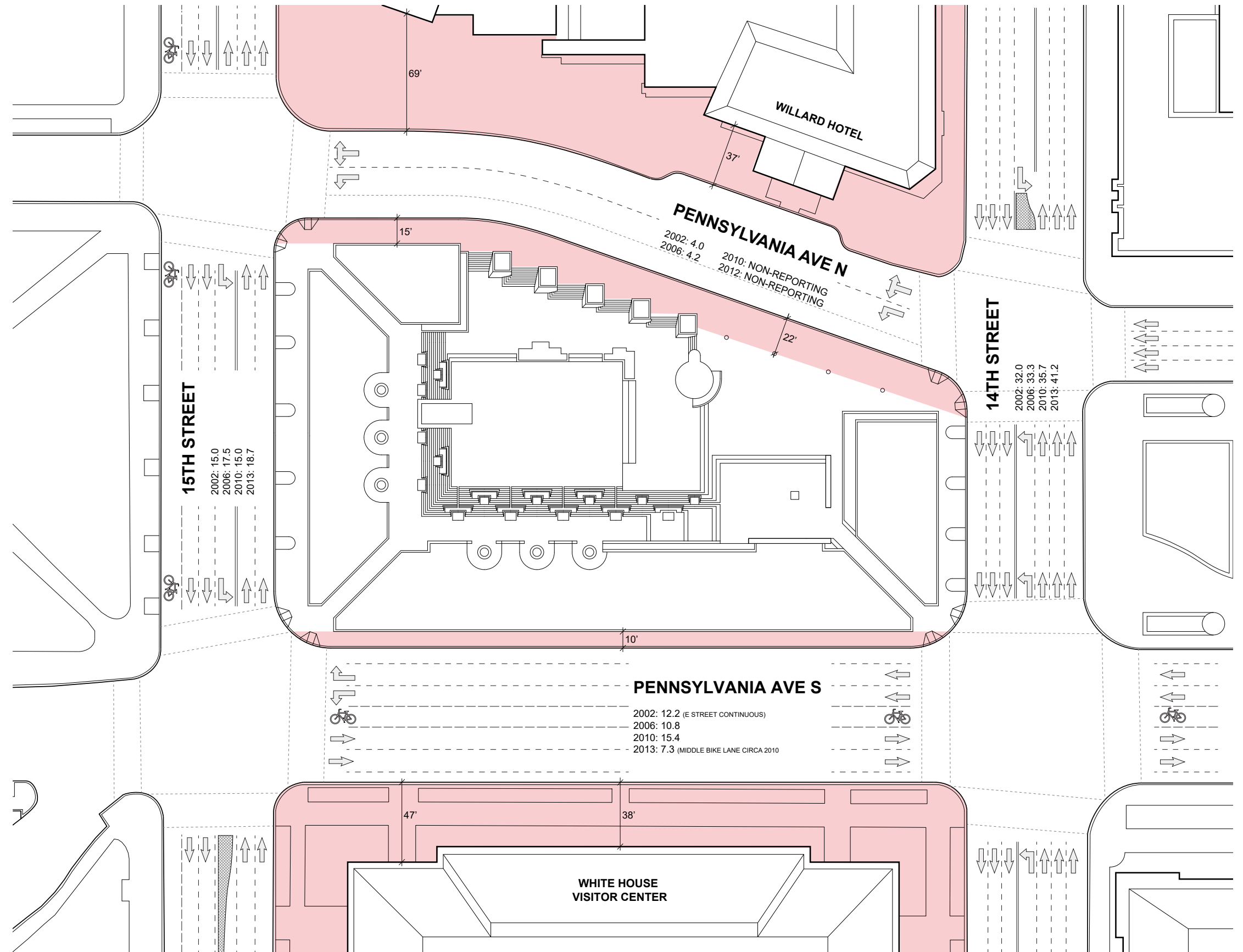

Existing Site Conditions

- designed by landscape architect M. Paul Friedberg and architect Wallace K. Harrison
- opened to the public in 1981
- planting redesigned by Oehme van Sweden in 1981 after opening
- closure of central water feature, concessions kiosk, underground restrooms, fountain, and ice rink in 2006
- main opportunities for enhancement:
 - central oasis water feature
 - accessibility
 - visibility
 - Pershing Memorial



Pershing Park 2015

Central Oasis

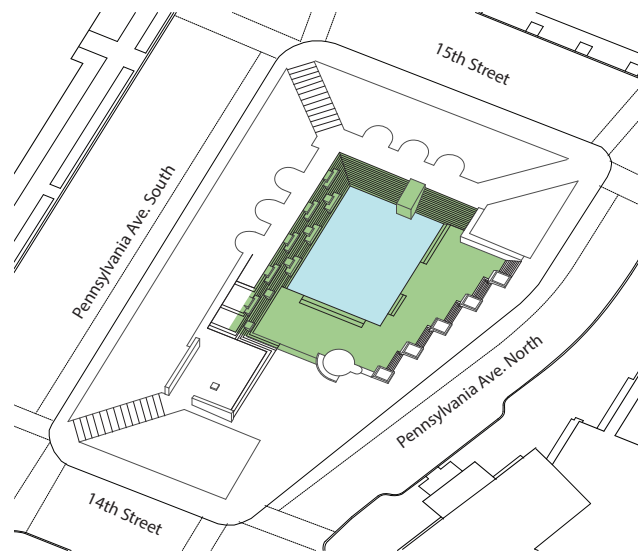

- park designed around central water feature (7575 SF), key feature of urban oasis
- fountain and water basin inoperable for many years
- opportunity to retain concept of the oasis, reintroducing water in a sustainable form



Accessibility

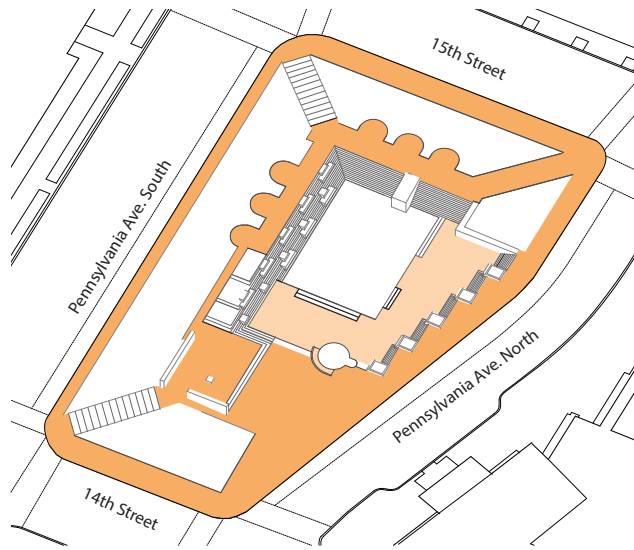

- universal accessibility constrained by stairs and stepped platforms
- ramps require circuitous route or passage along the margins
- accessible entry gained only at northwest corner and mid-block along Pennsylvania Avenue North



Visibility

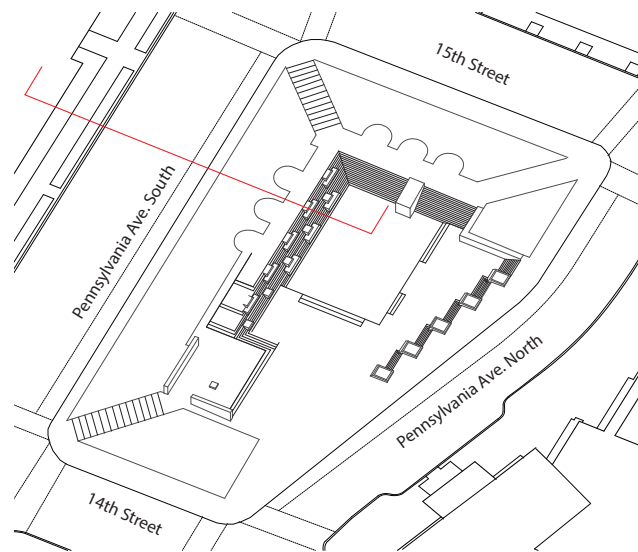

- sense of enclosure provided by berms shelters people from the noise of city streets
- excessive height makes the park invisible from the street and creates safety concerns
- opportunity to enhance visibility while maintaining sense of enclosure by lowering the berms slightly



N/S Section: Limited Visibility into the Park



View from Pennsylvania Avenue South, looking northeast

Pershing Memorial

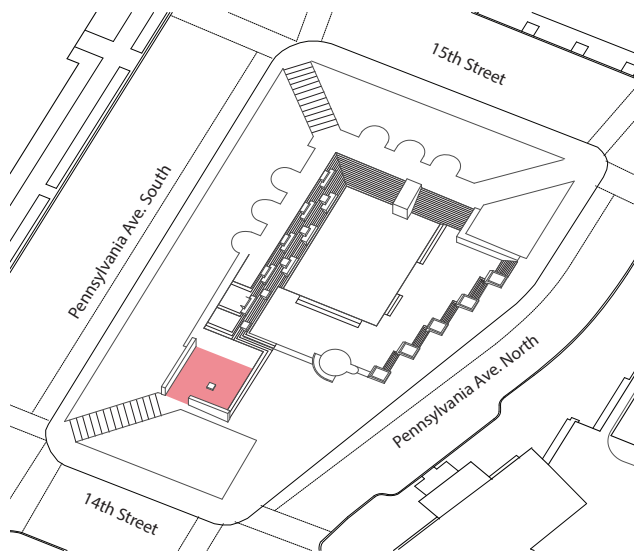

- contributing element within Pennsylvania Avenue National Historic Site
- walls define memorial precinct (3400 SF)
- does not commemorate greater sacrifice of all WWI servicemen and women
- not well integrated into site
- inscriptions on walls lack legibility

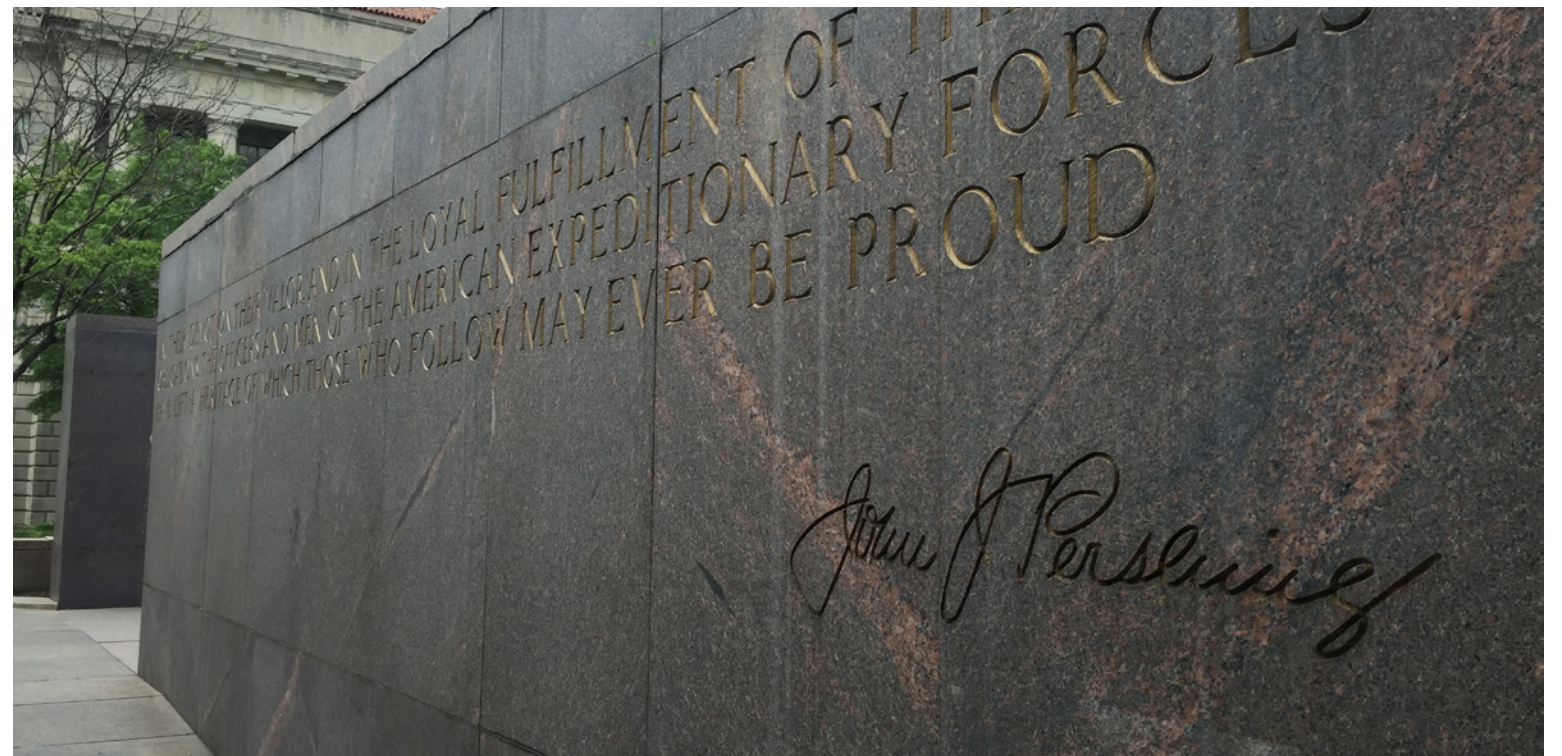

Competition Design

- integration of memorial and park
- raised central space surrounded by walls commemorates WWI through figurative sculpture and narrative
- design lowers visual barriers, linking memorial to General Sherman on the West and Freedom Plaza on the East





Competition Proposal: E/W section looking north



Competition Proposal: Wall of Remembrance

Proposed Design

- rehabilitates Pershing Park to serve as a national World War I Memorial
- integrates new commemorative elements while maintaining and enhancing character defining features of existing park
 - spatial organization
 - views and vistas
 - Pershing Memorial
 - water feature
 - vegetation
 - amphitheater seating areas with planters
 - alcoves along elevated walk with semicircular seating



Proposed Design

- fulfills Congressional mandate to enhance Pershing Park as a National World War I Memorial
- reestablishes oasis in the city
- enhances visual access
- addresses accessibility and safety
- enhances relationship with urban context
- enhances physical connections between commercial uses and across Pennsylvania Avenue North



Features Retained

- water feature rehabilitated, reduced in size, accommodating seasonal use
- earthen berms retained in existing location and orientation with additional access point through southern berm, more generous corner entries, widening of Pennsylvania Ave. South sidewalk
- trees retained across the site
- planters and stairs on north side of central space shifted south
- stair retained on south side of central space
- additional seating provided on south stair and along Pennsylvania Avenue North
- semi-circular seating retained on west side of central space
- Pershing Memorial retained in current location

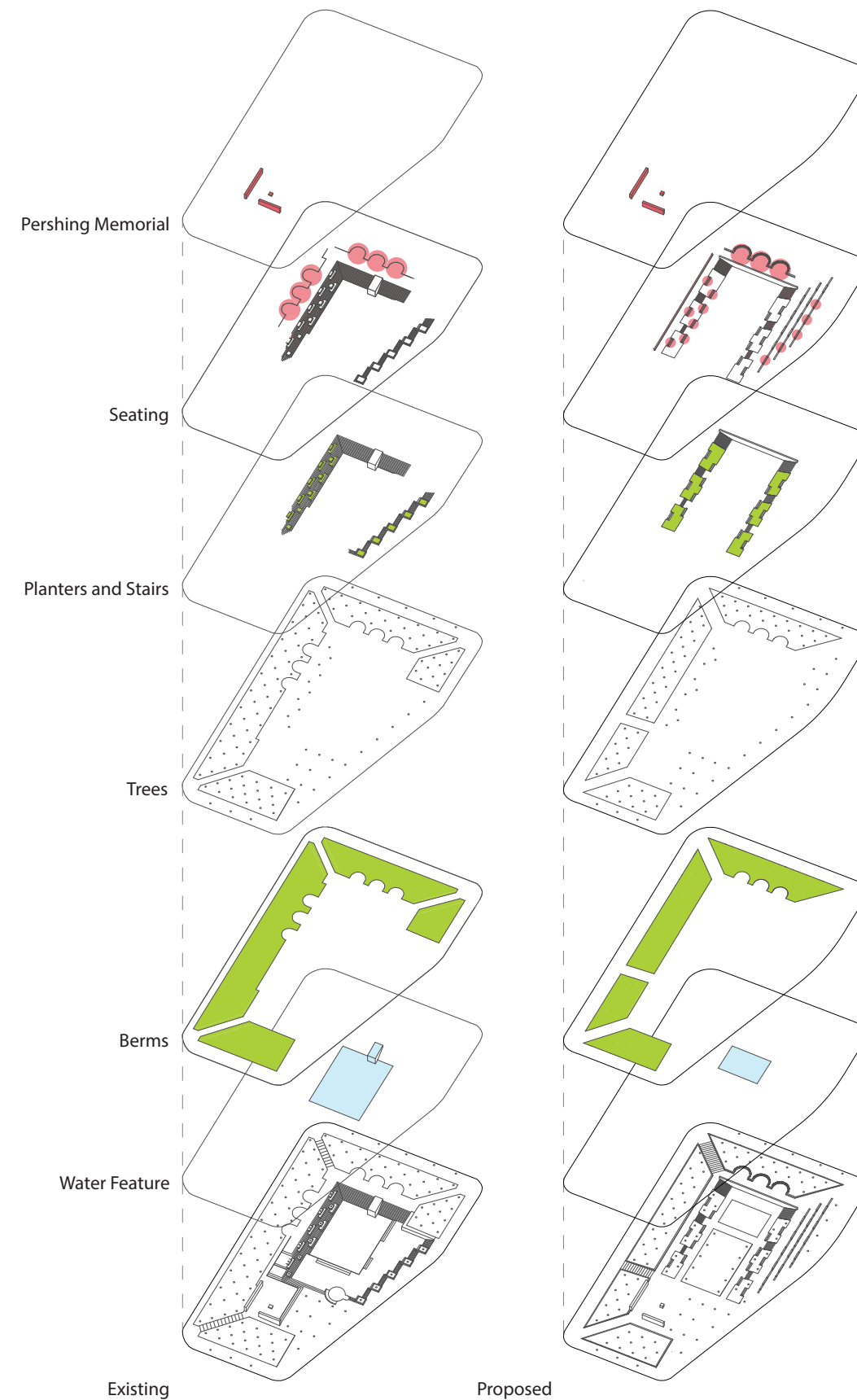

Topographic Enhancement

- maintains overall topographic relationships of existing park
- barriers to accessibility removed where possible
- earthen berms lowered slightly to increase visibility into park on the south, west, and east sides

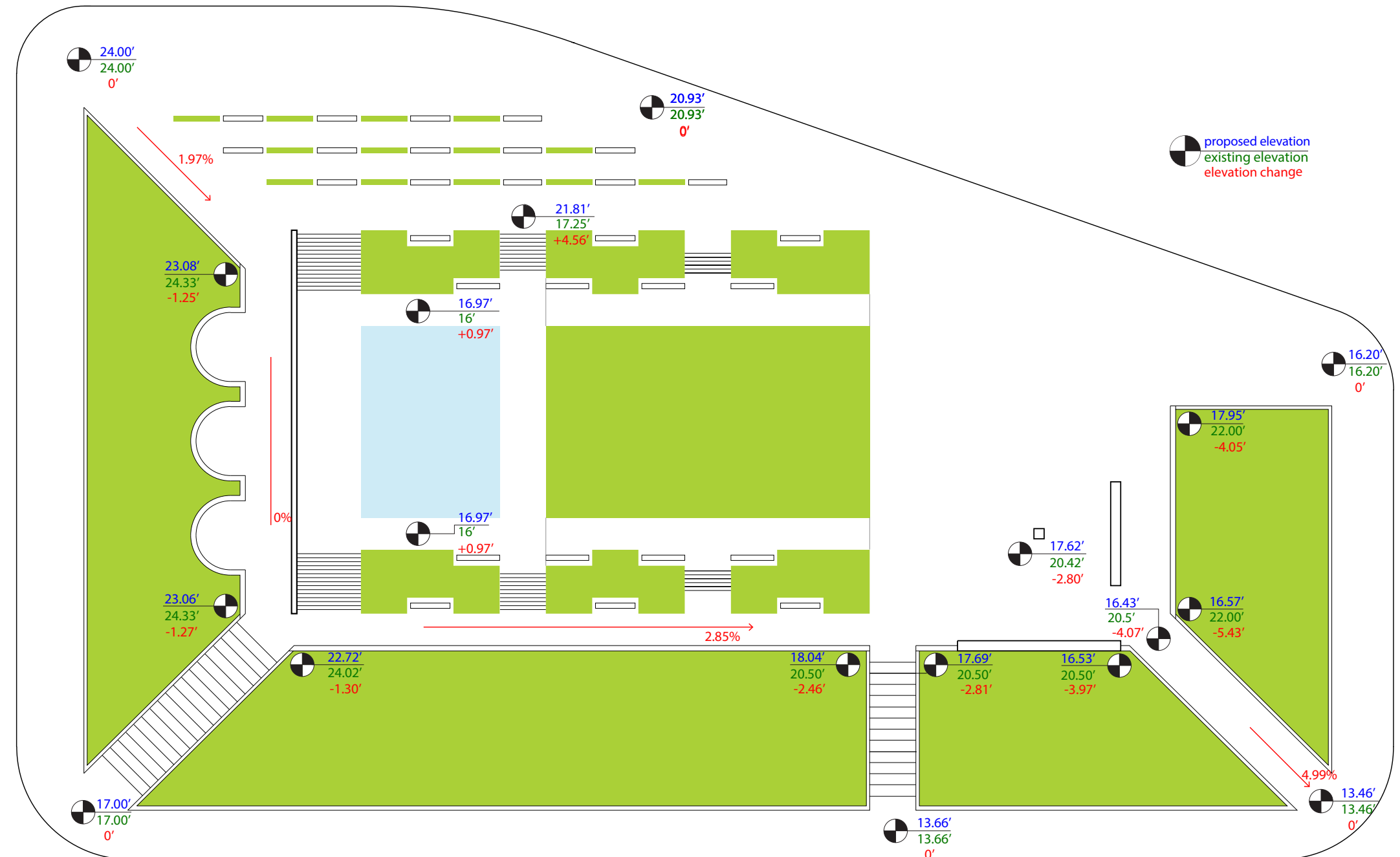

Topographic Enhancement

- visibility and accessibility enhanced across central Memorial space
- direct relationship between Memorial Wall and Pershing Wall



E/W Section Looking North

Memorial Wall

- primary new commemorative element
- visual and tactile experience honoring the sacrifice of all World War I servicemen and women

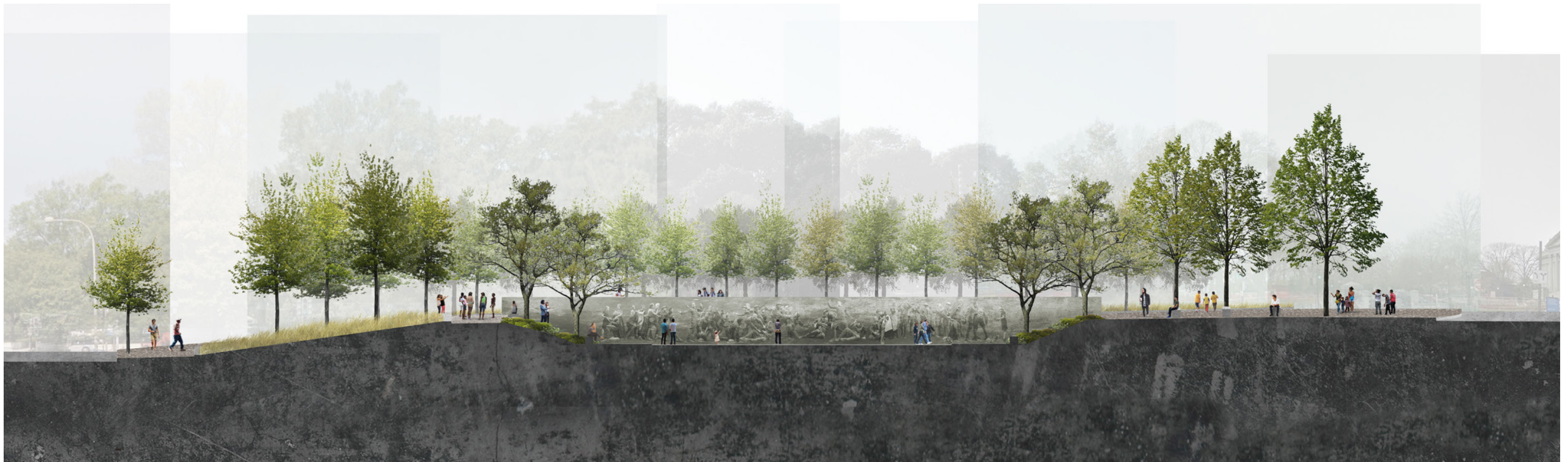

N/S Section Looking West

Sculptural Artwork

- 75' long bronze relief conceived as a visual and emotional narrative
- shows courage and heroism of American servicemen and women
- three episodes: the call to arms / departure, the battle, and the aftermath / return

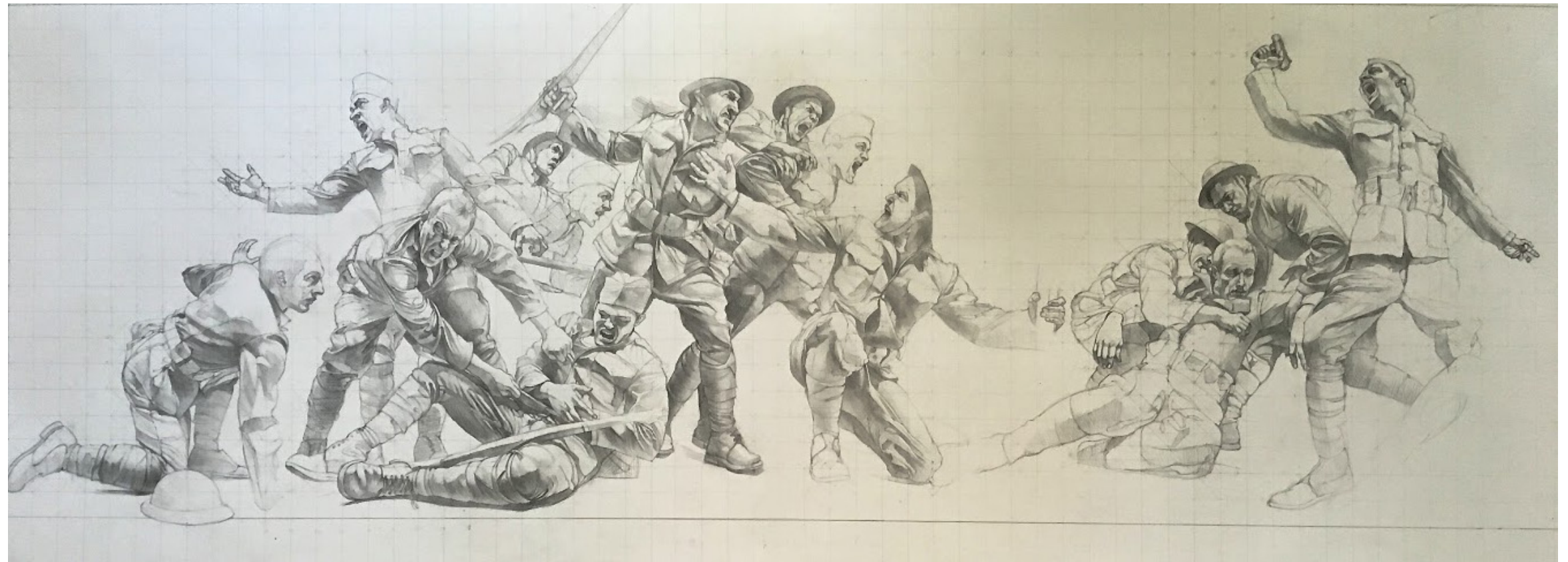

Accessibility and Visibility

- open, unified spaces are inclusive and universally accessible
- enhances connection to urban context
- enhances views into park on east, west, and south sides
- direct physical and visual connection between Pershing Memorial and the Memorial Wall

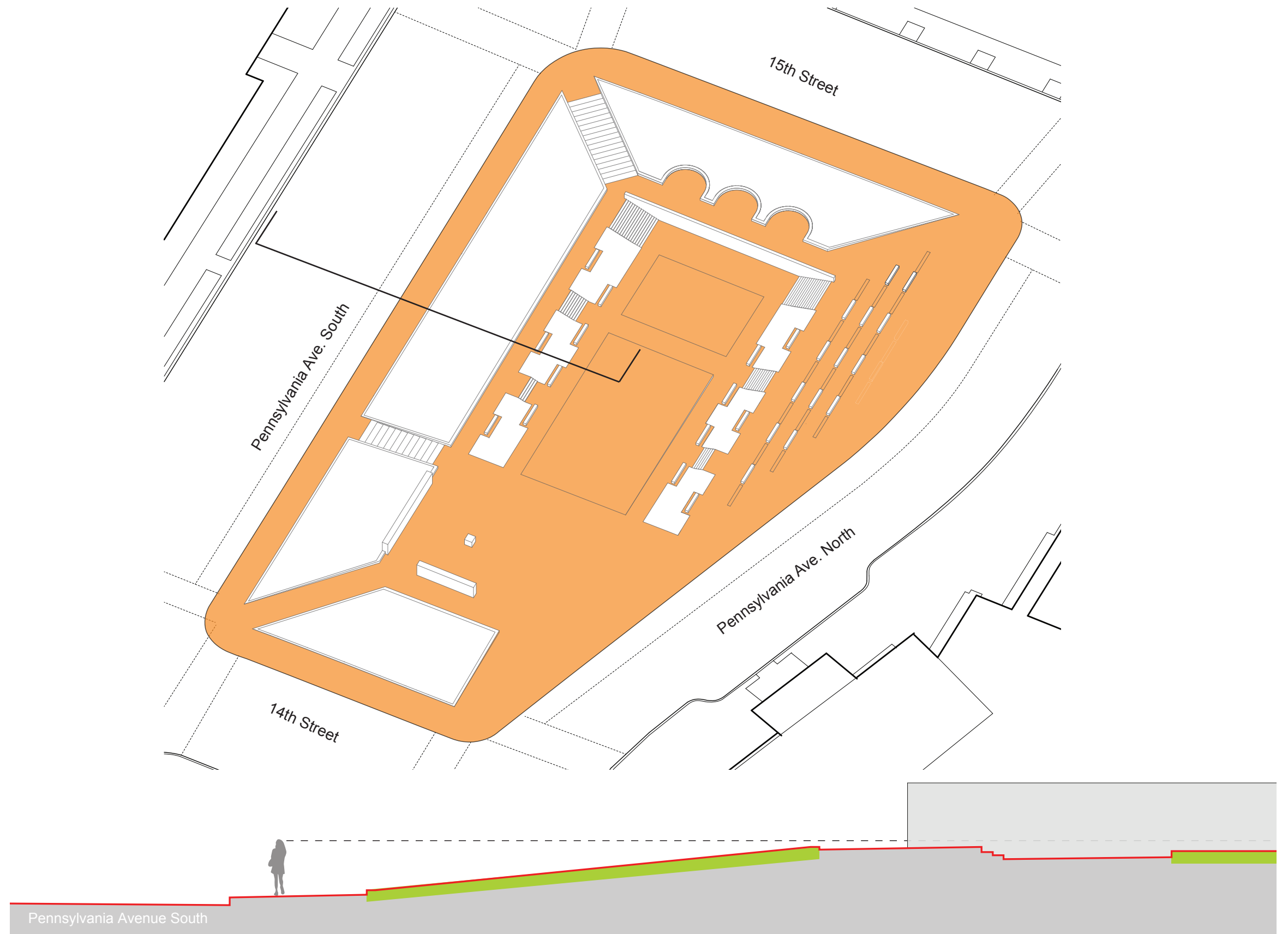

Memorial Precincts

- zones of proximity to Memorial elements
- sacred space of reflection, commemoration, and education
- integration of flexible urban park space / zones of overlapping use

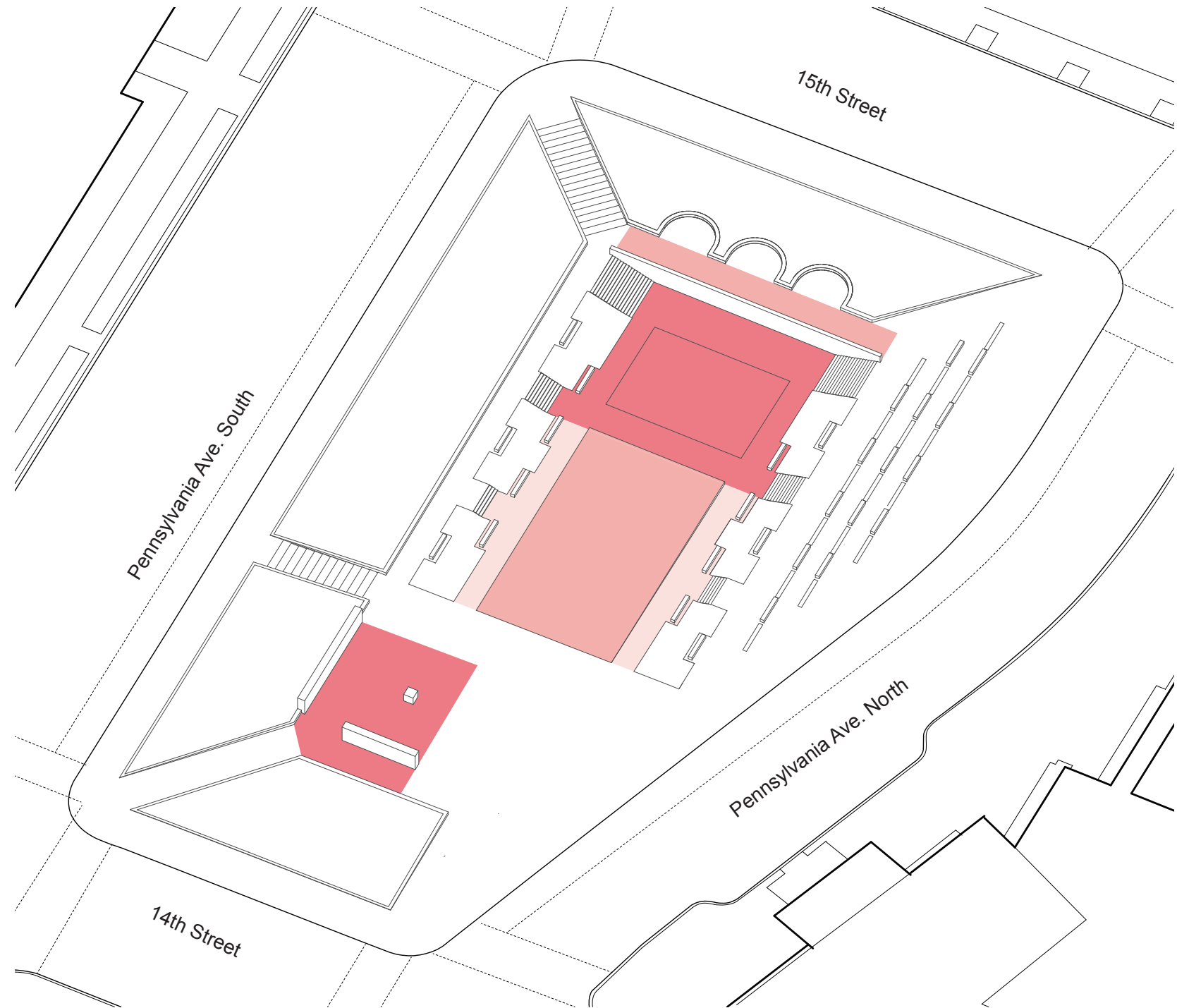

Planting Design

- legacy of Oehme van Sweden's planting design
- palette of appropriate native and adapted trees, grasses, and perennials
- low maintenance and year round color, structure, and shape.
- understory of grasses and forbs increase ecological value
- increased diversity of species
- number of trees in berms reduced to ensure adequate soil volume

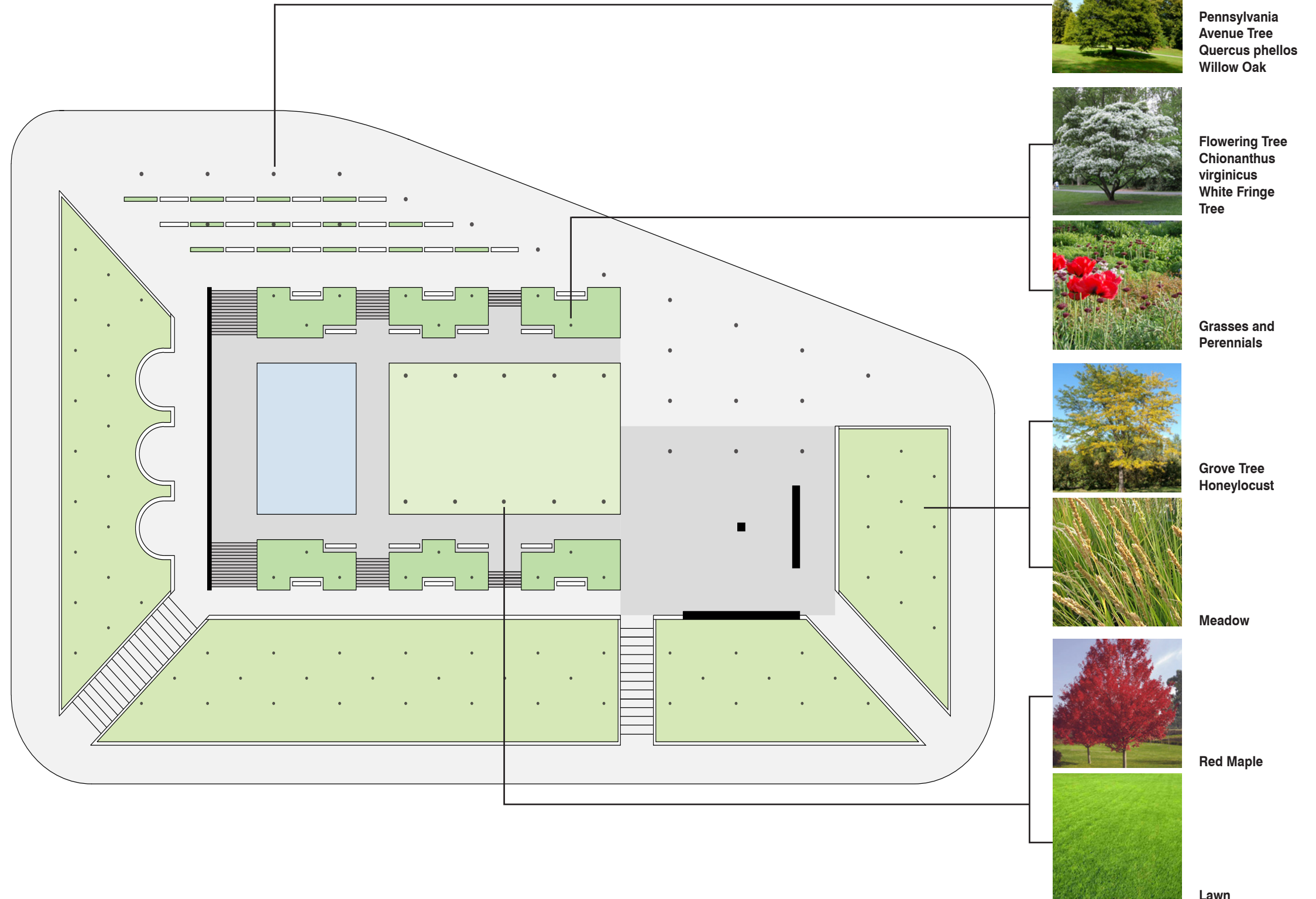



View looking east



View looking west



View looking west



View from northwest corner looking east





View from southeast corner

