



IN REPLY REFER TO:
L7615(YOSE-PM)

United States Department of the Interior

NATIONAL PARK SERVICE

Yosemite National Park
P. O. Box 577
Yosemite, California 95389

Memorandum

To: Randal Corral, Project Manager, Yosemite National Park

From: Superintendent, Yosemite National Park

Subject: NEPA and NHPA Clearance: Ahwahnee Comprehensive Rehabilitation Implementation: Interim Kitchen for Construction Period for Kitchen Floor Replacement (63784)

The Superintendent and park interdisciplinary team have reviewed the proposed project and completed an impact analysis and documentation, and have determined the following:

- There will not be any effect on threatened, endangered, or rare species and/or their critical habitat.
- There will be no adverse effect to historic properties.
- There will not be serious or long-term undesirable environmental or visual effects.

The subject proposed project, therefore, is now cleared for all NEPA and NHPA compliance requirements as presented above. Project plans and specifications are approved and construction and/or project implementation can commence.

For the proposed project actions to be within compliance requirements during construction and/or project implementation, the following mitigations must be adhered to:

- Locate containerized units off the historic patio. Ensure no damage to the historic patio and ensure measures to protect the patio are implemented. Ensure that the patio is protected before seating the enclosed walkway on top of it.
- Do not use fasteners or adhesives to connect the enclosed walkway to the historic Ahwahnee hotel. Ensure that hotel doors are carefully removed and stored properly for the duration of construction.
- Use above ground lines to supply utilities.
- Obtain fire inspection approval for fuel clearance beyond fire lane detour.
- Please coordinate water temperature for sewer discharge with the park Public Health Officer.
- During and after construction of the majestic bar, black rats were seen frequently and thought to have been introduced during construction. Make sure to take preventative measures to keep rodents, from entering the building or being introduced in project material. Have contractors work with Mark Smith, Aramark IPM coordinator and park IPM staff George Carroll.

Letter of Compliance Completion - Ahwahnee Comprehensive Rehabilitation Implementation: Interim Kitchen For Construction Period for Kitchen Floor Replacement - PEPC ID: 63784

- Fill will be imported to level the pad for the buildings. Heavy equipment may be used. Import fill and heavy equipment carry risk of introducing non-native plant propagules into the park. Imported fill must come from an approved source. Check with Vegetation and Ecological Restoration (VER) Specialist, Garrett Dickman for current approved sources. Heavy equipment must be inspected prior to entry into the park, call VER to arrange inspection, 379-3280.
- The fire lane detour would be a temporary access point to the other side of the hotel in the advent of a structural fire. The roadway goes through a mixture of native and most likely nonnative grasses. Mow the vegetated area where the fire vehicles would need to travel and place plastic 4x8 ft. track mats down to create a drivable surface. Optimally, these mats would be open celled plastic or steel mesh that would allow the vegetation to survive during this period of time, but still be drivable, even in wet soil conditions.

Recommendations for Conditions or Stipulations: None

For complete compliance information see PEPC Project 63784.

//Michael T. Reynolds// 6/8/18
Michael T. Reynolds, Superintendent

The signed original of this document is on file at the
Environmental Planning and Compliance Office in
Yosemite National Park.

Enclosure (with attachments)

cc: Statutory Compliance File



Categorical Exclusion Form

Project: 2018-019 Ahwahnee Comprehensive Rehabilitation Implementation: Interim Kitchen for Construction Period for Kitchen Floor Replacement

PEPC Project Number: 63784

Project Description:

This project will provide for an interim kitchen during the construction period for a larger project that will replace the kitchen floor at the historic Ahwahnee Hotel (presently known as the Majestic Hotel) that is being implemented under the 2011 Finding of No Significant Impact (FONSI) for the Ahwahnee Comprehensive Rehabilitation Plan Environmental Assessment (EA) (PEPC 27563) and programmatic agreement. Because the EnvirEA for the kitchen floor replacement project did not initially consider the need for an interim kitchen facility, the interim kitchen will be installed under a Categorical Exclusion tiered to the EA.

The construction of the kitchen floor replacement will cause substantial temporary operational impacts including completely disabling of food preparation and warewashing abilities in the kitchen. An interim kitchen is required to ensure that dining room operations and food service will continue during construction (approximately five months).

The interim kitchen will have facilities for food preparation, as well as dishwashing. This will allow food service (with a limited menu) and dishwashing to continue during kitchen floor construction, although some items normally produced in the kitchen (e.g., baked goods) will be delivered from off site. The interim kitchen, consisting of containerized units, will be placed in the fire lane on the south side of the dining room wing and will connect to it by an enclosed corridor. The containers will be seated on fill and supported with precast concrete planks. The food preparation component will consist of four containers outfitted with two refrigeration units and the dishwashing facility will be comprised of two containers. Temporary utilities will include water, electric, propane and wastewater; a lift pump is required for the waste line. Utilities will be supplied through temporary surface lines; ground disturbance will occur only at the point of connection to the existing waste line. The fire lane will be temporarily re-routed to the south of the containers in to maintain emergency access to the south and east sides of the hotel and will consist of heavy-duty mats placed over the grass. The area will be restored once the temporary kitchen is removed.

Ground disturbance will be minimized to the extent possible. Subject matter experts will be consulted so that impacts to resources are avoided.

Designs will be finalized in 2018. The temporary kitchen will be installed in November 2018; testing and inspections will occur in December 2018. Food services will begin in January 2019 and are expected to continue until construction is finished in May 2019.

Project Locations:

Mariposa County, CA

Mitigations:

Categorical Exclusion Form – 2018-019 Ahwahnee Comprehensive Rehabilitation Implementation: Interim Kitchen For Construction Period for Kitchen Floor Replacement - PEPC ID: 63784

- Obtain fire inspection approval for fuel clearance beyond fire lane detour.
- Please coordinate water temperature for sewer discharge with the park Public Health Officer.
- During and after construction of the majestic bar, black rats were seen frequently and thought to have been introduced during construction. Make sure to take preventative measures to keep rodents, from entering the building or being introduced in project material. Have contractors work with concessioner Integrated Pest Management coordinator and the park IPM staff.
- Fill will be imported to level the pad for the buildings. Heavy equipment may be used. Import fill and heavy equipment carry risk of introducing non-native plant propagules into the park. Imported fill must come from an approved source. Check with the park Vegetation and Ecological Restoration (VER) Specialist for current approved sources. Heavy equipment must be inspected prior to entry into the park, call VER to arrange inspection.
- The fire lane detour would be a temporary access point to the other side of the hotel in the advent of a structural fire. The roadway goes through a mixture of native and most likely nonnative grasses. Mow the vegetated area where the fire vehicles would need to travel and place plastic 4 x 8 foot track mats down to creates a drivable surface. Optimally, these mats would be open celled plastic or steel mesh that would allow the vegetation to survive during this period of time, but still be drivable, even in wet soil conditions.

CE Citation: A.1 Changes or amendments to an approved action when such changes would cause no or only minimal environmental impact.

CE Justification:

The project to replace the Ahwahnee kitchen floor being implemented under the 2011 Finding of No Significant Impact (FONSI) for the Ahwahnee Comprehensive Rehabilitation Plan Environmental Assessment (PEPC 27563) did not consider the need for an interim kitchen facility, and therefore interim kitchen impacts were analyzed under this Categorical Exclusion (A.1).

Decision: I find that the action fits within the categorical exclusion above. Therefore, I am categorically excluding the described project from further NEPA analysis. No extraordinary circumstances apply.

Superintendent: //Michael T. Reynolds// **Date:** 6/8/18
Michael T. Reynolds

The signed original of this document is on file at the Environmental Planning and Compliance Office in Yosemite National Park.

Extraordinary Circumstances:

If implemented, would the proposal...	Yes/No	Notes
A. Have significant impacts on public health or safety?	No	Interim kitchen will be inspected and meet all health/safety standards
B. Have significant impacts on such natural resources and unique geographic characteristics as historic or cultural resources; park, recreation, or refuge lands; wilderness areas; wild or scenic rivers; national natural landmarks; sole or principal drinking water aquifers; prime farmlands; wetlands (Executive Order 11990); floodplains (Executive Order 11988); national monuments; migratory birds; and other ecologically significant or critical areas?	No	
C. Have highly controversial environmental effects or involve unresolved conflicts concerning alternative uses of available resources (NEPA section 102(2)(E))?	No	
D. Have highly uncertain and potentially significant environmental effects or involve unique or unknown environmental risks?	No	
E. Establish a precedent for future action or represent a decision in principle about future actions with potentially significant environmental effects?	No	
F. Have a direct relationship to other actions with individually insignificant, but cumulatively significant, environmental effects?	No	
G. Have significant impacts on properties listed or eligible for listing on the National Register of Historic Places, as determined by either the bureau or office?	No	No ground disturbing activities are proposed in archeologically sensitive areas. The interim kitchen facilities will be seated off of the historic patio. The connecting walkway will be seated on a protective covering on top of the patio and will not use any fasteners or adhesives to seal with the hotel dining room.
H. Have significant impacts on species listed or proposed to be listed on the List of Endangered or Threatened Species, or have significant impacts on designated Critical Habitat for these species?	No	
I. Violate a federal, state, local or tribal law or requirement imposed for the protection of the environment?	No	
J. Have a disproportionately high and adverse effect on low income or minority populations (EO 12898)?	No	
K. Limit access to and ceremonial use of Indian sacred sites on federal lands by Indian religious practitioners or adversely affect the physical integrity of such sacred sites (EO 130007)?	No	Tribal governments have been consulted and voiced no concerns regarding this project.
L. Contribute to the introduction, continued existence,	No	Fill will be weed-free and follow best practices.

or spread of noxious weeds or non-native invasive species known to occur in the area or actions that may promote the introduction, growth, or expansion of the range of such species (Federal Noxious Weed Control Act and Executive Order 13112)?		
--	--	--



ENVIRONMENTAL SCREENING FORM (ESF)

Updated Sept 2015 per NPS NEPA Handbook

A. PROJECT INFORMATION

Project Title: 2018-019 Ahwahnee Comprehensive Rehabilitation Implementation: Interim Kitchen for Construction Period for Kitchen Floor Replacement
PEPC Project Number: 63784
Project Type: Repair/Rehabilitation (REHAB)
Project Location:
County, State: Mariposa, California
Project Leader: Randal Corral

B. RESOURCE IMPACTS TO CONSIDER:

Resource	Potential for Impact	Potential Issues & Impacts
Air: Air Quality	None	
Biological: Nonnative or Exotic Species	Potential	Impact: Imported fill to be used to level pad for the buildings. Any imported fill must come from an approved source.
Biological: Species of Special Concern or Their Habitat	None	
Biological: Vegetation	Potential	Issue: The fire lane detour would be a temporary access point to the other side of the hotel in the advent of a structural fire. The roadway goes through a mixture of native and most likely nonnative grasses. The vegetated area will be mowed where the fire vehicles would need to travel. Plastic 4x8 ft. track mats will be put down to create a drivable surface. Optimally, these mats would be open celled plastic or steel mesh that would allow the vegetation to survive during this period of time, but still be drivable, even in wet soil conditions.
Biological: Vegetation	Potential	Issue: One of the temporary buildings will have to be placed within the drip line of an oak tree. A single lower limb from that oak tree will have to be removed to fit the building in the desired spot. The buildings will be placed on pier blocks and steel I beams within the area of planted turf grasses. Concessioner should retain an arborist to remove the limb.
Biological: Wildlife and/or Wildlife Habitat including terrestrial and aquatic species	None	California Red-legged frogs are present in Yosemite Valley (Federally Endangered) but suitable habitat is not present within proposed work area.
Cultural: Archeological Resources	Potential	Impact: Temporary structures and utility lines will be above ground. No ground disturbing activities are

Environmental Screening Form (ESF) - Ahwahnee Comprehensive Rehabilitation Implementation: Interim Kitchen For Construction Period for Kitchen Floor Replacement - PEPC ID: 63784

Resource	Potential for Impact	Potential Issues & Impacts
		proposed in archeologically sensitive areas.
Cultural: Cultural Landscapes	None	
Cultural: Ethnographic Resources	Potential	Issue: As presently described the temporary kitchen will not adversely affect the existing patio and adjacent lawn.
Cultural: Museum Collections	None	
Cultural: Prehistoric/historic structures	Potential	The temporary kitchen and connectors will not adversely affect the existing historic patio or Ahwahnee Hotel.
Geological: Geologic Features	None	
Geological: Geologic Processes	None	
Lightscapes: Lightscapes	None	
Other: Human Health and Safety	Potential	Issue: During and after construction of the Majestic bar, black rats were seen frequently and are thought to have been introduced during construction. Preventative measures will be taken in order to keep rodents from entering buildings or being introduced in project material.
Other: Operational		Issue: The main kitchen project will impact food service operations, as the kitchen will be shut down. The temporary kitchen facility will operate with a simplified menu. Outdoor staging areas will reduce space in the service yard for normal hotel deliveries and trash removal. The temporary kitchen will not be accessible to large vehicles, which will require smaller and more frequent deliveries and trash removal, and additional remote storage.
Other: Other	None	
Socioeconomic: Land Use	None	
Socioeconomic: Minority and low-income populations, size, migration patterns, etc.	None	
Socioeconomic: Socioeconomic	None	
Soundscapes: Soundscapes	None	
Viewsheds: Viewsheds	Potential	Issue: Locating the temporary kitchen outside the Ahwahnee Hotel will affect views of the western side of the hotel from meadow and patio area. Views from within the Dining Room, the Great Room, and the Mural Room would all be temporarily affected by the placement of the temporary kitchen on the western side of the building.
Visitor Use and Experience: Recreation Resources	None	
Visitor Use and Experience: Visitor Use and Experience	None	
Water: Floodplains	None	
Water: Marine or Estuarine Resources	None	

Resource	Potential for Impact	Potential Issues & Impacts
Water: Water Quality or Quantity	None	
Water: Wetlands	None	
Water: Wild and Scenic River	Potential	Issue: The Ahwahnee Hotel lies within the Merced Wild and Scenic River corridor. This project will not impact or diminish ORVs.
Wilderness: Wilderness	None	
Wilderness: Wilderness	None	



ASSESSMENT OF ACTIONS HAVING AN EFFECT ON HISTORIC PROPERTIES

A. DESCRIPTION OF UNDERTAKING

1. **Park:** Yosemite National Park

2. **Project Description:**

Project Name: 2018-019 Ahwahnee Comprehensive Rehabilitation Implementation: Interim Kitchen for Construction Period for Kitchen Floor Replacement

Prepared by: Renea Kennec **Date Prepared:** 05/08/2018 **Telephone:** 209-379-1038

PEPC Project Number: 63784

Locations:

County, State: Mariposa, CA

Area of potential effects (as defined in 36 CFR 800.16[d])

Ahwahnee Hotel Historic District (NR 1977)

3. **Has the area of potential effects been surveyed to identify historic properties?**

☐ No
☒ Yes

Source or reference:

4. **Potentially Affected Resource(s):**

Archeological Resources Affected: Yes

Property Name: Yosemite Valley Archeological District

Historical Structures/Resources Affected: Yes

Property Name: Ahwahnee Hotel National Historical Landmark

Property Name: Yosemite Valley Historic District

Property Name: Ahwahnee Hotel

Cultural Landscapes Affected: Yes

Ethnographic Resources Affected: Yes

Property Name: Yosemite Valley Archeological District

5. **The proposed action will: (check as many as apply)**

Assessment of Effect Form – 3018-019 Ahwahnee Comprehensive Rehabilitation Implementation: Interim Kitchen For Construction Period for Kitchen Floor Replacement - PEPC ID: 63784

No Destroy, remove, or alter features/elements from a historic structure
No Replace historic features/elements in kind
No Add non-historic features/elements to a historic structure
No Alter or remove features/elements of a historic setting or environment (inc. terrain)
Yes Add non-historic features/elements (inc. visual, audible, or atmospheric) to a historic setting or cultural landscape
No Disturb, destroy, or make archeological resources inaccessible
No Disturb, destroy, or make ethnographic resources inaccessible
No Potentially affect presently unidentified cultural resources
No Begin or contribute to deterioration of historic features, terrain, setting, landscape elements, or archeological or ethnographic resources
No Involve a real property transaction (exchange, sale, or lease of land or structures)
X - The interim kitchen will be temporary in nature (5-6 months) and will
Other (please specify): be removed at the end of the project.

6. Supporting Study Data:

(Attach if feasible; if action is in a plan, EA or EIS, give name and project or page number.)

B. REVIEWS BY CULTURAL RESOURCE SPECIALISTS

The park 106 coordinator requested review by the park's cultural resource specialist/advisors as indicated by check-off boxes or as follows:

[X] 106 Advisor

Name: Kimball Koch

Date: 05/23/2018

Comments: Per review by CRM staff/subject matter experts and per the recommendation of Cultural Resources Chief, there would be no adverse effect associated with the installation and removal of a temporary kitchen. Work is being completed under the Programmatic Agreement for the Comprehensive Rehabilitation Program (2011).

Check if project does not involve ground disturbance []

Assessment of Effect: No Potential to Cause Effect No Historic Properties Affected X No

Adverse Effect Adverse Effect Streamlined Review

Recommendations for conditions or stipulations:

Doc Method: Park Specific or Other Programmatic Agreement

[X] Anthropologist

Name: Scott Carpenter

Date: 05/08/2018

Comments: Tribes and groups have not identified any concerns. All activities confined to interior.

Check if project does not involve ground disturbance []

Assessment of Effect: No Potential to Cause Effect No Historic Properties Affected X No

Assessment of Effect Form – 3018-019 Ahwahnee Comprehensive Rehabilitation Implementation: Interim Kitchen For Construction Period for Kitchen Floor Replacement - PEPC ID: 63784

Adverse Effect ☐ Adverse Effect ☐ Streamlined Review ☐
Recommendations for conditions or stipulations:
Doc Method: Park Specific or Other Programmatic Agreement

[X] Archeologist
Name: Scott Carpenter
Date: 05/08/2018
Comments: Temporary structures and utility lines will be above ground.

Check if project does not involve ground disturbance [☐]
Assessment of Effect: ☐ No Potential to Cause Effect ☐ No Historic Properties Affected ☒ No
Adverse Effect ☐ Adverse Effect ☐ Streamlined Review ☐
Recommendations for conditions or stipulations:
Doc Method: Park Specific or Other Programmatic Agreement

[X] Historian
Name: Scott Carpenter
Date: 05/08/2018
Check if project does not involve ground disturbance [☐]
Assessment of Effect: ☐ No Potential to Cause Effect ☐ No Historic Properties Affected ☒ No
Adverse Effect ☐ Adverse Effect ☐ Streamlined Review ☐
Recommendations for conditions or stipulations: Ensure no damage to historic patio (contributing feature to NHL).
Doc Method: Park Specific or Other Programmatic Agreement

[X] Historical Architect
Name: Sueann Brown
Date: 05/22/2018
Comments: This will have a significant visual impact during the months that it is in place, but will be temporary and the site will be restored after removal. Measures are being taken to avoid damage to the historic concrete patio.
Check if project does not involve ground disturbance [☐]
Assessment of Effect: ☐ No Potential to Cause Effect ☐ No Historic Properties Affected ☒ No
Adverse Effect ☐ Adverse Effect ☐ Streamlined Review ☐
Recommendations for conditions or stipulations: Ensure that measures to protect patio are implemented.
Doc Method: Park Specific or Other Programmatic Agreement

[X] Historical Landscape Architect
Name: Kimball Koch
Date: 05/08/2018
Comments: Temporary kitchen will not adversely affect the existing patio and adjacent lawn. Measures are being

Assessment of Effect Form – 3018-019 Ahwahnee Comprehensive Rehabilitation Implementation: Interim Kitchen For Construction Period for Kitchen Floor Replacement - PEPC ID: 63784

taken to ensure that the outdoor hardscape will not be damaged. Lawn area will be restored when temporary kitchen is removed.

Check if project does not involve ground disturbance []

Assessment of Effect: ☐ No Potential to Cause Effect ☐ No Historic Properties Affected ☒ No

Adverse Effect ☐ Adverse Effect ☐ Streamlined Review

Recommendations for conditions or stipulations:

Doc Method: Park Specific or Other Programmatic Agreement

No Reviews From: Curator, Other Advisor

C. PARK SECTION 106 COORDINATOR'S REVIEW AND RECOMMENDATIONS

1. Assessment of Effect:

☐ No Potential to Cause Effects
☐ No Historic Properties Affected
☒ No Adverse Effect
☐ Adverse Effect

2. Documentation Method:

☐ A. Standard 36 CFR Part 800 Consultation

Further consultation under 36 CFR Part 800 is needed.

☐ B. Streamlined Review Under the 2008 Servicewide Programmatic Agreement (PA)

The above action meets all conditions for a streamlined review under section III of the 2008 Servicewide PA for Section 106 compliance.

Applicable Streamlined Review Criteria

(Specify 1-16 of the list of streamlined review criteria.)

☒ C. Undertaking Related to Park Specific or Another Agreement

The proposed undertaking is covered for Section 106 purposes under another document such as a park, region or statewide agreement established in accord with 36 CFR 800.7 or 36 CFR 800.14.

2011 Ahwahnee Comprehensive Rehabilitation Plan PA

☐ D. Combined NEPA/NHPA Process

Process and documentation required for the preparation of an EA/FONSI or an EIS/ROD to comply with Section 106 is in accord with 36 CFR 800.8.c.

☐ E. Memo to Project File

3. Consultation Information

Assessment of Effect Form – 3018-019 Ahwahnee Comprehensive Rehabilitation Implementation: Interim Kitchen For Construction Period for Kitchen Floor Replacement - PEPC ID: 63784

SHPO Required: No

SHPO Sent:

SHPO Received:

SHPO/THPO Notes:

Advisory Council Participating: No

Advisory Council Notes: No

Additional Consulting Parties: No

4. Stipulations and Conditions: Following are listed any stipulations or conditions necessary to ensure that the assessment of effect above is consistent with 36 CFR Part 800 criteria of effect or to avoid or reduce potential adverse effects.

5. Mitigations/Treatment Measures: Measures to prevent or minimize loss or impairment of historic/prehistoric properties: (Remember that setting, location, and use may be relevant.)

- Locate containerized units off of the historic patio.
- Ensure that the patio is protected before seating the enclosed walkway on top of it.
- Do not use fasteners or adhesives to connect the enclosed walkway to the historic Ahwahnee hotel. Ensure that hotel doors are carefully removed and stored properly for the duration of construction.
- Use above ground lines to supply utilities.

6. Assessment of Effect Notes:

**D. RECOMMENDED BY PARK SECTION 106
COORDINATOR:**

Kimball Koch //Kimball Koch// **Date:** 5/31/18

E. SUPERINTENDENT'S APPROVAL

The proposed work conforms to the NPS *Management Policies* and *Cultural Resource Management Guideline*, and I have reviewed and approve the recommendations, stipulations, or conditions noted in Section C of this form.

Superintendent: //Michael T. Reynolds// **Date:** 6/8/18
Michael T. Reynolds

The signed original of this document is on file at the
Environmental Planning and Compliance Office in
Yosemite National Park.

EQUIPMENT SCHEDULE

CS=CLIENT SUPPLIED EQUIPMENT

Item	Description	By	Item	Description	By	Item	Description	By
1	Walk-In Freezer - 8x10	KTG	16	Exhaust Hood - Type II (Vapor)	KTG	31	Beverage Counter	TBD
2	Adj Wire Freezer Shelving	CS	17	Tilt Skillet	KTG	32	Post Mix Soda Dispenser	CS
3	Walk-In Cooler - 8x20	KTG	18	Steam Jacketed Kettle	KTG	33	2 Group Espresso Brewer	CS
4	Adj Wire Cooler Shelving	CS	19	36" Range Base with 2 Burners/1 Hot Top and Oven	TBD	34	Coffee Grinder	CS
5	Dry Storage - 8x20	KTG	20	36" Range Base with 4 Burners/ and Oven	TBD	35	Iced Tea Brewer	CS
6	Adj Wire Dry Storage Shelving	CS	21	36" Range Base with 36" Griddle and Oven	TBD	36	Hot Chocolate Dispenser	CS
7	Adj Wire Plate Storage	CS	22	Double Stack Steamer	KTG	37	Fetco Coffee Brewer	CS
8	Refrigerated Prep/Make-Up Table	KTG	23	Combi Oven	CS	38	Water Heater	KTG
9	Reach-In Refrigerator	KTG	24	Fryer	TBD	39	Electrical Panel	KTG
10	2 Compartment Prep Sink	KTG	25	36" Range Base with 2 Hot Tops and Oven	TBD	40	Scrap Table	KTG
11	Refrigerated Fish File	CS	26	36" Range Base with 6 Burners/ and Oven	TBD	41	Flight Dishmachine	KTG
12	Mop Sink	KTG	27	36" Char Broiler	KTG	42	Adj Wire Shelving (Cleanwares Storage)	CS
13	Hand Sink	KTG	28	1 Comp Prep Sink	KTG	43	3 Comp Utensil Sink	KTG
14	Exhaust Hood - Type I (Grease)	KTG	29	36" Work Table	KTG	44	Wall Mount HVAC	KTG
15	Ansul Fire Suppression	KTG	30	Refrigerated Prep/Make-Up Table	KTG			

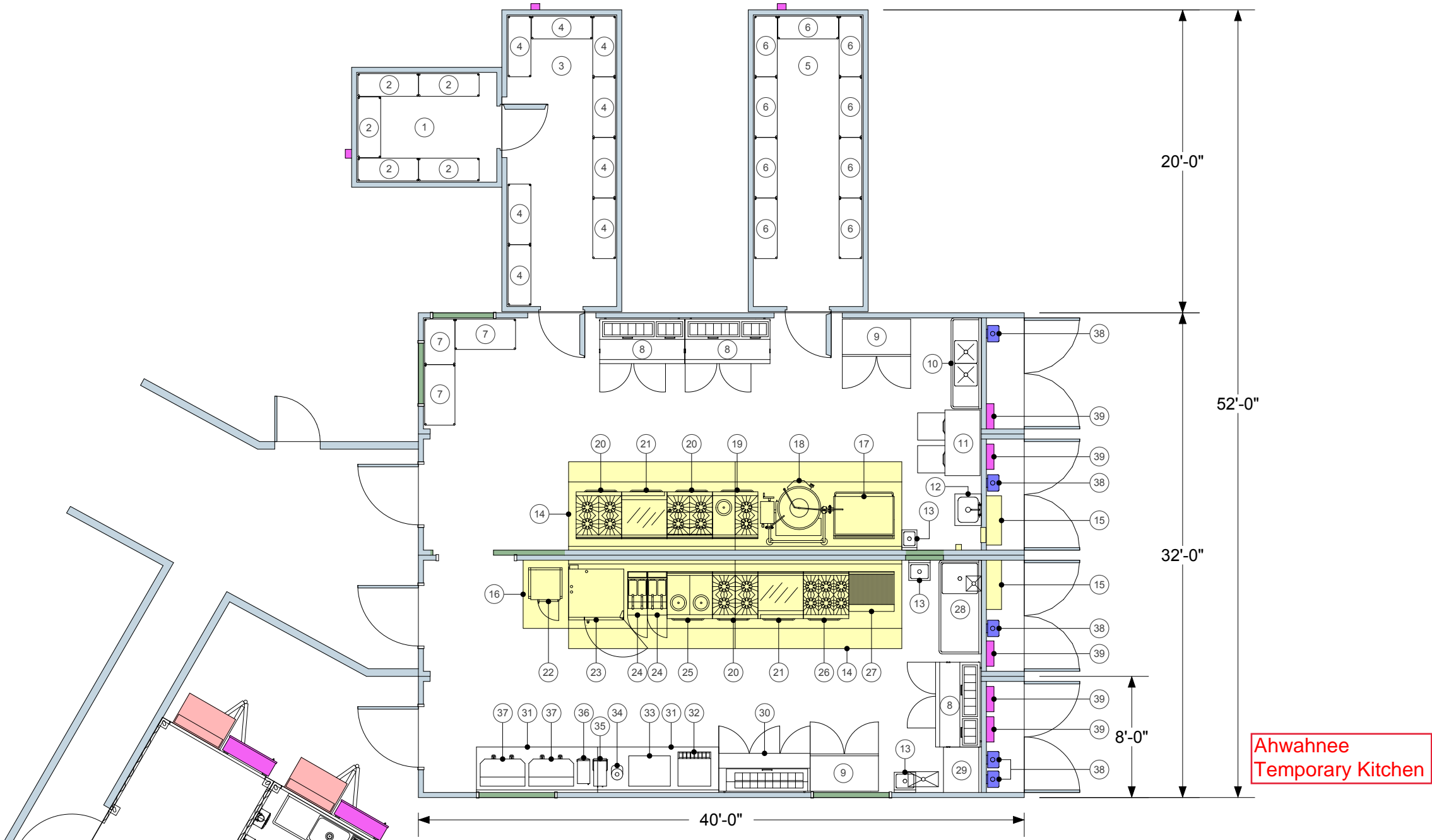

KITCHENS TO GO®
Built by CARLIN

466 WEST FALLBROOK AVENUE
SUITE 106
FRESNO, CA 93711
559-276-0123
www.carlingmfg.com,
www.k-t-g.com

CARLIN
Manufacturing, LLC

THE DESIGN AND DETAILS DISCLOSED HEREIN ARE THE EXCLUSIVE PROPERTY OF CARLIN MANUFACTURING LLC AND SHALL NOT BE COPIED OR REPRODUCED IN WHOLE OR IN PART WITHOUT PRIOR WRITTEN CONSENT OF CARLIN MANUFACTURING LLC.
2017 © CARLIN MANUFACTURING LLC

APPROVED BY CLIENT

By:

Date:

YOSEMITE
NATIONAL PARK

aramark

Majestic Hotel
Interim Kitchen

1 Ahwahnee Drive
Yosimete Nat'l Park, CA 95389

DELTA 2	
L17-006	
11x17 Scale	1/8" = 1'-0"
DD	1-18-18
LARGE KTG KITCHEN	
A-102.6	

EQUIPMENT SCHEDULE

CS=CLIENT SUPPLIED EQUIPMENT

Item	Description	By	Item	Description	By	Item	Description	By
1	Walk-In Freezer - 8x10	KTG	16	Exhaust Hood - Type II (Vapor)	KTG	31	Beverage Counter	TBD
2	Adj Wire Freezer Shelving	CS	17	Tilt Skillet	KTG	32	Post Mix Soda Dispenser	CS
3	Walk-In Cooler - 8x20	KTG	18	Steam Jacketed Kettle	KTG	33	2 Group Espresso Brewer	CS
4	Adj Wire Cooler Shelving	CS	19	36" Range Base with 2 Burners/1 Hot Top and Oven	TBD	34	Coffee Grinder	CS
5	Dry Storage - 8x20	KTG	20	36" Range Base with 4 Burners/ and Oven	TBD	35	Iced Tea Brewer	CS
6	Adj Wire Dry Storage Shelving	CS	21	36" Range Base with 36" Griddle and Oven	TBD	36	Hot Chocolate Dispenser	CS
7	Adj Wire Plate Storage	CS	22	Double Stack Steamer	KTG	37	Fetco Coffee Brewer	CS
8	Refrigerated Prep/Make-Up Table	KTG	23	Combi Oven	CS	38	Water Heater	KTG
9	Reach-In Refrigerator	KTG	24	Fryer	TBD	39	Electrical Panel	KTG
10	2 Compartment Prep Sink	KTG	25	36" Range Base with 2 Hot Tops and Oven	TBD	40	Scrap Table	KTG
11	Refrigerated Fish File	CS	26	36" Range Base with 6 Burners/ and Oven	TBD	41	Flight Dishmachine	KTG
12	Mop Sink	KTG	27	36" Char Broiler	KTG	42	Adj Wire Shelving (Cleanwares Storage)	CS
13	Hand Sink	KTG	28	1 Comp Prep Sink	KTG	43	3 Comp Utensil Sink	KTG
14	Exhaust Hood - Type I (Grease)	KTG	29	36" Work Table	KTG	44	Wall Mount HVAC	KTG
15	Ansul Fire Suppression	KTG	30	Refrigerated Prep/Make-Up Table	KTG			

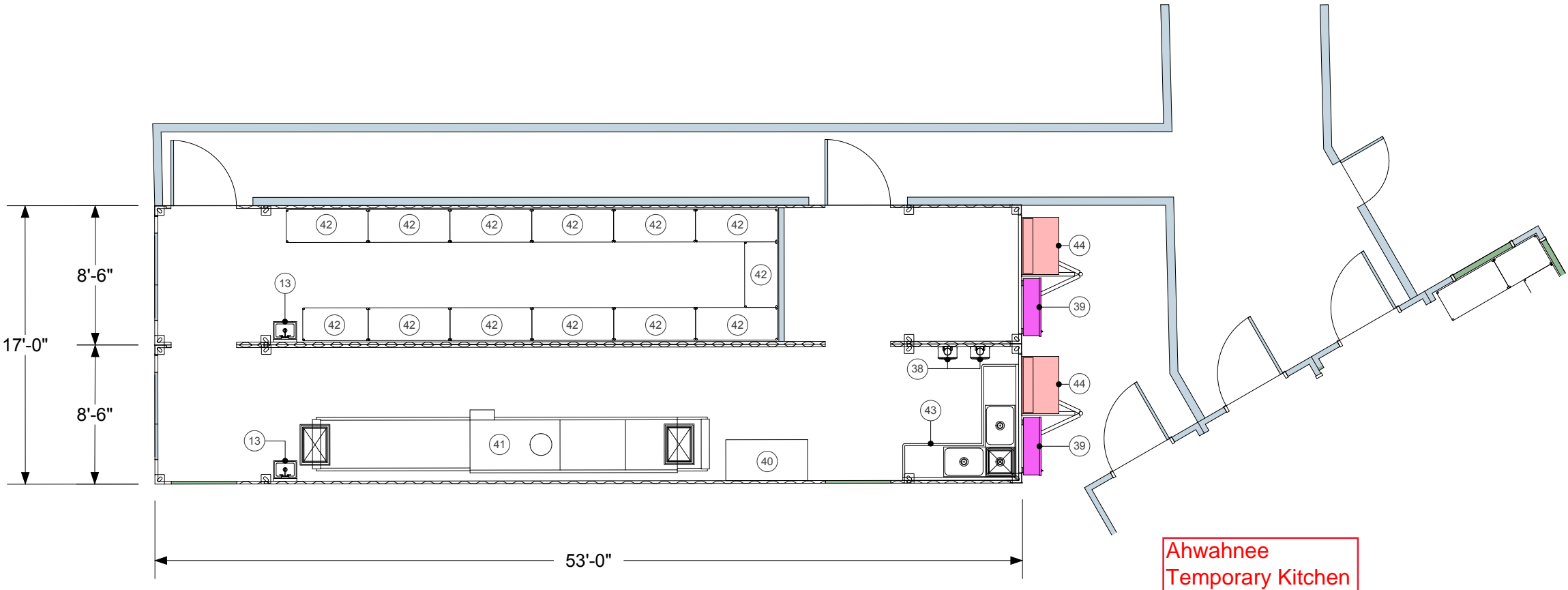

466 WEST FALLBROOK AVENUE
SUITE 106
FRESNO, CA 93711
559-276-0123
www.carlingmfg.com,
www.k-t-g.com



THE DESIGN AND DETAILS DISCLOSED HEREIN ARE THE EXCLUSIVE PROPERTY OF
CARLIN MANUFACTURING LLC AND SHALL NOT BE COPIED OR REPRODUCED IN
WHOLE OR IN PART WITHOUT PRIOR WRITTEN CONSENT OF CARLIN MANUFACTURING LLC.
2017 © CARLIN MANUFACTURING LLC

APPROVED BY CLIENT

By:

Date:



Majestic Hotel
Interim Kitchen

1 Ahwahnee Drive
Yosimete Nat'l Park, CA 95389

DELTA 2

L17-006

11x17 Scale

1/8" = 1'-0"

DD

1-18-18

LARGE KTG WASH

A-102.8