

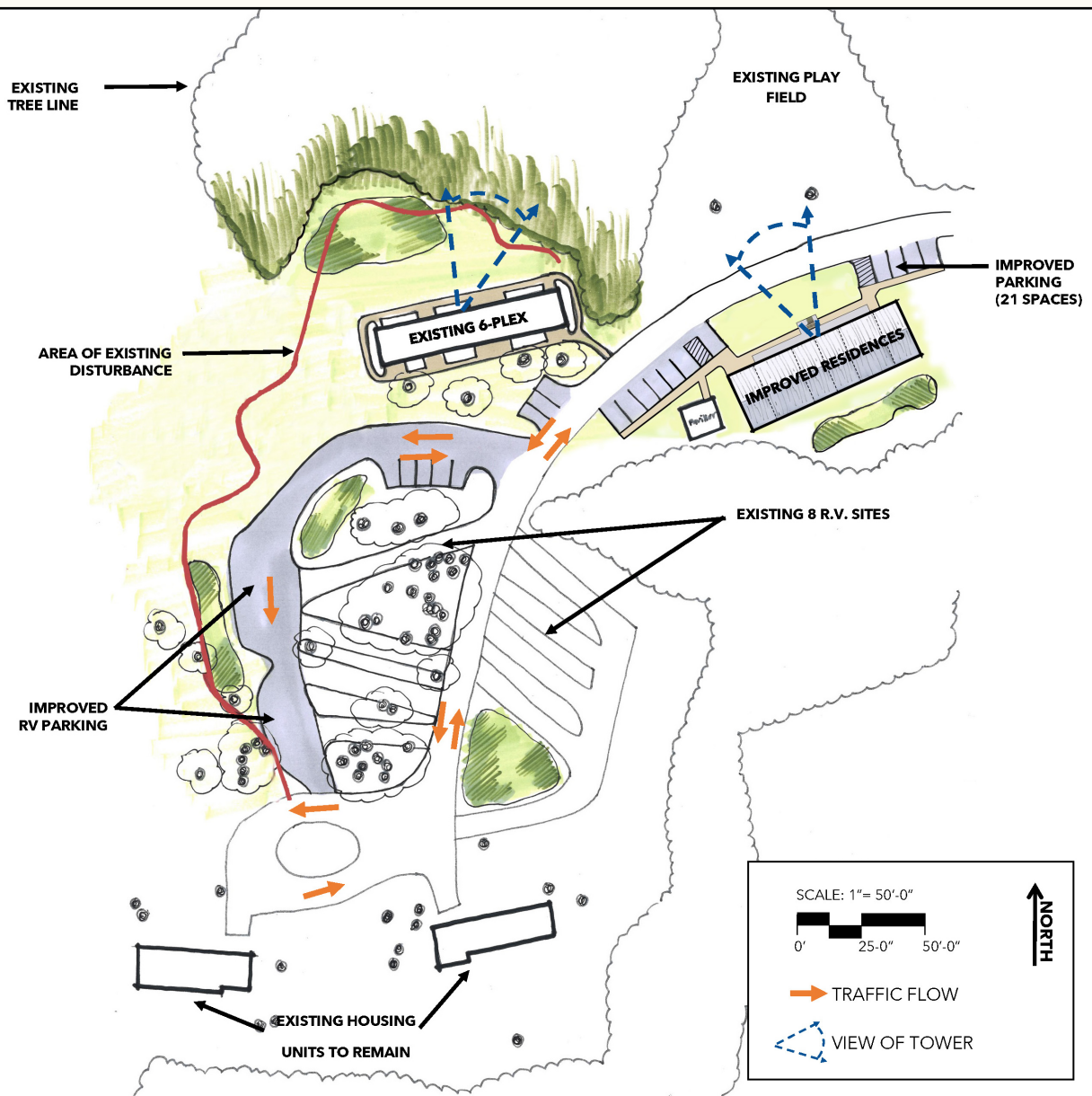

Employee Housing Project Options • February 2021



Concept 1: Retain the Existing Housing Facility

- Retain the existing 6-unit Mission 66 housing facility and add a new 9-unit, two-story staff housing facility.
 - Code-compliant and energy-efficient facility
 - Ground-level ABAAS accessible units
 - Storage and laundry/shower units
- The new facility would have a direct clear view of the tower from the front windows.
- The new facility would be separated from the RV parking.
- The existing eight RV sites would be reused and two new pull-through RV sites would be added.
- The existing utilities would be upgraded by expanding the leach field and improving traffic flow and parking in the proposed project area.
- The community gathering area would include a shade pavilion, fire pit, BBQ, paved concrete pad, site furnishing, and utility hookups.
- Approximately 13,000 square feet in new disturbance.



Employee Housing Project Options • February 2021

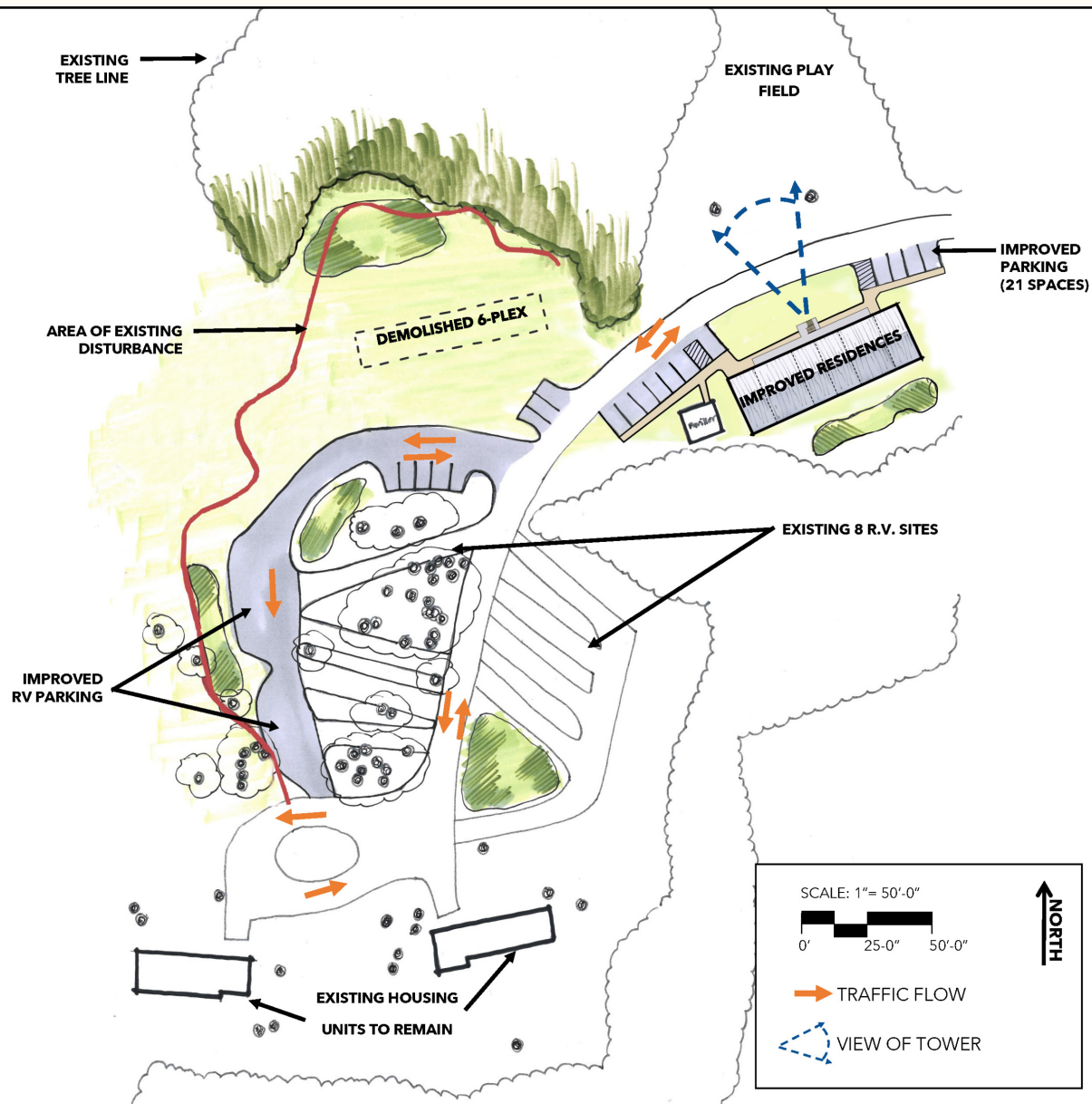

Concept 2: Demolish the Existing Housing Facility

- Demolish the existing 6-unit Mission 66 housing facility and add a new 9-unit, two-story staff housing facility.
 - Code-compliant and energy-efficient facility
 - Ground-level ABAAS accessible units
 - Storage and laundry/shower units
- Approximately 13,000 square feet in new disturbance.
- The new facility would have a direct clear view of the tower from the front windows.
- The new facility would be separated from the RV parking.
- The existing eight RV sites would be reused and two new pull-through RV sites would be added.
- An additional open area would be available for future RV parking or recreation area.
- The existing utilities would be upgraded by expanding the leach field and improving traffic flow and parking in the proposed project area.
- The community gathering area would include a shade pavilion, fire pit, BBQ, paved concrete pad, site furnishing, and utility hookups.



Employee Housing Project Options • February 2021

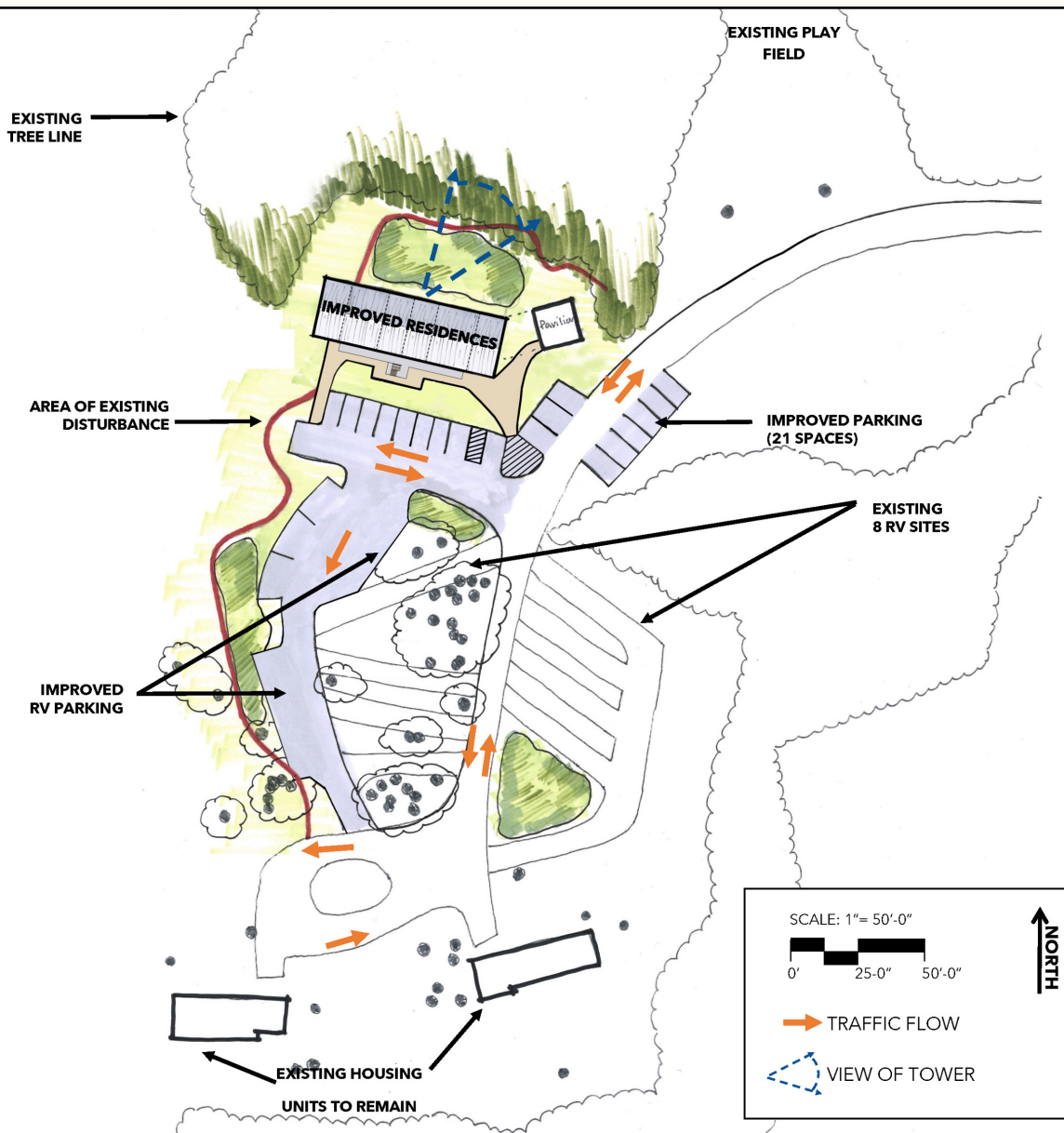

Concept 3: Demolish and Replace the Existing Housing Facility

- Demolish the existing 6-unit Mission 66 housing facility and replace it with a new 9-unit, two-story staff housing facility.
 - Code-compliant and energy-efficient facility
 - Ground-level ABAAS accessible units
 - Storage and laundry/shower units
- Approximately 2,000 square feet in new disturbance.
- The new facility would have improved direct view of the tower from the rear windows.
- The parking areas would be centralized.
- The existing eight RV sites would be reused and two new pull-through RV sites would be added.
- The existing utilities would be upgraded by expanding the leach field and improving traffic flow and parking in the proposed project area.
- The community gathering area would include a shade pavilion, fire pit, BBQ, paved concrete pad, site furnishing, and utility hookups.