



REPAIR & MAINTENANCE OF THE NORTH AND EAST GARAGES

SECTION 106 CONSULTING PARTIES/ PUBLIC MEETING #1

June 30, 2021

CLIENT

BOARD OF GOVERNORS OF THE FEDERAL RESERVE SYSTEM

ARCHITECT

SHALOM BARANES ASSOCIATES

LANDSCAPE ARCHITECT

OEHME, VAN SWEDEN

LAND OWNERSHIP AND MANAGEMENT

- THE NATIONAL MALL AND MEMORIAL PARKS (NAMA) HAS ADMINISTRATIVE JURISDICTION OF RESERVATIONS 105 AND 378.
- THE PARKING GARAGES LOCATED BENEATH RESERVATION 378 WERE CONSTRUCTED AND ARE MAINTAINED BY THE FRB AND USED BY BOTH THE FRB AND THE DEPARTMENT OF THE INTERIOR (DOI).
- THE FRB ALSO MAINTAINS THE PARKLAND AND TENNIS COURT PER A 2005 MEMORANDUM OF AGREEMENT (MOA) AMONG THE FRB, NPS, AND U.S. PARK POLICE (USPP). THE NPS IS RESPONSIBLE FOR MAJOR PARK MAINTENANCE PROJECTS AND THE DISCOBOLUS STATUE. THE NPS WAS RESPONSIBLE FOR ROUTINE MAINTENANCE OF THE PARKLAND PRIOR TO THE 2005 MOA.

DISCUSSION POINTS

PROJECT GOALS

SITE OVERVIEW

SECTION 106 OVERVIEW

LANDSCAPE DESIGN HISTORY

SITE ANALYSIS

CONCEPT DIAGRAMS: ARCHITECTURE

PROJECT GOAL

THE PROJECT WILL REPAIR THE UNDERGROUND GARAGE INFRASTRUCTURE AND BRING THE FACILITY IN COMPLIANCE WITH CURRENT BUILDING CODES PROVIDING MODERN ACCESSIBLE ACCESS. PARK ENHANCEMENTS INCLUDE IMPROVED PEDESTRIAN PATHWAYS AND INCREASED AND ACCESSIBLE SEATING, WHILE MAINTAINING HISTORIC FEATURES OF THE PARK ENSURING FUTURE GENERATIONS EXPERIENCE A PARK KNOWN FOR ITS SEASONAL GRASSES AND PERENNIALS.

PROJECT SCOPE

- REPLACE THE EXISTING WATERPROOFING AT THE NORTH AND EAST GARAGE ROOFS AND THE FOUNTAIN PLAZA. THIS REQUIRES REMOVAL OF THE PARK.
- PROVIDE ACCESSIBLE ACCESS TO THE NORTH GARAGE. TWO NEW ACCESSIBLE PASSENGER ELEVATORS ARE NEEDED.
- REPAIR FOUNTAIN INFRASTRUCTURE AT EAST PLAZA.
- PROVIDE WIDER SIDEWALKS ALONG VIRGINIA AVENUE AND 21ST STREET IN LINE WITH DDOT’S REQUIREMENTS.
- REPLACE ALL EXISTING PARK FEATURES TO INCLUDE MAINTAINING SIMILAR PLANTINGS.



SITE OVERVIEW

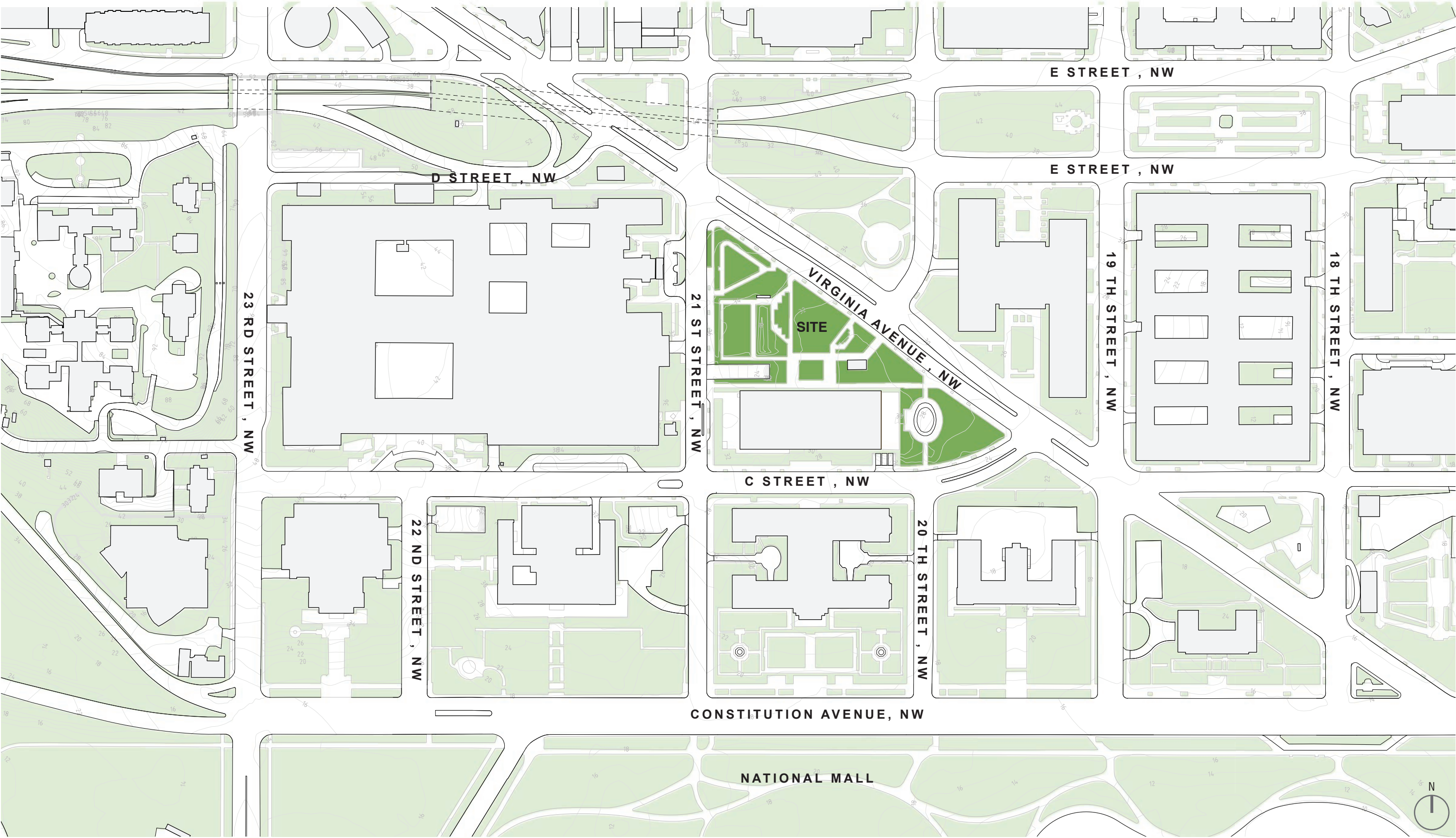

1870s
VIRGINIA AVENUE PAVED.



1899 - 1912
THE TRIANGLE PARKS CREATED BY THE L'ENFANT PLAN WERE DELINEATED, LANDSCAPED, AND ENCLOSED. THESE PARKS WERE "BREATHING SPACES" OF SIMPLE LANDSCAPED AREAS FOR PASSIVE RECREATION.



1930s
FIRST LARGE SCALE DEVELOPMENT AT THE SOUTHERN HALF OF VIRGINIA AVE TO HOUSE FEDERAL AGENCIES.

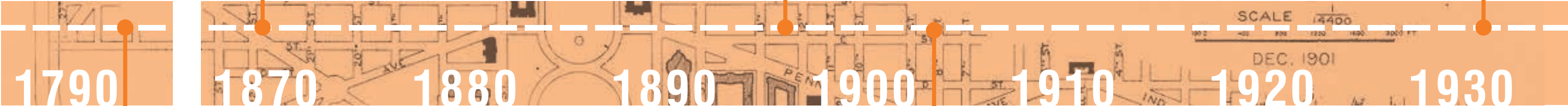
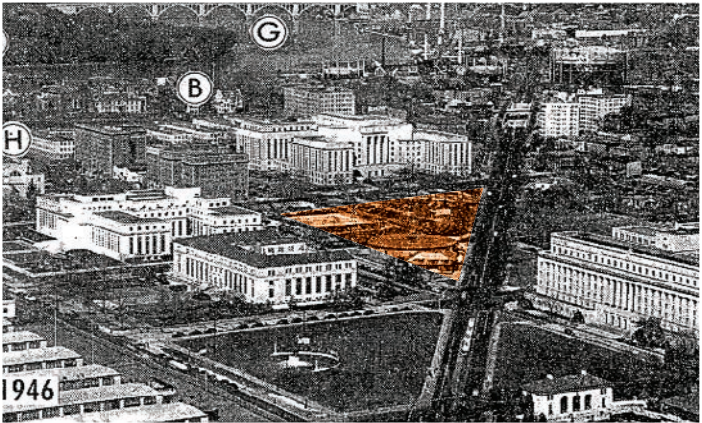

1791
VIRGINIA AVENUE WAS LAID OUT AS PART OF PIERRE L'ENFANT'S PLAN FOR THE CITY OF WASHINGTON.



1901 - 1902
THE SENATE PARK COMMISSION PREPARED AND PUBLISHED A REPORT, KNOWN AS THE MCMILLAN PLAN, WITH RECOMMENDATIONS FOR IMPROVING THE DESIGN AND APPEARANCE OF WASHINGTON DC, WITH SPECIAL ATTENTION GIVEN TO IT'S HISTORIC CORE. THE PLAN INCLUDED A PROPOSED EXTENSION OF THE NATIONAL MALL ALONG VIRGINIA AVENUE BETWEEN 18TH STREET AND NEW YORK AVENUE.

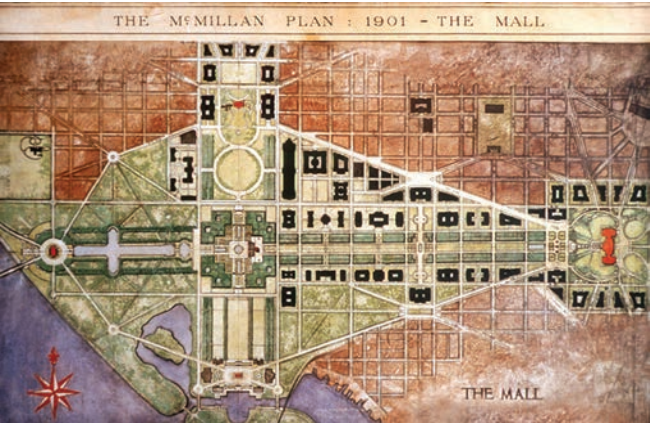

1976

AFTER A STORM DESTROYS MUCH OF THE ORIGINAL LANDSCAPING, WOLFGANG OEHME AND JAMES VAN SWEDEN REHABILITATED THE GARDEN. THIS IS OVS' FIRST EXAMPLE OF THE NEW AMERICAN GARDEN STYLE OF LANDSCAPE DESIGN. THIS STYLE EMBRACED SEASONALITY AND THE AESTHETIC OF THE GREAT PLAINS AND NORTH AMERICAN MEADOWS.



2004

SITE SECURITY UPGRADES



2015

RENOVATION AND ADDITION OF MARTIN BUILDING BEGINS.



c1945

NEW YORK AVENUE IS CLOSED.

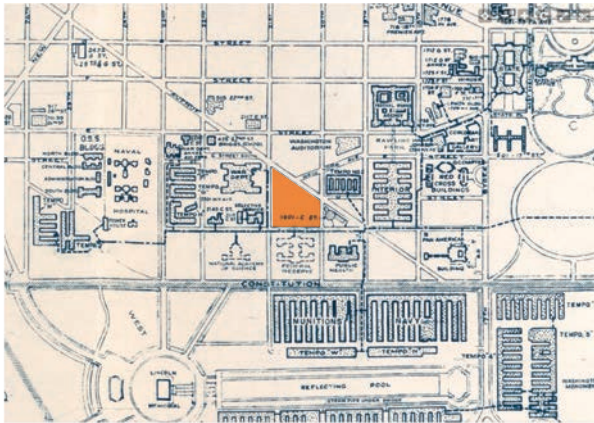

1950 - 1977

POST WAR URBAN RENEWAL AND BEAUTIFICATION EFFORTS RESHAPED VIRGINIA AVENUE AND MANY OF ITS OPEN SPACES. 1971 PLANTING PLAN BY GEORGE PATTON @ PROJECT SITE.

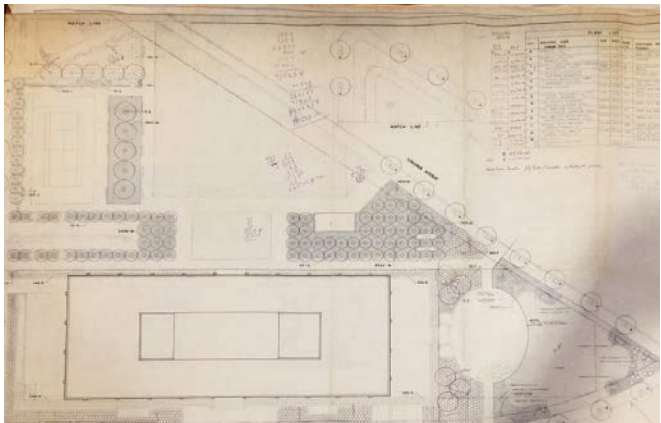

c1967

20TH AND C STREETS ARE RE-ROUTED.



2019

THE NATIONAL PARKS SERVICE PUBLISHES THE CULTURAL LANDSCAPES INVENTORY FOR VIRGINIA AVENUE NW TO IDENTIFY NOTABLE LANDSCAPES ALONG ITS CORRIDOR AND ASSOCIATED CONTRIBUTING AND NONCONTRIBUTING FEATURES, INCLUDING THE GOALS OF CONNECTING PEOPLE TO PARKS AND PRESERVING AMERICA'S SPECIAL SPACES.

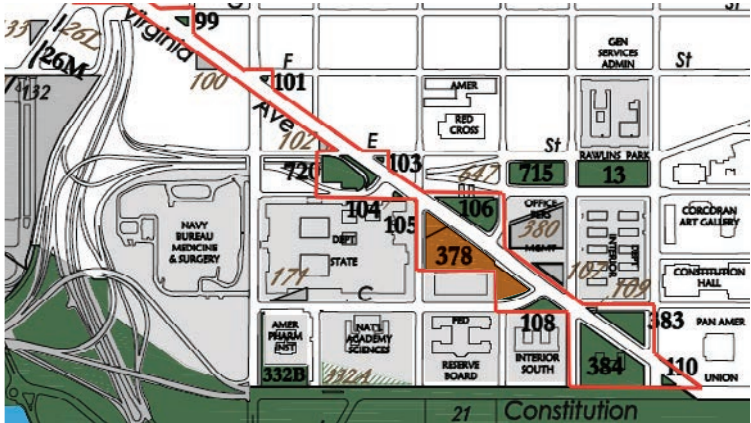

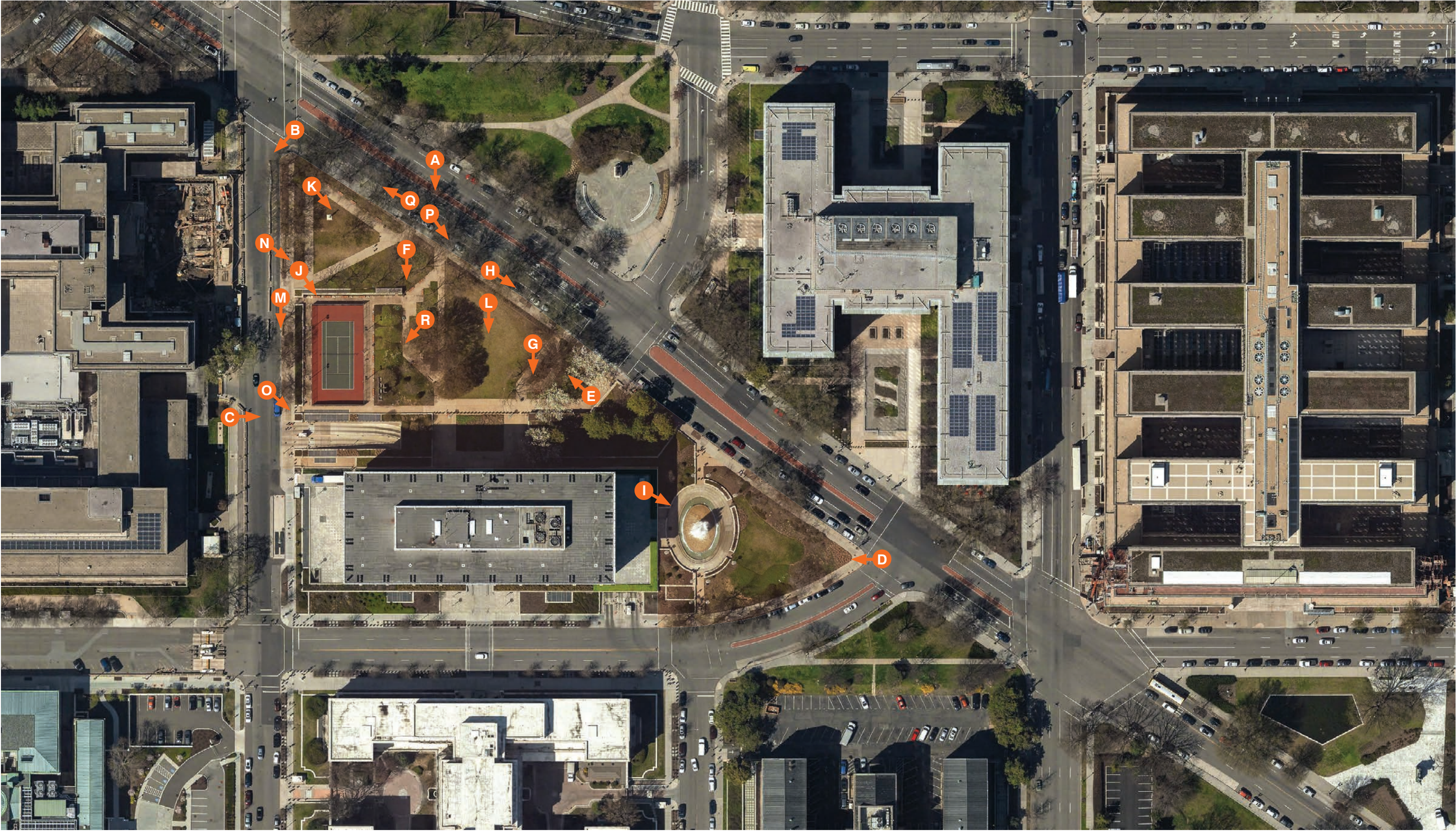



VIEW FROM VA AVENUE SOUTH TO MARTIN BUILDING [A]



INTERSECTION OF 21ST STREET & VA AVENUE [B]



21ST STREET AT NORTH GARAGE ENTRANCE RAMP [C]



VIEW FROM INTERSECTION OF C STREET & VA AVENUE [D]



SEATING AREA EAST OF THE LAWN, LOOKING NORTHWEST [E]



SEATING AREA WEST OF THE LAWN, LOOKING SOUTH [F]



SEATING AREA EAST OF THE LAWN, LOOKING SOUTH [G]



VIRGINIA AVENUE SIDEWALK, LOOKING SOUTHEAST [H]



VIEW OF THE FOUNTAIN, LOOKING SOUTHEAST [I]



VIEW OF THE TENNIS COURT, LOOKING SOUTH [J]



EDWARD J. KELLY PARK, LOOKING SOUTHEAST [K]



VIEW OF THE LAWN AND SCULPTURES, LOOKING SOUTH [L]



21ST STREET LOOKING SOUTH [M]



21ST STREET PLANTERS LOOKING SOUTHEAST [N]



EXISTING GRATES AT 21ST STREET LOOKING SOUTHEAST [O]



VA AVENUE LOOKING SOUTHEAST [P]



VA AVENUE LOOKING NORTHWEST [Q]



EXISTING GENERATOR EXHAUSTS [R]



SECTION 106 COMPLIANCE

SECTION 106/NEPA PROCESS

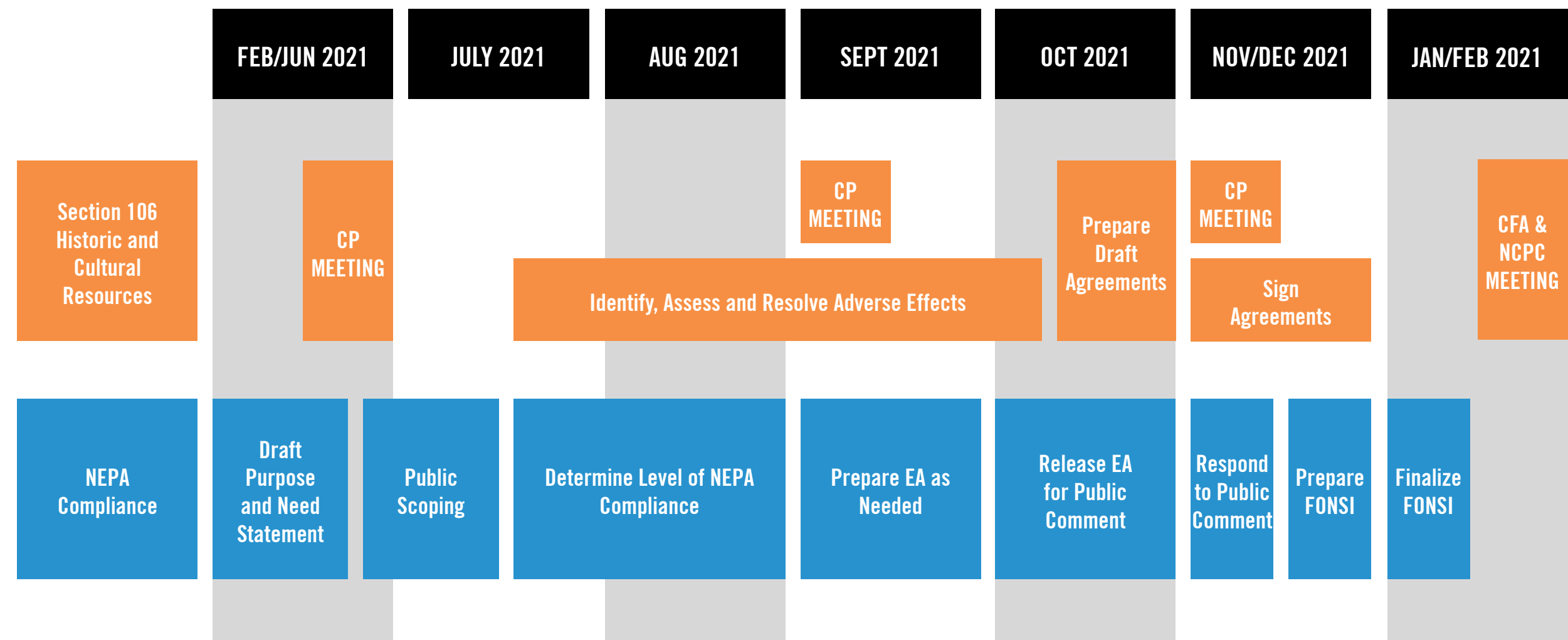

SECTION 106 OVERVIEW

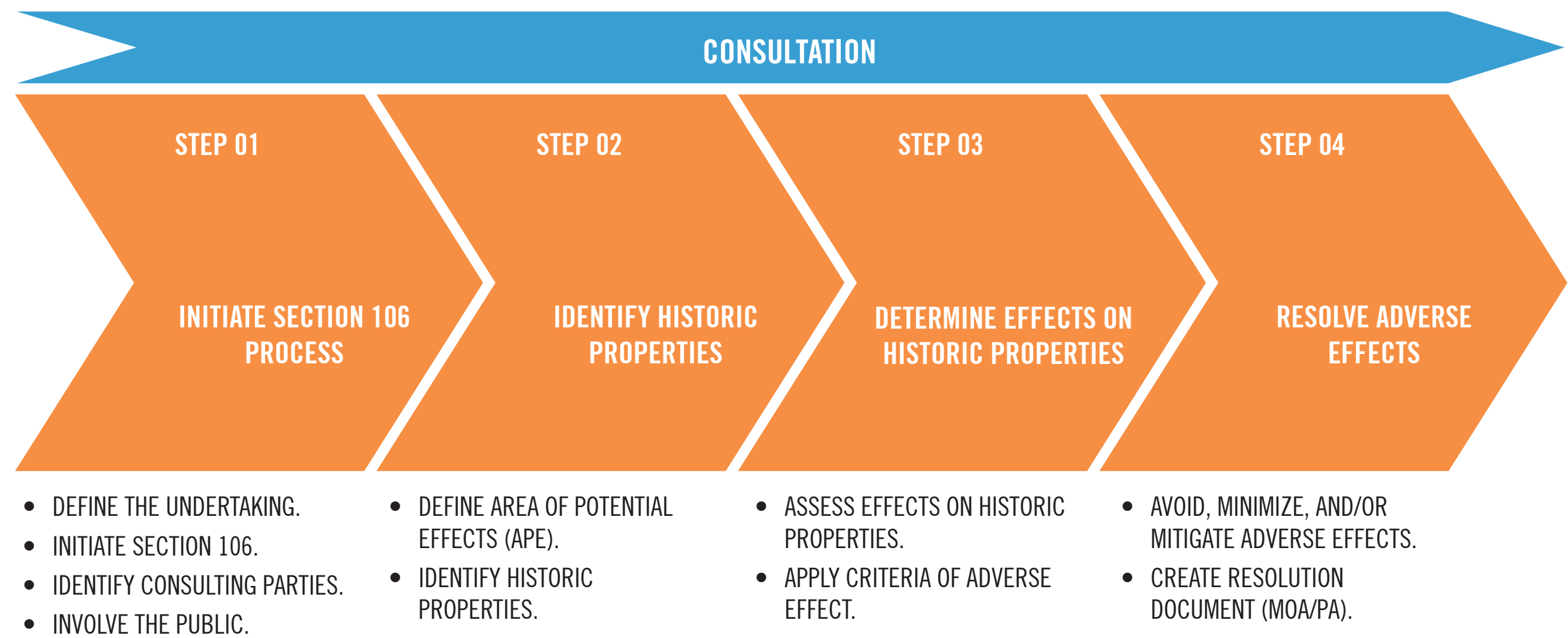

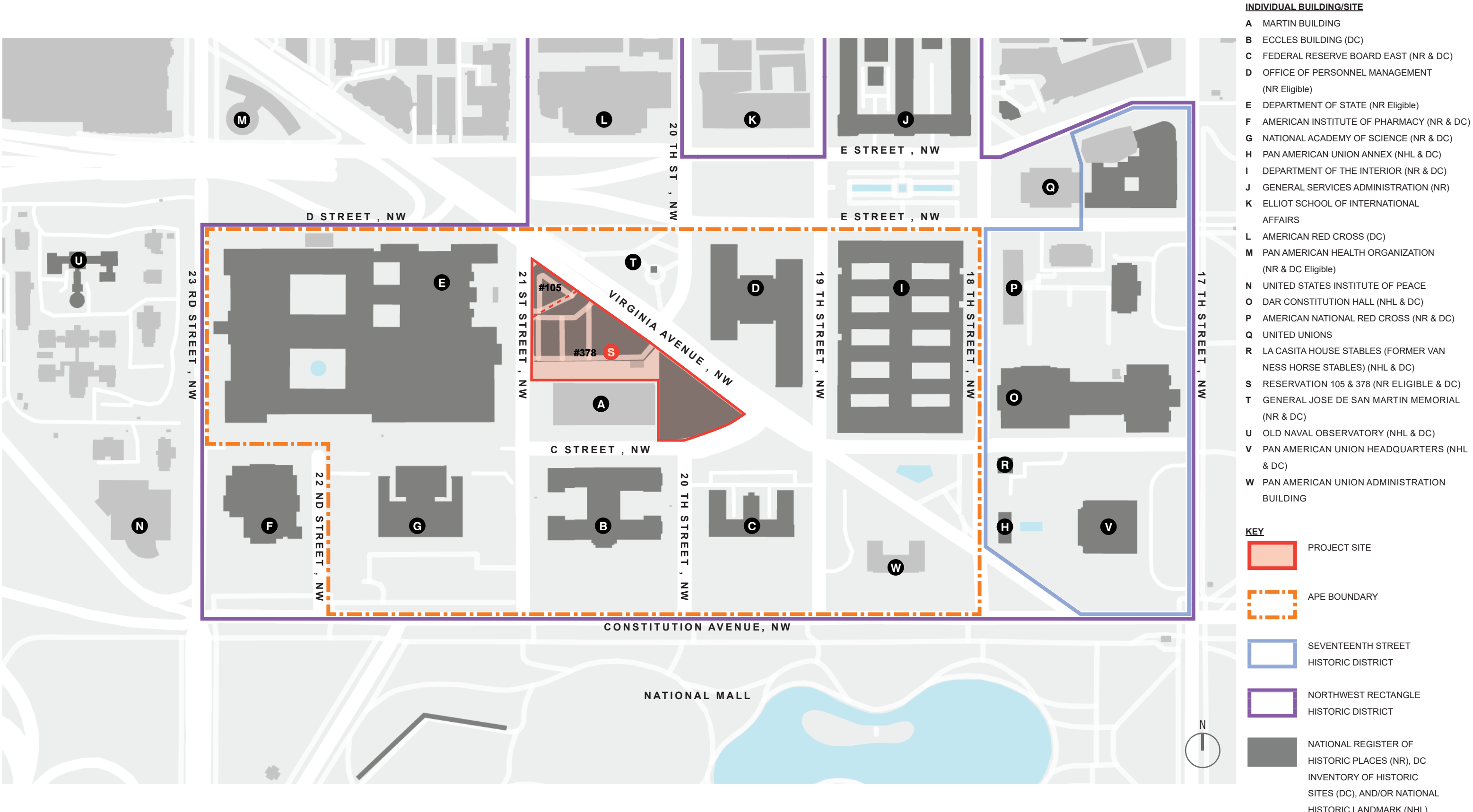

DOE SUMMARY

CRITERION C (DESIGN/CONSTRUCTION): DESIGNED LANDSCAPE AND WORK OF A MASTER (OEHME, VAN SWEDEN)

RESERVATIONS 105 AND 378 ARE SIGNIFICANT AT THE NATIONAL LEVEL UNDER CRITERION C AS THE WORK OF A MASTER, NAMELY, AS THE FIRST PUBLIC EXAMPLE OF THE NEW AMERICAN GARDEN STYLE OF LANDSCAPE DESIGN PIONEERED BY LANDSCAPE ARCHITECTS WOLFGANG OEHME AND JAMES VAN SWEDEN.

CRITERIA CONSIDERATION G (PROPERTIES THAT HAVE ACHIEVED SIGNIFICANCE WITHIN THE LAST FIFTY YEARS)

RESERVATIONS 105 AND 378 MEET CRITERIA CONSIDERATION G FOR PROPERTIES LESS THAN FIFTY YEARS OLD AS AN EXCEPTIONAL AND HIGHLY INTACT EXAMPLE OF OEHME, VAN SWEDEN'S FIRST PUBLIC EXPRESSION OF THE NEW AMERICAN GARDEN STYLE OF LANDSCAPE DESIGN. LANDSCAPE ARCHITECTS AND HISTORIANS HAVE IDENTIFIED THE FEDERAL RESERVE GARDEN AS A HIGHLY SIGNIFICANT TRANSITIONAL DESIGN IN THE FIRM'S BODY OF WORK AND INFLUENTIAL IN THE EVOLUTION OF LANDSCAPE DESIGN IN THE UNITED STATES.

CONTRIBUTING FEATURES

TOPOGRAPHY AND SPATIAL ORGANIZATION

- TRIANGULAR PUBLIC GREEN SPACE CREATED BY THE IMPOSITION OF AN ORTHOGONAL GRID OVER RADIAL AVENUES.
- ASYMMETRICAL LAYOUT OF MAJOR GEOMETRIC ELEMENTS: RECTANGULAR TENNIS COURT, LARGE OVAL FOUNTAIN, TRIANGULAR PARK, POLYGONAL CENTRAL LAWN.
- SHARP ANGLES TO MEET ORIENTATION OF VIRGINIA AVENUE.
- ASYMMETRICAL SPACES ALONG VIRGINIA AVENUE DEFINED BY EARTHEN BERMS TO CREATE SHADED SEATING NICHES CONTRASTING WITH OPEN LAW.
- RAISED BEDS FRAMING WALKWAYS AND SURROUNDING THE TENNIS COURT, FOUNTAIN, AND NORTH GARAGE ENTRANCE.

CIRCULATION

- PERIMETER SIDEWALKS ALONG VIRGINIA AVENUE AND 21ST STREET NW.
- PATTERN OF ORTHOGONAL WALKS.

VIEWS

- VISTA ALONG VIRGINIA AVENUE FRAMING THE WASHINGTON MONUMENT.
- VIEWS OF THE MARTIN BUILDING FROM THE FOUNTAIN AND CENTRAL LAWN.
- INTERIOR VIEWS BETWEEN PARK AREAS AND FEATURES FRAMED BY MASS PLANTINGS.

VEGETATION

- MASS PLANTINGS OF NATIVE GRASSES AND PERENNIALS ON EARTHEN BERMS AND WITHIN RAISED GRANITE PLANTING BEDS.
- SHADE AND ORNAMENTAL TREES SET WITHIN GROUND COVER.

CONSTRUCTED WATER FEATURES

- ROBERT LATHAM OWEN MEMORIAL FOUNTAIN.

SMALL-SCALE FEATURES

- TENNIS COURT.
- LAMP POSTS.
- DISCUS THROWER (DISCOBOLUS) STATUE.



LANDSCAPE HISTORY / DESIGN PALIMPSEST

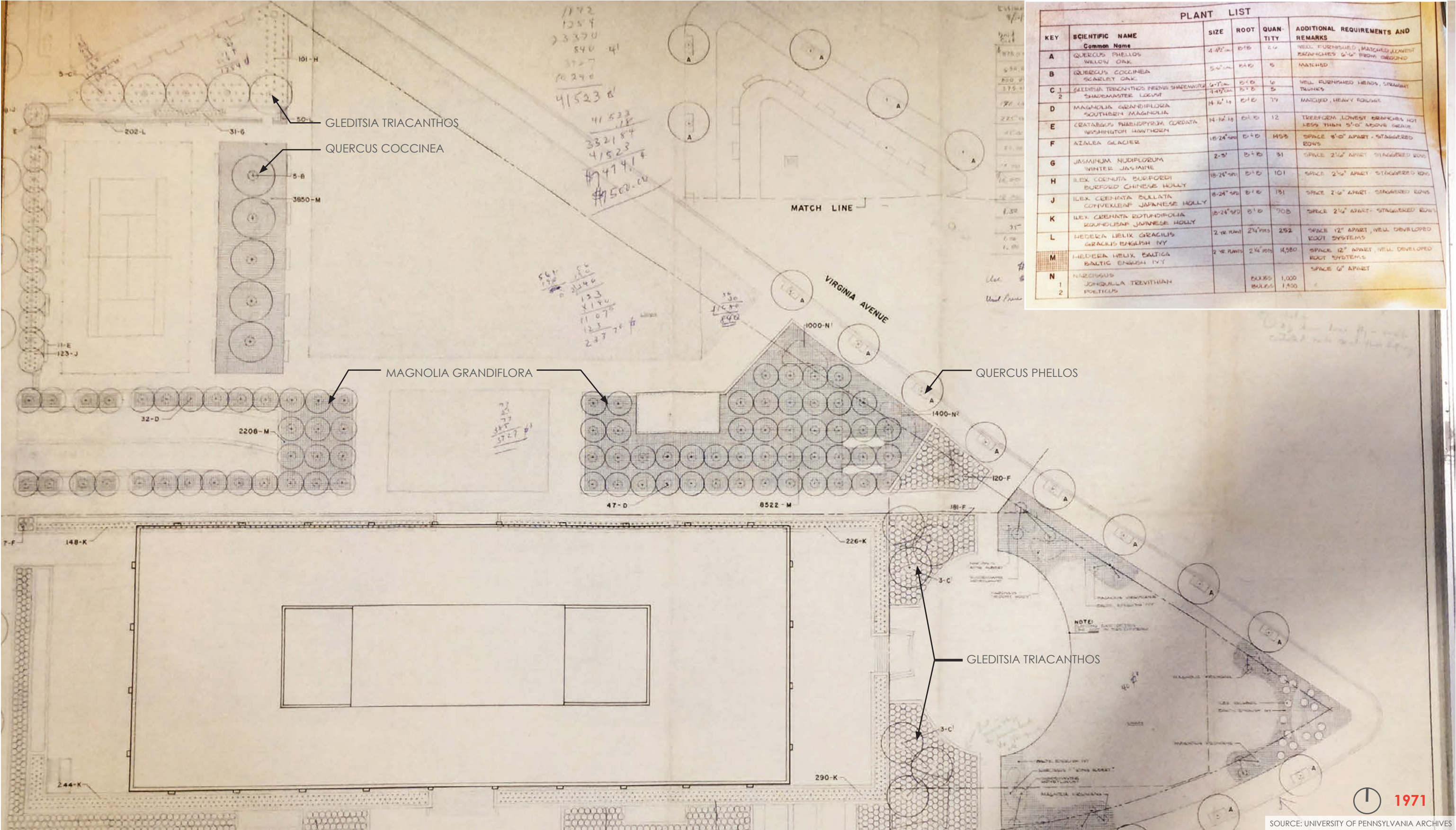

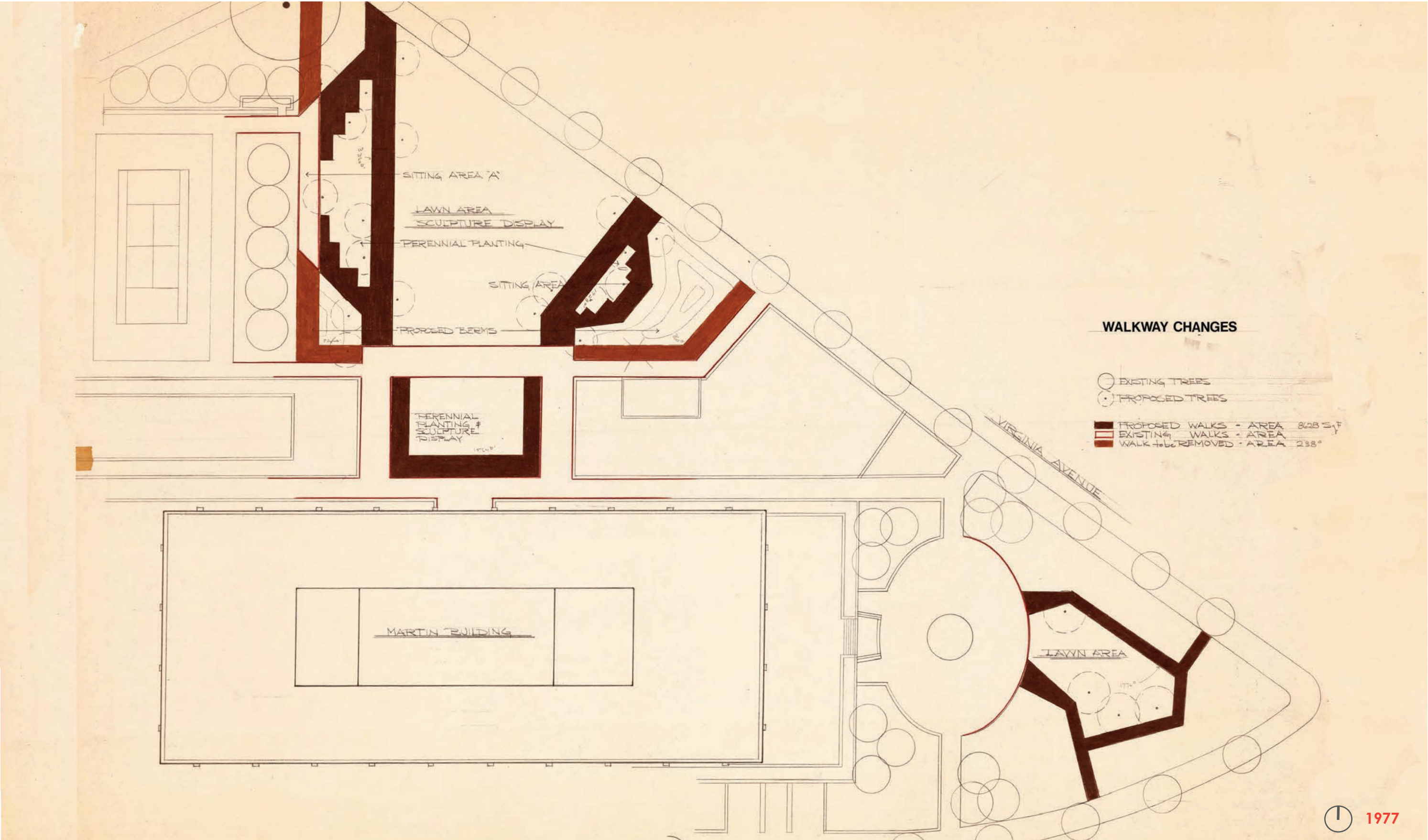

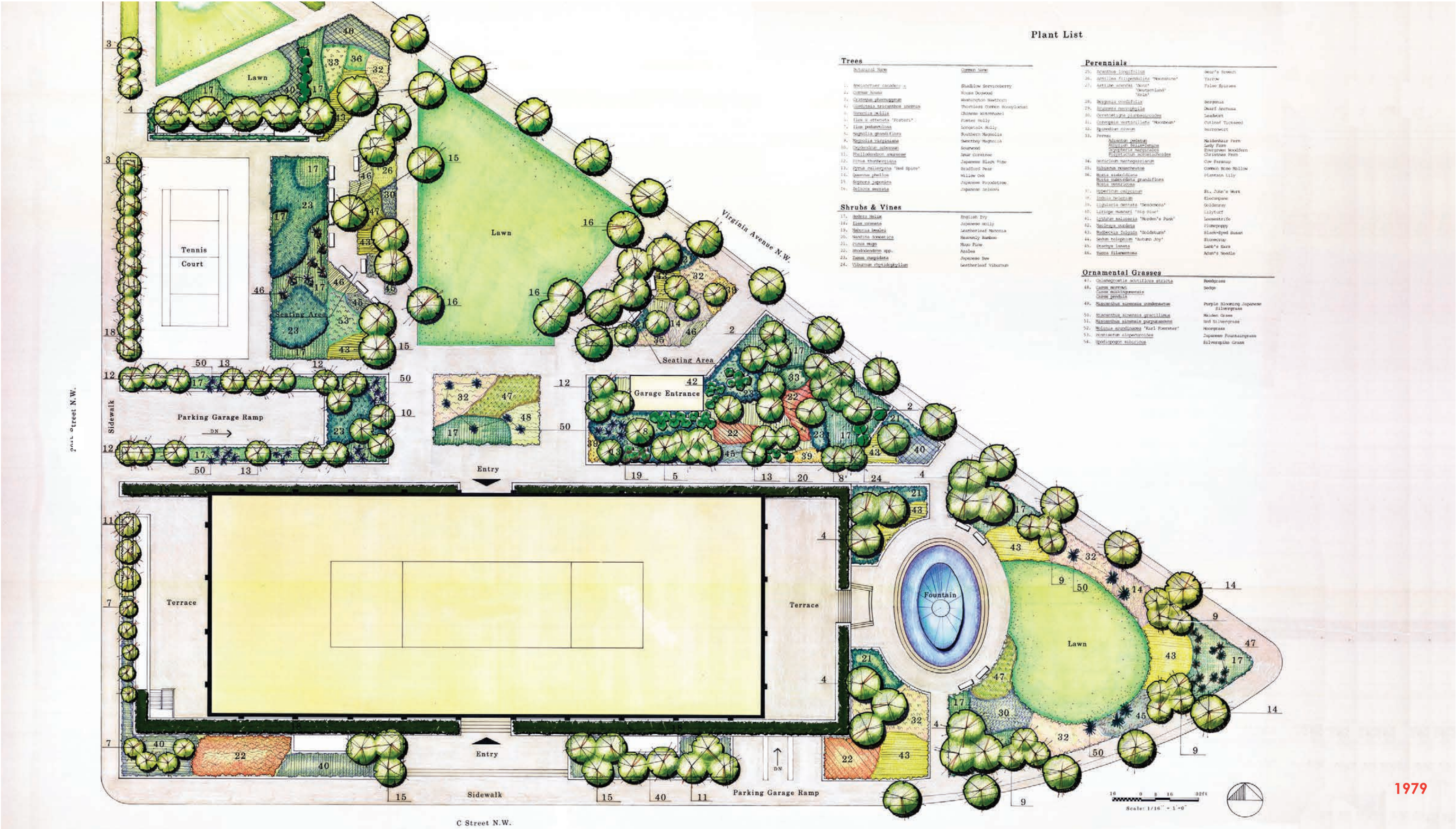

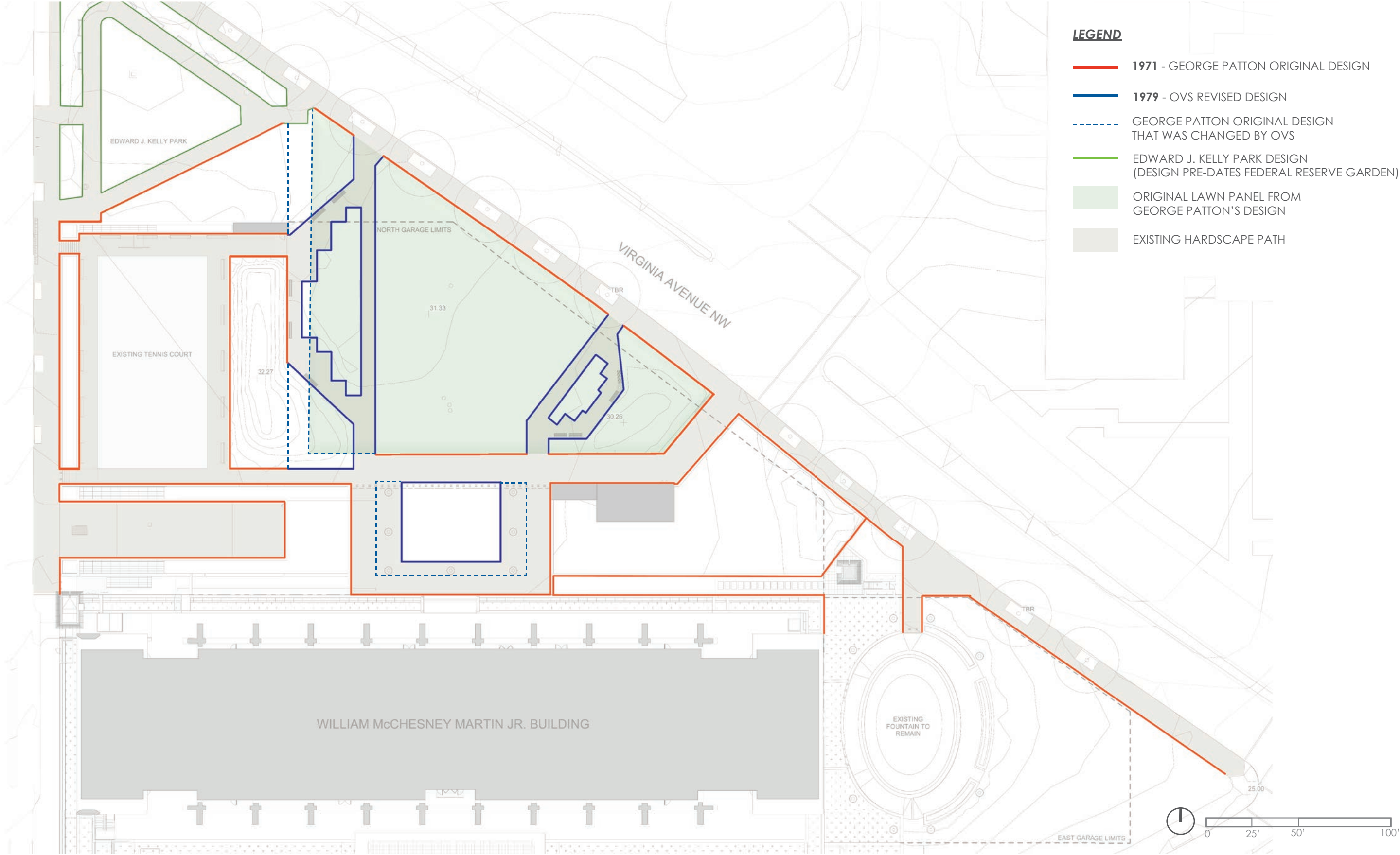

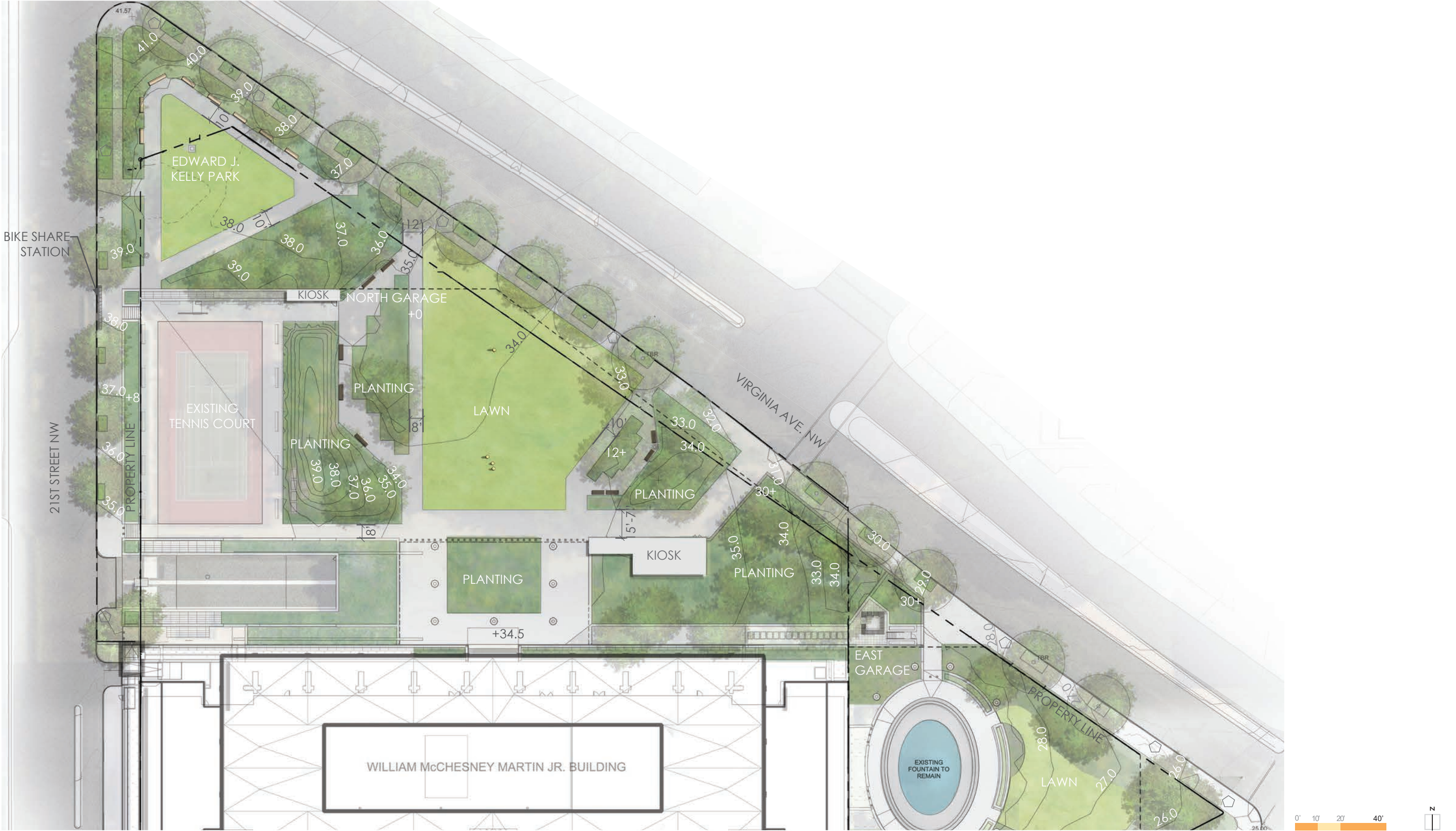

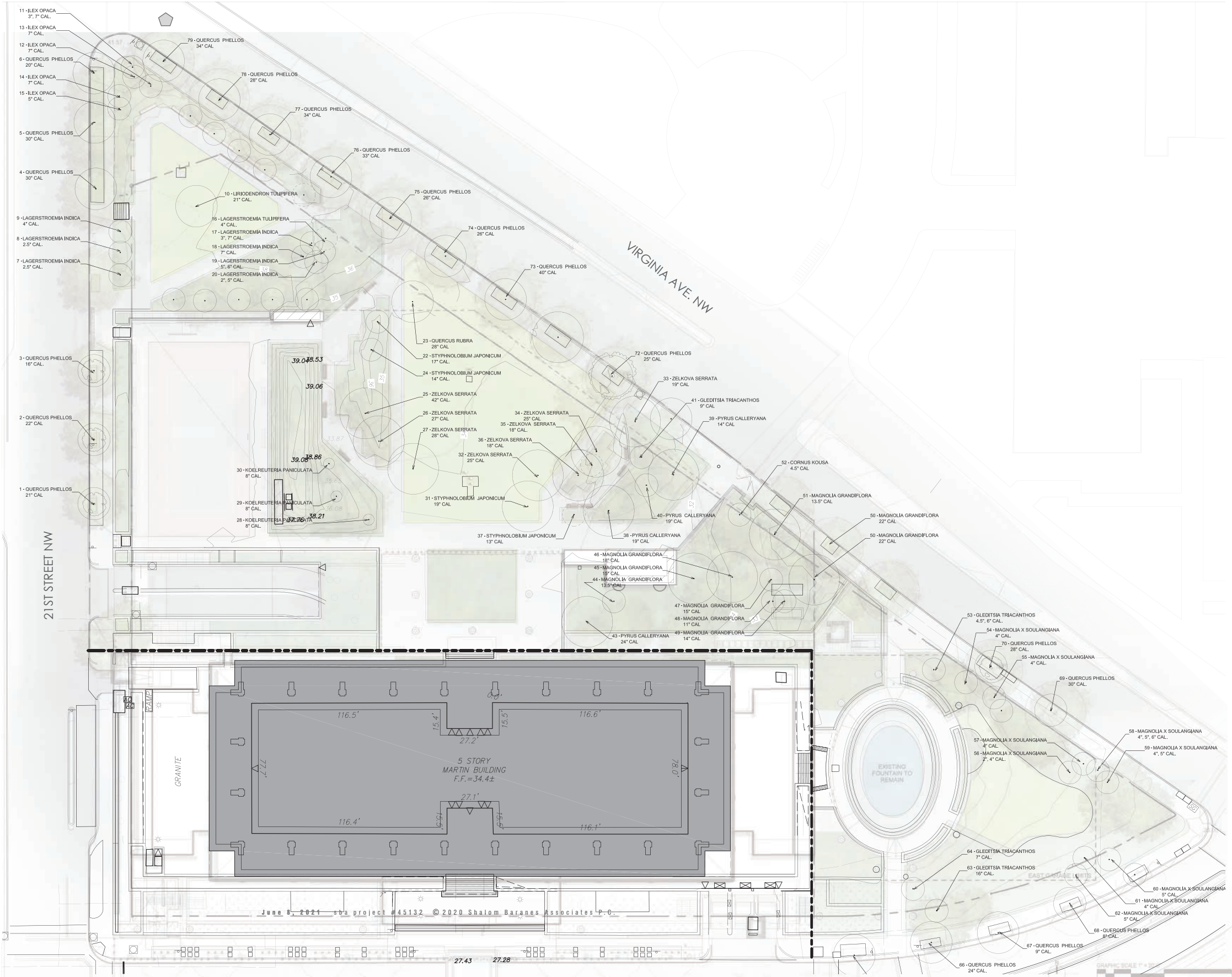

PHASE 2 - EXISTING TREE SCHEDULE				
Tree #	Scientific Name	Common Name	Diameter	Comments
1	QUERCUS PHELLOS	WILLOW OAK	21" CAL	FAIR
2	QUERCUS PHELLOS	WILLOW OAK	22" CAL	FAIR/POOR
3	QUERCUS PHELLOS	WILLOW OAK	16" CAL	FAIR
4	QUERCUS PHELLOS	WILLOW OAK	30" CAL	GOOD
5	QUERCUS PHELLOS	WILLOW OAK	30" CAL	GOOD
6	QUERCUS PHELLOS	WILLOW OAK	20" CAL	FAIR
7	LAGERSTROEMIA INDICA	CRAPE MYRTLE	2.5" CAL	GOOD
8	LAGERSTROEMIA INDICA	CRAPE MYRTLE	2.5" CAL	FAIR
9	LAGERSTROEMIA INDICA	CRAPE MYRTLE	4" CAL	FAIR
10	LIRIODENDRON TULIIFERA	TULIP POPLAR	21" CAL	FAIR
11	ILEX OPACA	AMERICAN HOLLY	3", 7" CAL	FAIR
12	ILEX OPACA	AMERICAN HOLLY	7" CAL	FAIR
13	ILEX OPACA	AMERICAN HOLLY	7" CAL	FAIR
14	ILEX OPACA	AMERICAN HOLLY	7" CAL	FAIR
15	ILEX OPACA	AMERICAN HOLLY	5" CAL	FAIR
17	LAGERSTROEMIA INDICA	CRAPE MYRTLE	3", 7" CAL	GOOD
18	LAGERSTROEMIA INDICA	CRAPE MYRTLE	7" CAL	GOOD
19	LAGERSTROEMIA INDICA	CRAPE MYRTLE	5", 6" CAL	GOOD
20	LAGERSTROEMIA INDICA	CRAPE MYRTLE	2", 5" CAL	GOOD
22	STYPHNOLOBIMUM JAPONICUM	PAGODA TREE	17" CAL	FAIR
23	QUERCUS RUBRA	NORTHERN RED OAK	28" CAL	POOR
24	STYPHNOLOBIMUM JAPONICUM	PAGODA TREE	14" CAL	POOR
25	ZELKOVA SERRATA	ZELKOVA	42" CAL	GOOD
26	ZELKOVA SERRATA	ZELKOVA	27" CAL	GOOD
27	ZELKOVA SERRATA	ZELKOVA	28" CAL	GOOD
28	KOELREUTERIA PANICULATA	GOLDEN RAINTREE	8" CAL	GOOD
29	KOELREUTERIA PANICULATA	GOLDEN RAINTREE	8" CAL	GOOD
30	KOELREUTERIA PANICULATA	GOLDEN RAINTREE	8" CAL	GOOD
31	STYPHNOLOBIMUM JAPONICUM	PAGODA TREE	19" CAL	FAIR/POOR
32	ZELKOVA SERRATA	ZELKOVA	25" CAL	GOOD
33	ZELKOVA SERRATA	ZELKOVA	19" CAL	FAIR
34	ZELKOVA SERRATA	ZELKOVA	25" CAL	GOOD/FAIR
36	ZELKOVA SERRATA	ZELKOVA	18" CAL	GOOD/FAIR
38	PYRUS CALLERYANA	CALLERY PEAR	19" CAL	FAIR
39	PYRUS CALLERYANA	CALLERY PEAR	14" CAL	FAIR/POOR
40	PYRUS CALLERYANA	CALLERY PEAR	19" CAL	FAIR/POOR
41	GLEDITSIA TRIACANTHOS	HONEYLOCUST	9" CAL	GOOD
43	PYRUS CALLERYANA	CALLERY PEAR	24" CAL	POOR
44	MAGNOLIA GRANDIFLORA	SOUTHERN MAGNOLIA	13.5" CAL	POOR
45	MAGNOLIA GRANDIFLORA	SOUTHERN MAGNOLIA	15" CAL	GOOD/FAIR
46	MAGNOLIA GRANDIFLORA	SOUTHERN MAGNOLIA	18" CAL	GOOD/FAIR
47	MAGNOLIA GRANDIFLORA	SOUTHERN MAGNOLIA	15" CAL	GOOD/FAIR
48	MAGNOLIA GRANDIFLORA	SOUTHERN MAGNOLIA	11" CAL	FAIR
49	MAGNOLIA GRANDIFLORA	SOUTHERN MAGNOLIA	14" CAL	GOOD/FAIR
50	MAGNOLIA GRANDIFLORA	SOUTHERN MAGNOLIA	22" CAL	GOOD
51	MAGNOLIA GRANDIFLORA	SOUTHERN MAGNOLIA	13.5" CAL	FAIR
52	CORNUS KOUSA	KOUSA DOGWOOD	4.5" CAL	GOOD
53	GLEDITSIA TRIACANTHOS	HONEYLOCUST	4.5", 6" CAL	GOOD
54	MAGNOLIA X SOULANGIANA	SAUCER MAGNOLIA	4" CAL	GOOD
55	MAGNOLIA X SOULANGIANA	SAUCER MAGNOLIA	4" CAL	FAIR/POOR
56	MAGNOLIA X SOULANGIANA	SAUCER MAGNOLIA	2", 4" CAL	GOOD/FAIR
57	MAGNOLIA X SOULANGIANA	SAUCER MAGNOLIA	4" CAL	GOOD/FAIR
58	MAGNOLIA X SOULANGIANA	SAUCER MAGNOLIA	4", 5", 6" CAL	FAIR/POOR
59	MAGNOLIA X SOULANGIANA	SAUCER MAGNOLIA	4", 5" CAL	GOOD
60	MAGNOLIA X SOULANGIANA	SAUCER MAGNOLIA	5" CAL	GOOD
61	MAGNOLIA X SOULANGIANA	SAUCER MAGNOLIA	4" CAL	GOOD
62	MAGNOLIA X SOULANGIANA	SAUCER MAGNOLIA	5" CAL	GOOD
63	GLEDITSIA TRIACANTHOS	HONEYLOCUST	16" CAL	POOR
64	GLEDITSIA TRIACANTHOS	HONEYLOCUST	7" CAL	GOOD
65	QUERCUS PHELLOS	WILLOW OAK	23" CAL	GOOD
66	QUERCUS PHELLOS	WILLOW OAK	24" CAL	GOOD
67	QUERCUS PHELLOS	WILLOW OAK	9" CAL	GOOD
68	QUERCUS PHELLOS	WILLOW OAK	8" CAL	GOOD
69	QUERCUS PHELLOS	WILLOW OAK	30" CAL	GOOD
70	QUERCUS PHELLOS	WILLOW OAK	28" CAL	GOOD
71	QUERCUS PHELLOS	WILLOW OAK	8" CAL	GOOD
72	QUERCUS PHELLOS	WILLOW OAK	25" CAL	GOOD
73	QUERCUS PHELLOS	WILLOW OAK	40" CAL	FAIR
74	QUERCUS PHELLOS	WILLOW OAK	26" CAL	GOOD/FAIR
75	QUERCUS PHELLOS	WILLOW OAK	26" CAL	GOOD/FAIR
76	QUERCUS PHELLOS	WILLOW OAK	33" CAL	GOOD
77	QUERCUS PHELLOS	WILLOW OAK	34" CAL	GOOD
78	QUERCUS PHELLOS	WILLOW OAK	28" CAL	GOOD
79	QUERCUS PHELLOS	WILLOW OAK	34" CAL	GOOD

NOTE
TREE SURVEY COMPLETED BY PITCHFORD & ASSOCIATES ON 10/13/2020
79 TREES TOTAL (61 AT NOTRH GRAGAGE, 18 AT SOUTH GARAGE)





● AMELANCHIER CANADENSIS / SERVICEBERRY



● BETULA NIGRA 'HERITAGE' / HERITAGE RIVER BIRCH



● CERCE CANADENSIS / FLOWER EASTERN REDBUD



● CERCE CANADENSIS 'ALBA' / WHITE FLOWER EASTERN REDBUD



● CHIONANTHUS VIRGINICUS / FRINGE TREE



● CORNUS KOUSA / KOUSA DOGWOOD



● CRATAEGUS PHAENOPYRUM / WASHINGTON HAWTHORN



● GLEDITSIA TRIACANTHOS VAR. INERMIS / SHADEMASTER LOCUST



● HAMAMELS x INTERMEDIA 'PALLIDA'



● ILEX 'NELLE STEVENS' / NELLE STEVENS HOLLY



● JUNIPERUS VIRGINIANA 'IDYLLWILD' / IDYLLWILD EASTERN RED CEDAR



● MAGNOLIA GRANDIFLORA 'ALTA' / SOUTHERN MAGNOLIA



● MAGNOLIA STELLATA 'ROYAL STAR' / ROYAL STAR MAGNOLIA



● MAGNOLIA VIRGINIANA / SWEETBAY MAGNOLIA



● OXYDENDRUM ARBOREUM / SOURWOOD



● PARROTIA PERSICA 'VANESSA' / PERSIAN IRONWOOD



● QUERCUS LYRATA 'HIGHBEAM' / OVERCUP OAK 'HIGHBEAM'



● QUERCUS PHELLOS / WILLOW OAK



● AZALEA 'GLACIER' / GLACIER AZALEA



● CLETHRA ALNIFOLIA / SUMMERSWEET



● CORNUS SANGUINEA 'MIDWINTER FIRE' / BLOODTWIG DOGWOOD



● COTINUS COGGYRIA 'YOUNG LADY' / YOUNG LADY SMOKE BUSH



● DAPHNE ODOREA 'AUROMARGINATA' / WINTER DAPHNE



● EDGEWORTHIA CHRYSANTHA / PAPERBUSH PLANT



● EXOCHORDA x MACRANTHA 'THE BRIDE' / PEARL BUSH



● FOTHERGILLA MAJOR 'MOUNT AIRY' / MOUNT AIRY FOTHERGILLA



● ILEX CRENTATA / JAPANESE HOLLY



● ILEX VERTICILLATA 'JIM DANDY' / WINTERBERRY



● RHUS AROMATICA 'LOW-GROW' / GROW-LOW AROMATIC SUMAC



● ROSA 'THE PINK KNOCKOUT' / THE PINK KNOCKOUT ROSE



● SPIRAEA JAPONICA 'ANTHONY WATERER' / ANTHONY WATERER SPIREA



● STEPHANANDRA INCISA 'CRISPA' / STEPHANANDRA



● TAXUS CUSPIDATA / JAPANESE YEW



● VIBURNUM x BURKWOODII 'CONOY' / BURKWOOD CONOY VIBURNUM

- SPECIES FROM GEORGE PATTON DESIGN OF 1975
- SPECIES FROM OVS 1979
- SPECIES FROM OVS 2015
- SPECIES FROM OVS 2020 (OPTIONS)



- SPECIES FROM GEORGE PATTON DESIGN OF 1975
- SPECIES FROM OVS 1979
- SPECIES FROM OVS 2015
- SPECIES FROM OVS 2020 (OPTIONS)

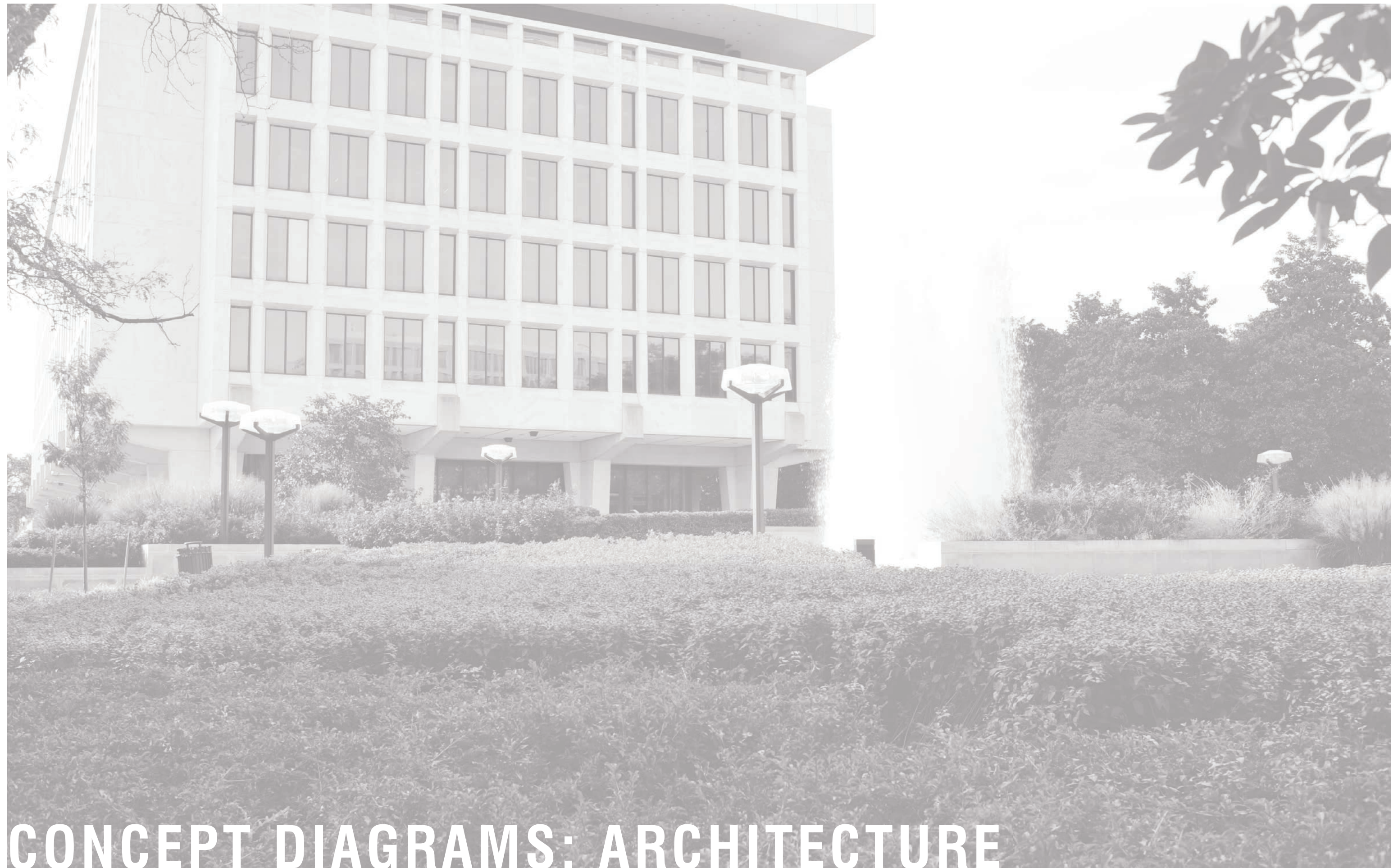

CONCEPT DIAGRAMS: ARCHITECTURE

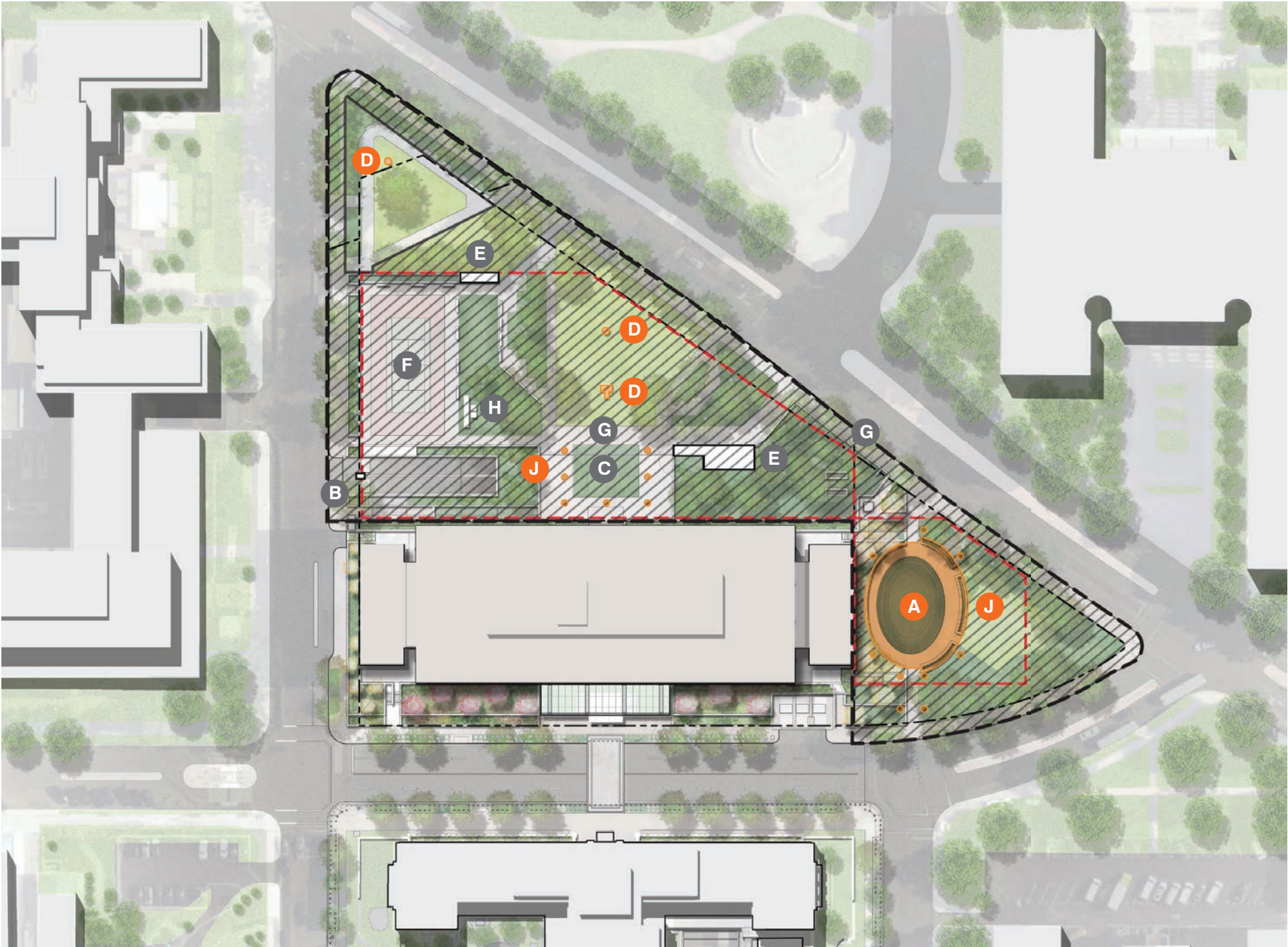

EXISTING SITE

- A FOUNTAIN (SALVAGED)
- B GUARD BOOTH
- C SOUTH PLAZA
- D SCULPTURES (SALVAGED)
- E VIRGINIA AVENUE ENTRY KIOSK / STAIR
- F TENNIS COURT
- G BOLLARDS / WALL
- H GENERATOR EXHAUST
- J LIGHT FIXTURES (SALVAGED)

LEGEND

- PROPERTY LINE
- - - GARAGE BELOW
- EXISTING ELEMENT TO BE SALVAGED, REPAIRED, AND REINSTALLED
- EXISTING ELEMENT TO BE REMOVED

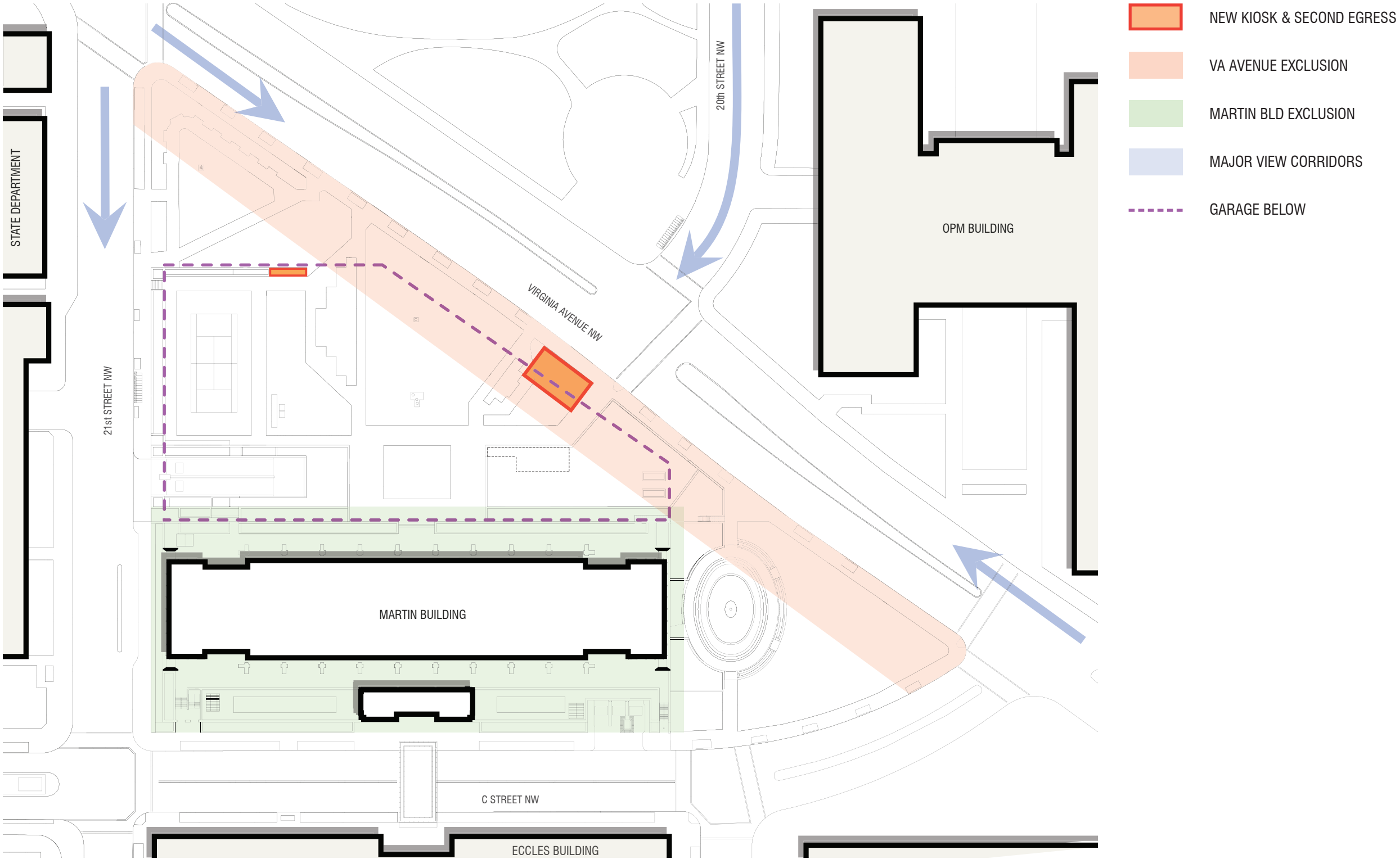

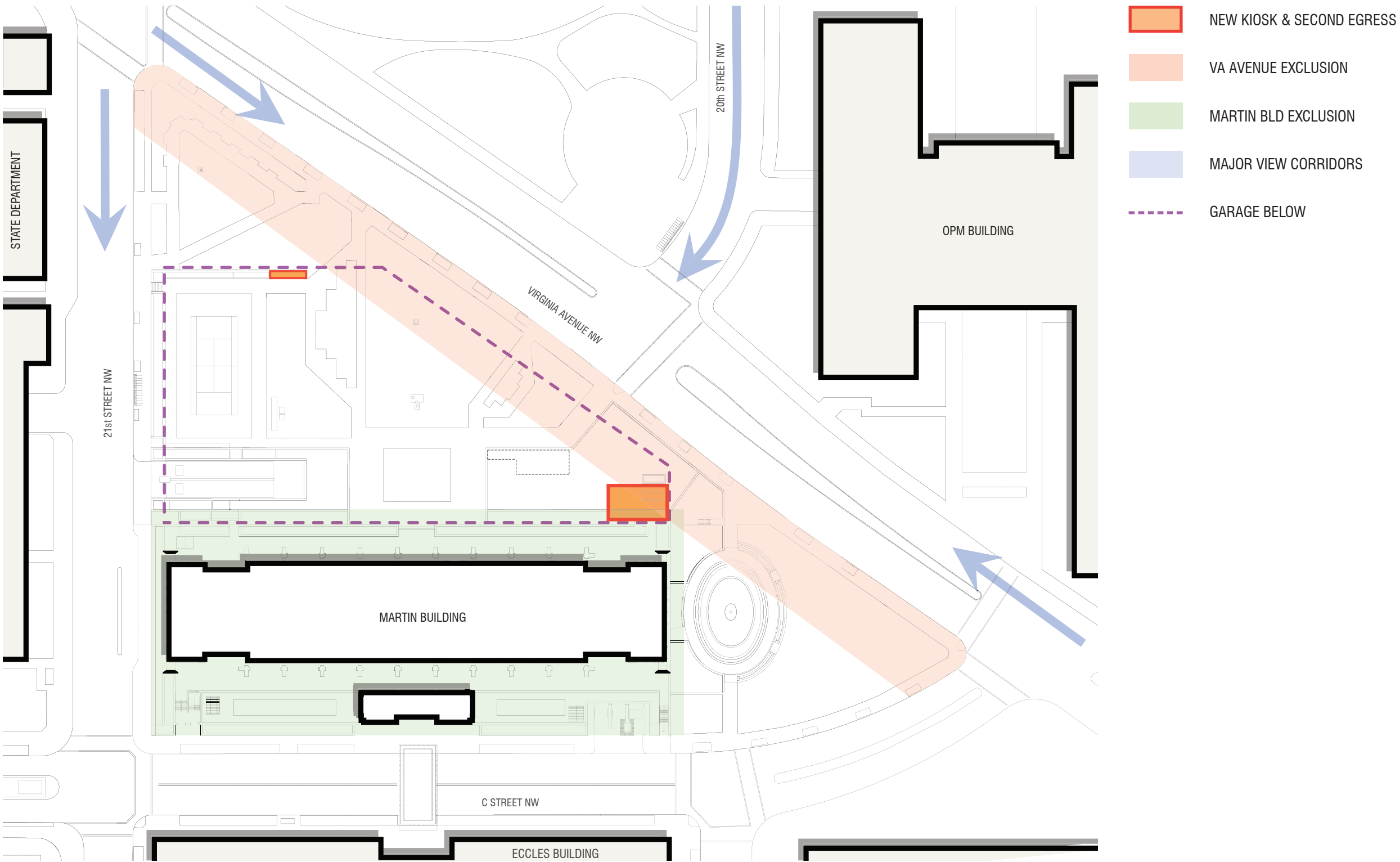

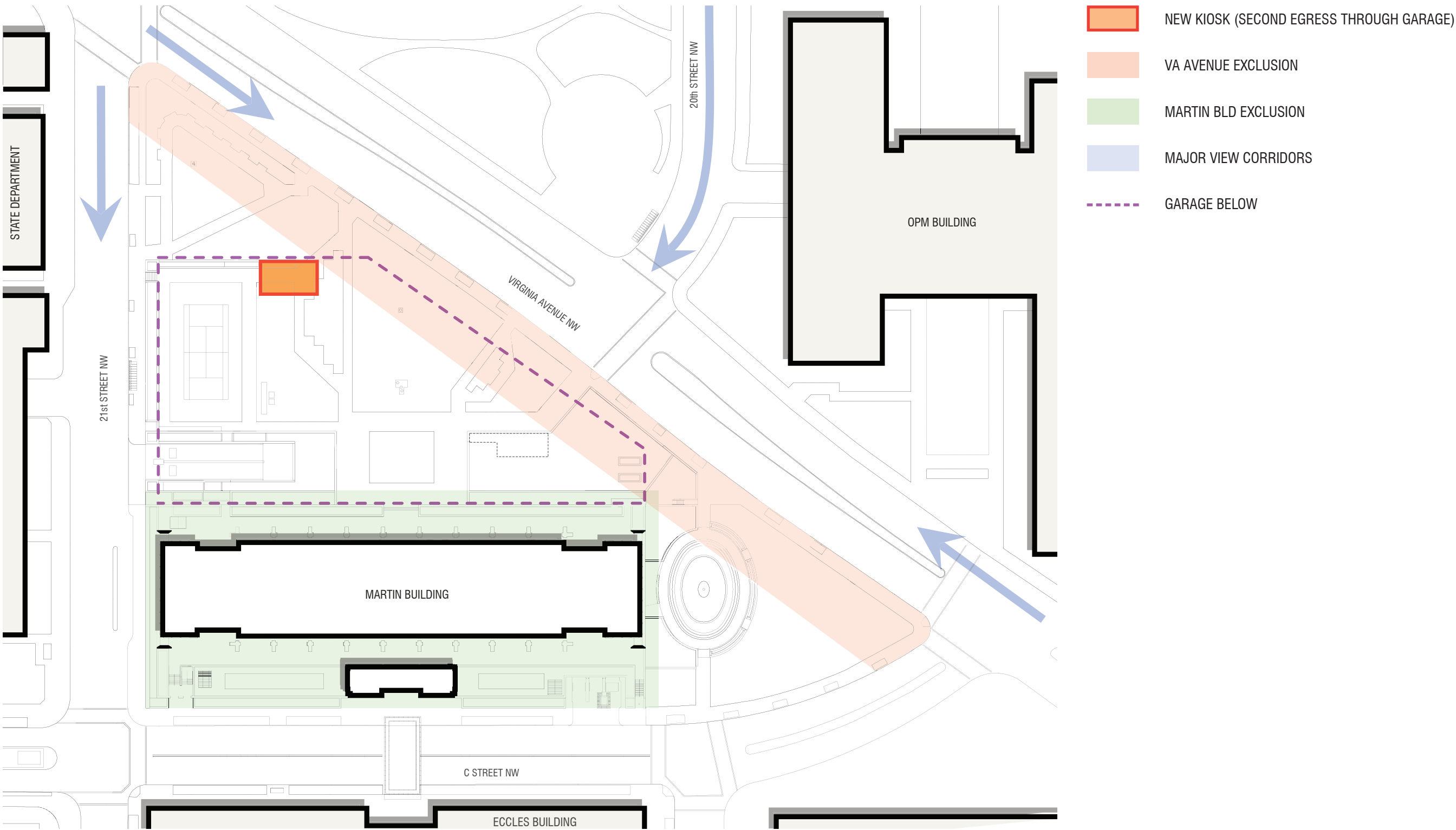

NEXT STEPS

- NEXT CONSULTING PARTIES MEETING: **FALL 2021**
- THE PUBLIC COMMENT PERIOD CLOSES **JULY 14, 2021**. COMMENTS MAY BE POSTED ONLINE OR MAILED. COMMENTS BY MAIL MUST BE POSTMARKED BY THIS DATE TO ENABLE FULL CONSIDERATION IN THE PLANNING PROCESS.
- THE WEB PAGE FOR ONLINE POSTING IS:
[HTTPS://PARKPLANNING.NPS.GOV/MARTINBUILDINGGARAGEANDLANDSCAPECOMMENT](https://parkplanning.nps.gov/martinbuildinggarageandlandscapecomment)
- THE ADDRESS FOR MAILING IS:
JEFFREY P. REINBOLD
SUPERINTENDENT
ATTN: FEDERAL RESERVE BOARD (MARTIN) BUILDING NORTH AND EAST GARAGE WATERPROOFING PROJECT
NATIONAL MALL AND MEMORIAL PARKS
900 OHIO DR. SW
WASHINGTON, DC 20024
- NOTE: BEFORE INCLUDING YOUR ADDRESS, PHONE NUMBER, E-MAIL ADDRESS, OR OTHER PERSONAL IDENTIFYING INFORMATION IN YOUR COMMENT, YOU SHOULD BE AWARE THAT YOUR ENTIRE COMMENT—INCLUDING YOUR PERSONAL IDENTIFYING INFORMATION—MAY BE MADE PUBLICLY AVAILABLE AT ANY TIME.