

Memorial House Museum Background

The Memorial House Museum (MHM) was built in 1930 in the Colonial Revival style and is not a reconstruction of the house in which George Washington was born.

In 2023, the MHM underwent a project to rehabilitate all the windows and doors within the building. During this effort, curatorial staff conducted a full assessment of the furnishings in the building, all of which are in the park's museum collection. The assessment revealed that many items:

- Have been on exhibit for decades and are in poor condition
- Are in need of professional conservation and care

To preserve these furnishings, it is recommended that:

- Washington Family items be relocated to the curatorial facility in the park for conservation and care and could be used in future exhibits in the park.
- The rest of the furniture and furnishings be moved to an offsite facility for conservation and care.

Relocation of the furnishings will require the park to reimagine how the MHM is used. As far back as 1932, the park identified a need for the space to be furnished with traditional museum exhibits rather than furnished as a house. Over the years, that idea has been repeatedly recommended but has never come to fruition.

Questions

- How do you think the MHM should be used?
- What types of exhibits would you like to see?



Figure 1. View of Memorial House Museum visitor entrance.

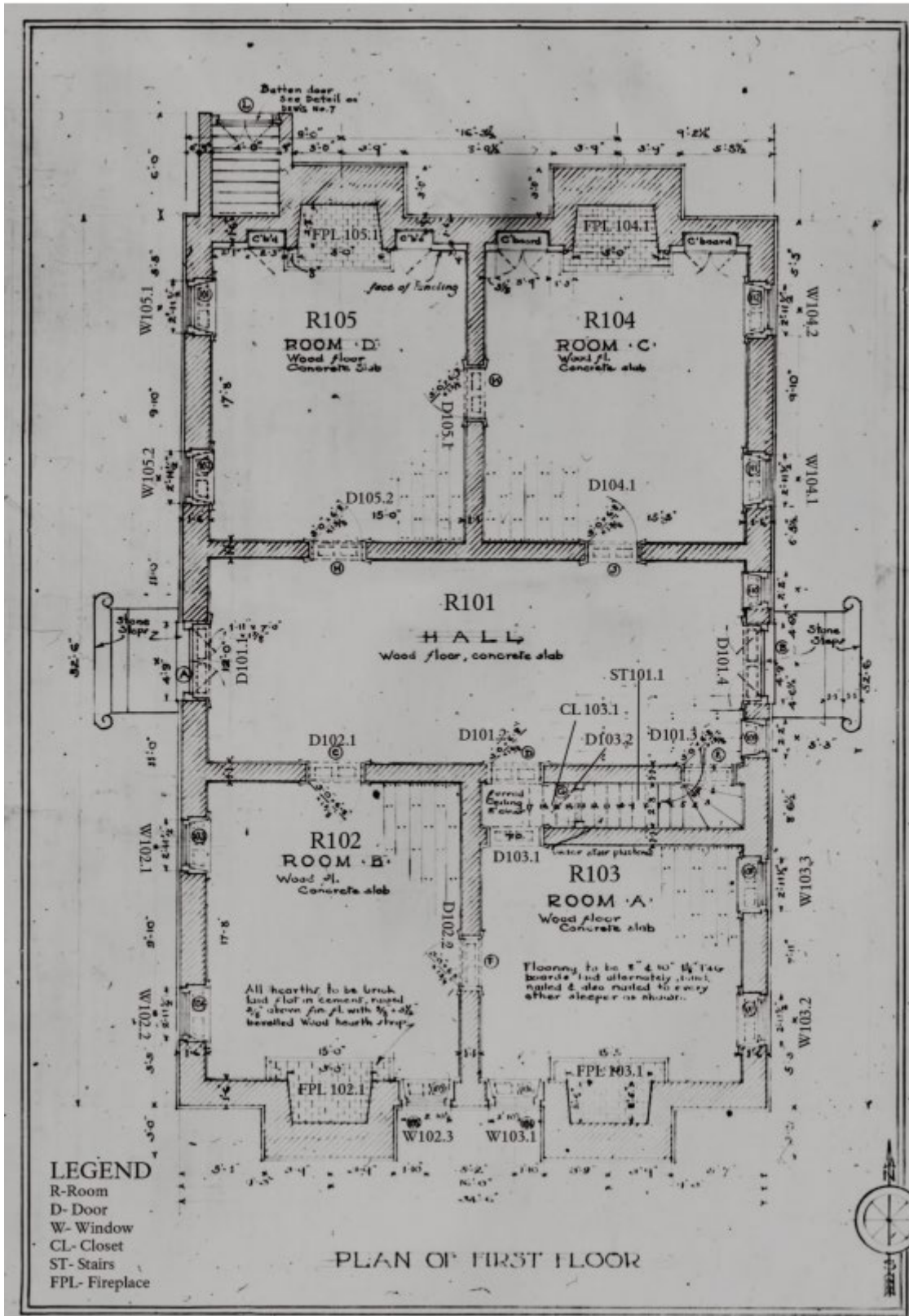

Figure 2. Floor plan of first floor of Memorial House Museum.



Figure 3. View of Dining room in its current configuration.



Figure 4. View of Guest Bedroom in its current configuration.



Evidence of Dry Rot



Figure 5. View of Dining room table drawer.



Figure 6. Jacobean Chair, Circa 1700 Showing Evidence of Deterioration.